

6395661-BK

2009-2014

Ford SVT Raptor



6395661-BK

2009-2014

Ford SVT Raptor

2009-2014 Ford SVT Raptor Torch Series 20" LED Bumper Light Bracket Kit

TOOLS REQUIRED:

7/32 Socket
7/16 Socket
3/8 Socket
Ratchet and Extension

PARTS LIST:

1-Left Ligh Bracket
1-Right Lig Bracket
2-1/4"x1-1/2 flat washer
2- 1/4" lock washer
2- 1/4" nuts

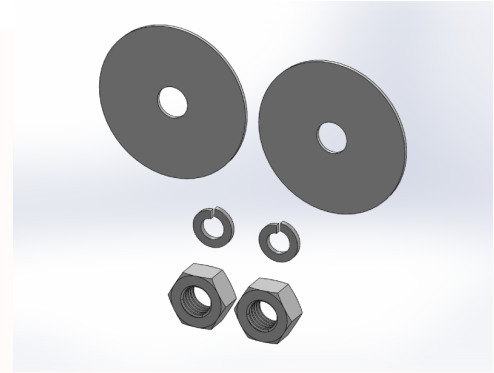

PLEASE READ AND UNDERSTAND ALL INSTRUCTIONS BEFORE INSTALLATION. Auto makers offer varied models to each vehicle and occasionally manufacture more than one body style of the same model. To assure your part is correct; our tech department can be contacted at tech@trexbillet.com to verify fitment or assist with tech questions. All other inquires can be directed to info@trexbillet.com. In the event you do not have internet access please call 1-800-287-5900.

Step 1

Begin by removing factory bumper grille assembly from vehicle. Remove the four 7/32 bolts securing the grille to the bumper. (Fig 1)



Step 2

Attach the 20" LED light bar (Not Included), to the brackets. Loosely secure bolts at this time so you can adjust your light after installation is complete. (Fig 2) Refer to exploded diagram in (Fig 2A) for orientation of light brackets.



6395661-BK

2009-2014

Ford SVT Raptor



6395661-BK

2009-2014

Ford SVT Raptor

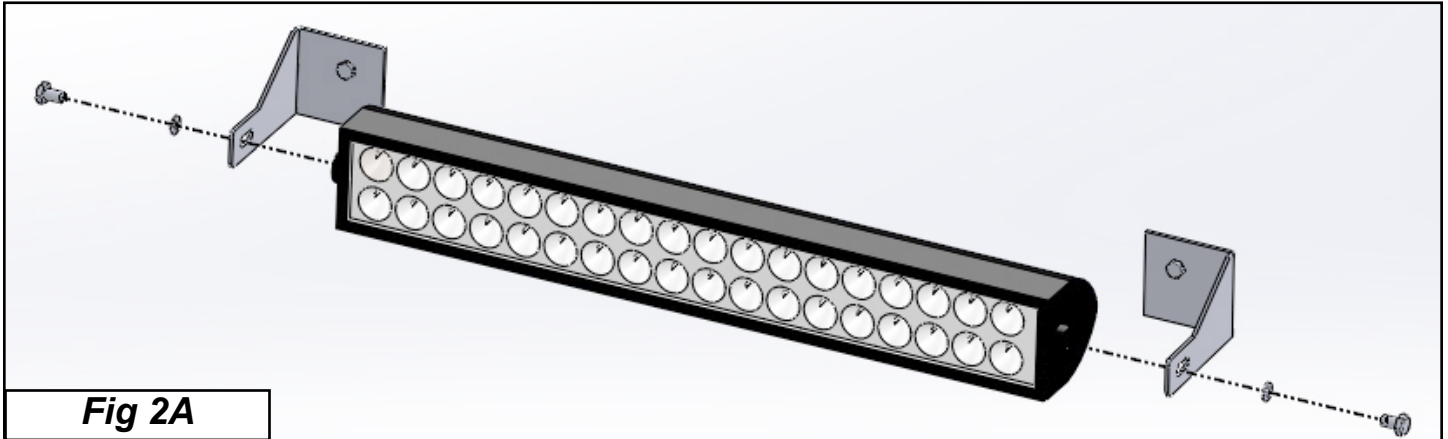

Fig 2A

Step 3

Insert the light assembly into the into the lower bumper opening. Behind the opening you will see two holes in the factory sheet metal. The welded studs on the brackets go in thru there. (Fig 3)

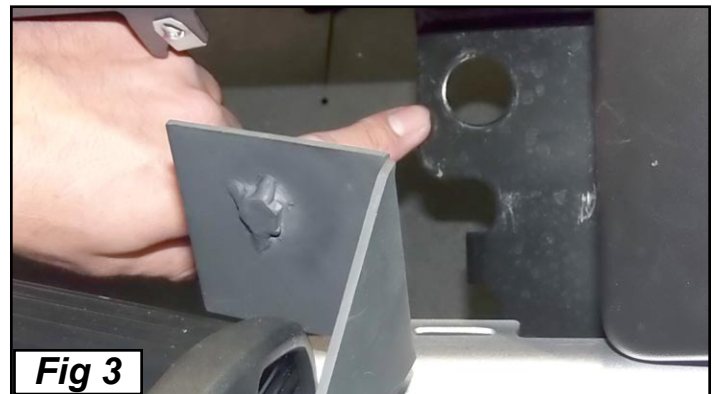

Fig 3

Step 4

Working from the back of the bumper secure the light assembly to the bumper with the inc included 1/2" bolts, lock washers and washers. (Fig 4)



Fig 4

Step 5

Wire LED Light Bar via our T-Rex optional wiring harness kit (part# 639HAR1) or custom wiring harness. T-Rex recommends Torch Lights be wired with our optional wiring harness kit (part#639HAR1). Also adjust the angle of your Light Bar,. It is best to adjust the angle with the vehicle on level ground with lights facing a wall, garage door or other solid barrier. We recommend checking from a distance of 25'. Your installation is now completed. (Fig 5)



Fig 5