

INSTALLATION INSTRUCTIONS AND PARTS LIST

APPLICATION: MODEL 289921/489921 (STAINLESS STEEL) SIDE ENTRY STEP BOARDS:
ROCKER PANEL MOUNT APPLICATION

1. READ INSTRUCTIONS COMPLETELY AND CHECK TO MAKE SURE THAT ALL REQUIRED PARTS (LISTED ON SERVICE PARTS LIST) ARE ON HAND BEFORE STARTING THE INSTALLATION.
2. **NOTE: REFER TO FIG 1. AND CHECK THAT THE STEP BOARD BRACKETS ARE MOUNTED IN THE CORRECT LOCATIONS.** WITH THE STEP BOARD BRACKETS ATTACHED TO THE VEHICLE ON THE LEFT SIDE OF THE VEHICLE PLACE THE STEP BOARD (ITEM #1) ON THE BRACKETS AND CHECK THAT THE MOUNTING HOLES LINE UP. (THE LUVERNE STICKER SHOULD BE ON THE FRONT DRIVERS SIDE)
3. USING FOUR (4) 10-24 X .75" BLACK CARRIAGE BOLTS (ITEM #3), AND SIX (6) 10-24 FLANGE NUTS (ITEM #4) ATTACH THE STEP BOARD TO THE BRACKETS. NOTE: TWO CARRIAGE BOLTS SHOULD ALREADY BE INSTALLED UNDERNEATH THE STEP PAD.
4. ADJUST STEP IN/OUT TO ALIGN STEP WITH THE CAB.
5. TIGHTEN THE STEP MOUNTING BOLTS.
6. REPEAT FOR RIGHT SIDE OF VEHICLE.

SERVICE PARTS LIST

ITEM	QTY	DESCRIPTION
1	1	STEP PLATE-SES, BLACK, LH, REG CAB, 289921
2	1	STEP PLATE-SES, BLACK, RH, REG CAB, 289921
3	12	BOLT – CARRIAGE – SST, BLK, 10-24 X .75"
4	12	NUT – FLANGE, SST, 10-24



REG CAB

fig. 1

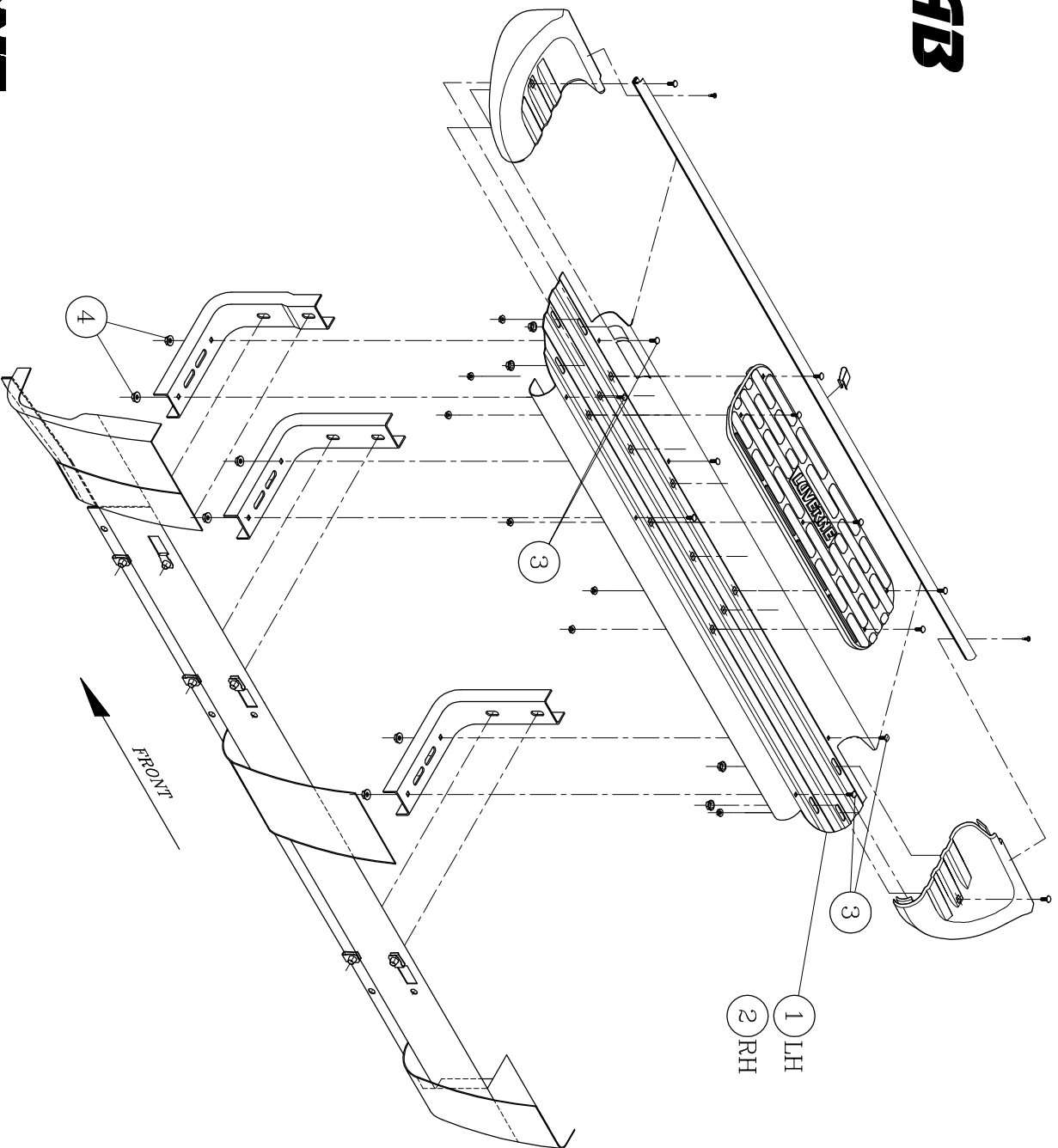

LEFT (DRIVER) SIDE SHOWN
-RIGHT (PASSENGER) SIDE OPPOSITE-

