

COMPETITION/PLUS[®]

FOUR SPEED FLOOR SHIFT

U.S. PATENT NO. 3,216,274 & NO. 3,306,126

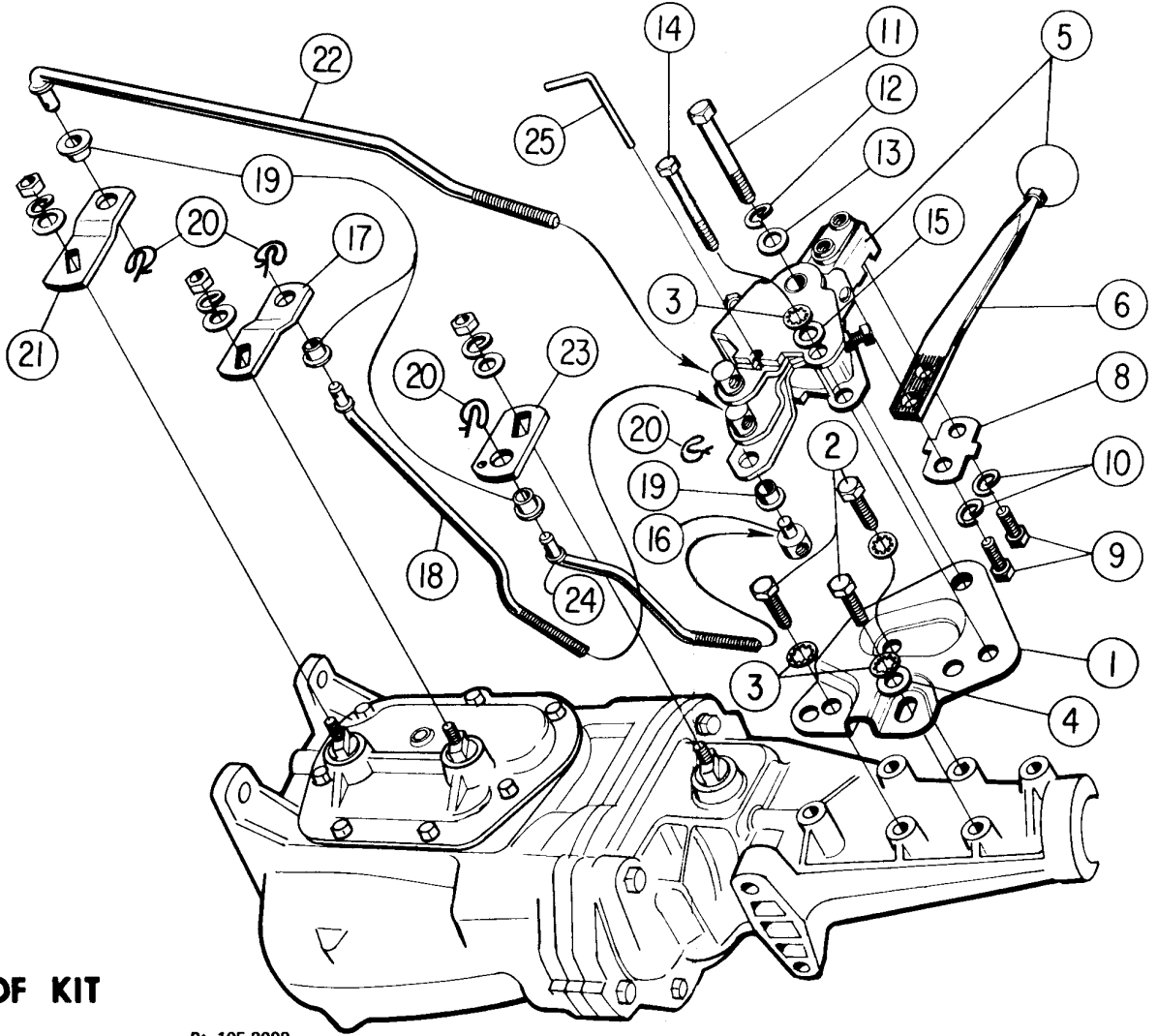

CONTENTS OF KIT

- | | |
|---|------------------|
| 1. MOUNTING PLATE | Pt. 195 8008 |
| 2. 3/8 - 16 x 3/4 HEX HEAD CAP SCREW | (3) |
| 3. 3/8" INTERNAL TOOTH LOCKWASHER | (4) |
| 4. 3/8" FLATWASHER - STANDARD THICKNESS | |
| 5. SHIFTER ASSEMBLY | Pt. 391 7992 |
| 6. STICK | Pt. 238 7991 |
| 7. SPACER BLOCK* | Pt. 228 8397 |
| 8. STIFFENER PLATE | Pt. 195 5271 |
| 9. 3/8 - 24 x 1 3/8 HEX HEAD CAP SCREW | (2) |
| 10. 3/8" SPLIT LOCKWASHER | (2) |
| 11. 7/16 - 20 x 3 HEX HEAD CAP SCREW | |
| 12. 7/16" SPLIT LOCKWASHER | |
| 13. 7/16" FLATWASHER | |
| 14. 3/8 - 24 x 2 3/4 HEX HEAD CAP SCREW | |
| 15. 3/8" FLATWASHER | |
| 16. ROD ADJUSTING BUTTON | Pt. 119 3783 (3) |
| 17. ARM 1 - 2 | Pt. 105 2440 |
| 18. ROD 1 - 2 | Pt. 213 2144 |
| 19. NYLON BUSHING | Pt. 118 1681 (6) |
| 20. SPRING CLIP | Pt. 127 2412 (6) |
| 21. ARM 3 - 4 | Pt. 105 2441 |
| 22. ROD 3 - 4 | Pt. 213 2145 |
| 23. ARM REVERSE | Pt. 105 2445 |
| 24. ROD REVERSE | Pt. 213 2146 |
| 25. NEUTRAL ALIGNMENT ROD | Pt. 148 1725 |

373 4648

Console equipped cars only

IMPORTANT

Install spacer block (Pt. 8397) between stick and shifter - center mark on block must face shifter.

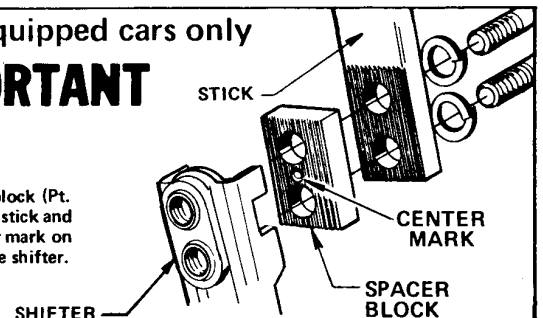

BAGGED HARDWARE Pt. 154 4097

*Optional part - used only in cars equipped with console.