

# Alternator Bracket Assembly Instructions

555-50547

1987-1993 Ford Mustang 5.0L

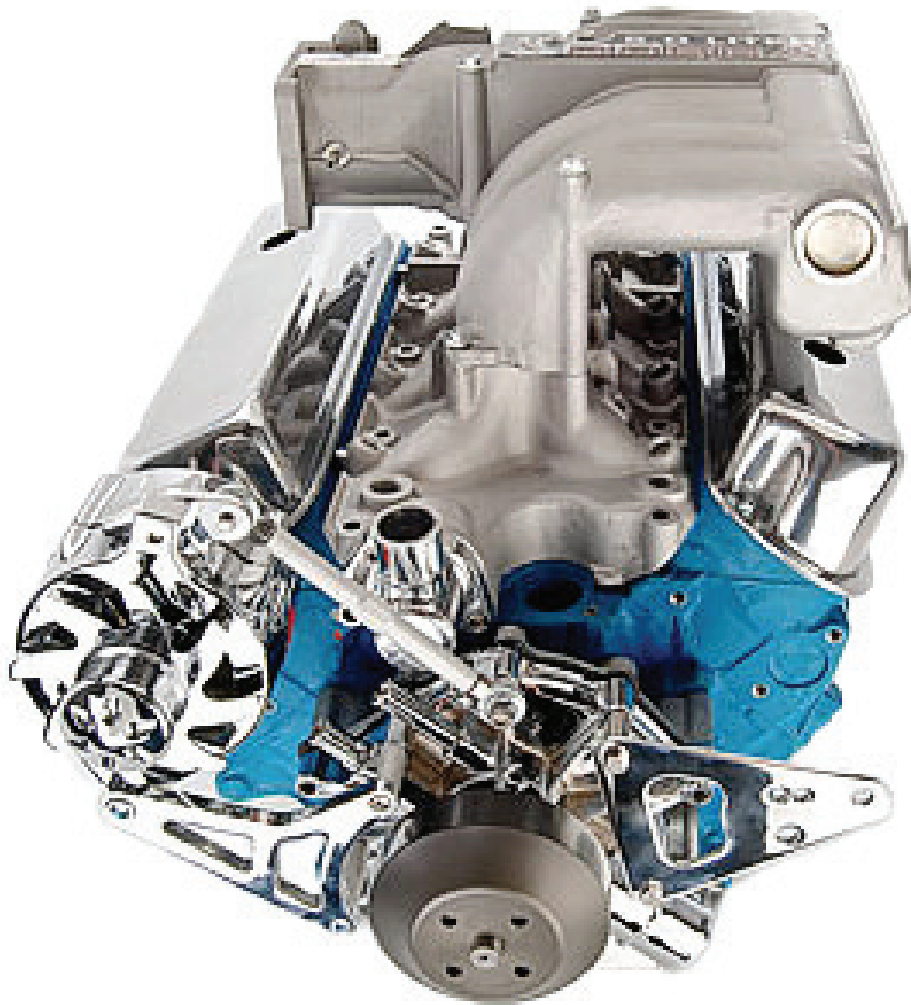

**JEGS.com**

1-800-345-4545

# Parts List

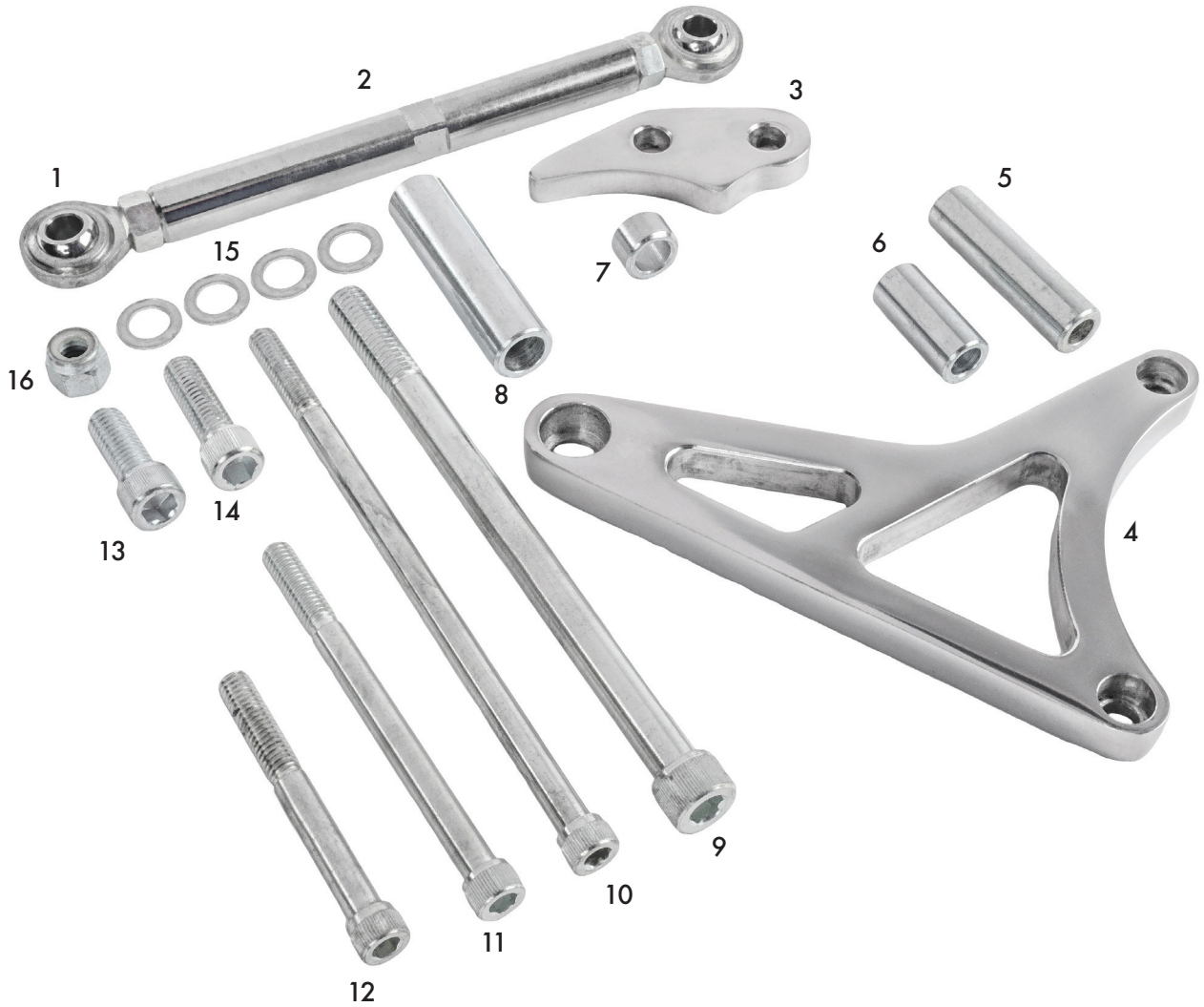

#	DESCRIPTION	QTY	#	DESCRIPTION	QTY	#	DESCRIPTION	QTY
1	Rod End	2	7	Spacer (3/8 in. x 0.400 in.)	1	13	Bolt (3/8 in.-16 x 1 in.)	1
2	Tensioning Rod	1	8	Spacer (7/16 in. x 2.560 in.)	1	14	Bolt (3/8 in.-16 x 1 1/4 in.)	1
3	Upper (Alternator) Mount	1	9	Bolt (7/16 in.-14 x 6 1/2 in.)	1	15	Washer (3/8 in.)	4
4	Lower (Water Pump) Mount	1	10	Bolt (5/16 in.-18 x 6 1/2 in.)	1	16	Locknut (3/8 in.)	1
5	Spacer (5/16 in. x 2 1/4 in.)	1	11	Bolt (5/16 in.-18 x 4 1/2 in.)	1			
6	Spacer (5/16 in. x 1 5/8 in.)	1	12	Bolt (3/8 in.-16 x 2 1/2 in.)	1			

# Installation

1. Remove all of the original bracketry
2. Attach the Lower Mount #4 to the water pump. Use Bolt #11 and Spacer #6 for the upper hole and Bolt #10 and Spacer #5 for the lower hole.
3. Install the Upper Mount #3 to the rear of the alternator mounting ear using the Bolt #13.
4. Connect the alternator to the Lower Mount #4 using Bolt #9 and Spacer #8. The spacer is positioned between the alternator and the cylinder head.
5. Attach one Rod End #2 of the tensioning rod to the upper water pump hole using Bolt #12 and Spacer #7. The second Rod End #2 connects to the Upper Mount #3 using Bolt #14, Washer #15, and Locknut #16.
6. Secure all bolts.
7. Set belt tension by rotating the tensioning rod until the desired amount is achieved. Tighten the rod end nuts to secure.

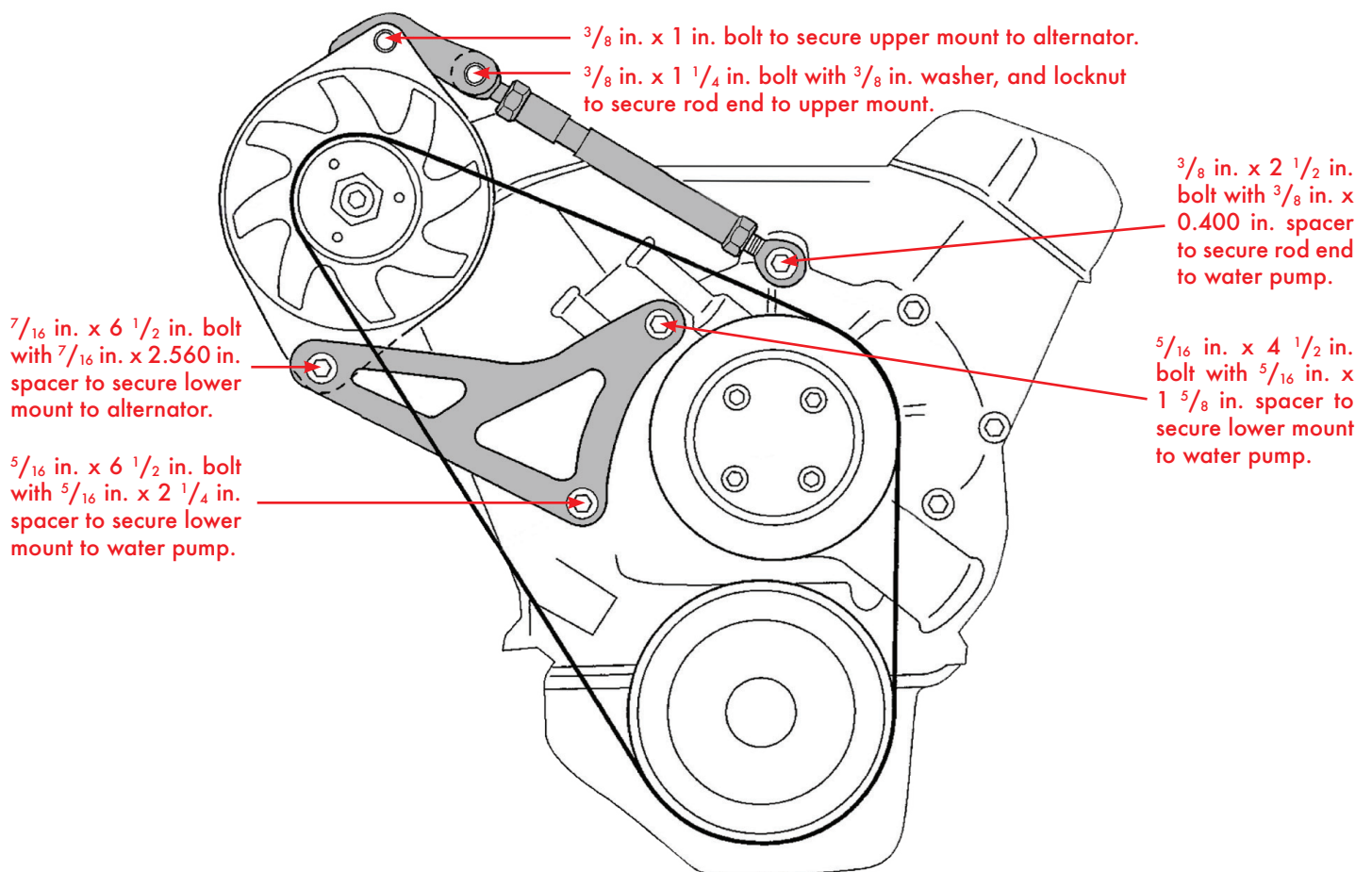

**ENSURE THAT ALL BOLTS ARE SECURELY TIGHTENED BEFORE OPERATING.**