

Installation Instructions for 80041 1250 lb. Engine Stand

CAUTION:

1. Maximum capacity = 1250 lbs.
2. Work on flat, level surface only.
3. Never attempt to move loaded stand across floor having cracks or other obstacles which might impede movement of wheels.
4. Never work directly under a supported engine.
5. **DO NOT** load beyond rated capacity.
6. Be sure load and stand are stable.
7. Periodically inspect stand to insure your safety.
8. Failure to follow any of these instructions may result in property damage or personal injury.
9. Never roll stand without lock pin securing mounting plate in a locked position.

ASSEMBLY INSTRUCTIONS:

1. Attach Main Post(1) and Front Legs(2) to Side Leg(3) with Six 1/2"x3-1/2" Long Bolts(4), Six 1/2" Lock Washers(5) and Six 1/2" Hex Nuts(6).
2. Insert Two 1/2"x1" Long Bolts(7) into corners of Side Legs(3). Bolts will thread into Hex Nuts welded inside of Front Legs(2).
3. Slide Head Assembly(8) into collar at top of Main Post(1). Align holes and slide in Lock Pin(9).
4. Attach Four Mounting Arms(10) to Head Assembly with Four 1/2"x2-1/2" Long Bolts(11), Four 1/2" Flat Washers(12), Four 1/2" Lock Washers(5) and Four Hex Nuts(13) as shown. Mounting Arms can be adjusted to a majority of engines.

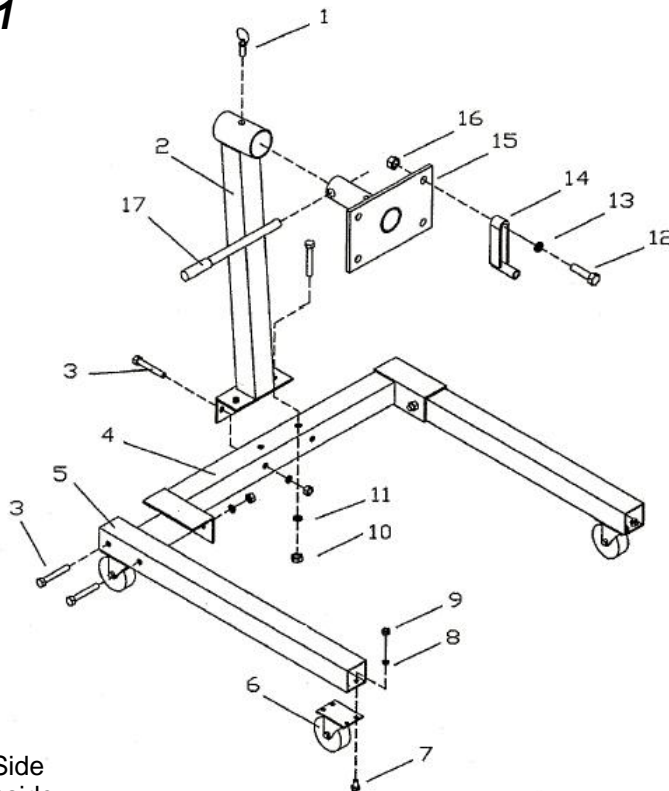

PARTS LIST:

(#)	Description	Qty.
1	Pin	1
2	Vertical Column	1
3	Bolt M12 x 80	8
4	Rear Cross Beam	1
5	Legs	2
6	Wheel	4
7	Bolt, M8 x 16	16
8	M8 Spring Washer	16
9	M8 Nut	16
10	M12 Nut	6
11	M12 Spring Washer	6
12	Bolt M14 x 60	4
13	M14 Washer	4
14	Shifting Stand	4
15	Turning Plate	1
16	M14 Nut	4
17	Handle	1