

Installation Instructions for 80108
Heavy-Duty Tire & Wheel Cart
150 lb. Capacity

1. Heavy-duty cart lifts up to 150 lbs.
2. Prevents back strain when removing and replacing heavy truck wheels and tires.
3. Three inch casters allow for accurate positioning under tire.
4. Cart supports weight as wheel slides off hub. Replacing wheel is just as simple.
5. Rollers on each leg allow wheel to be rotated for stud alignment as wheel slides onto hub.

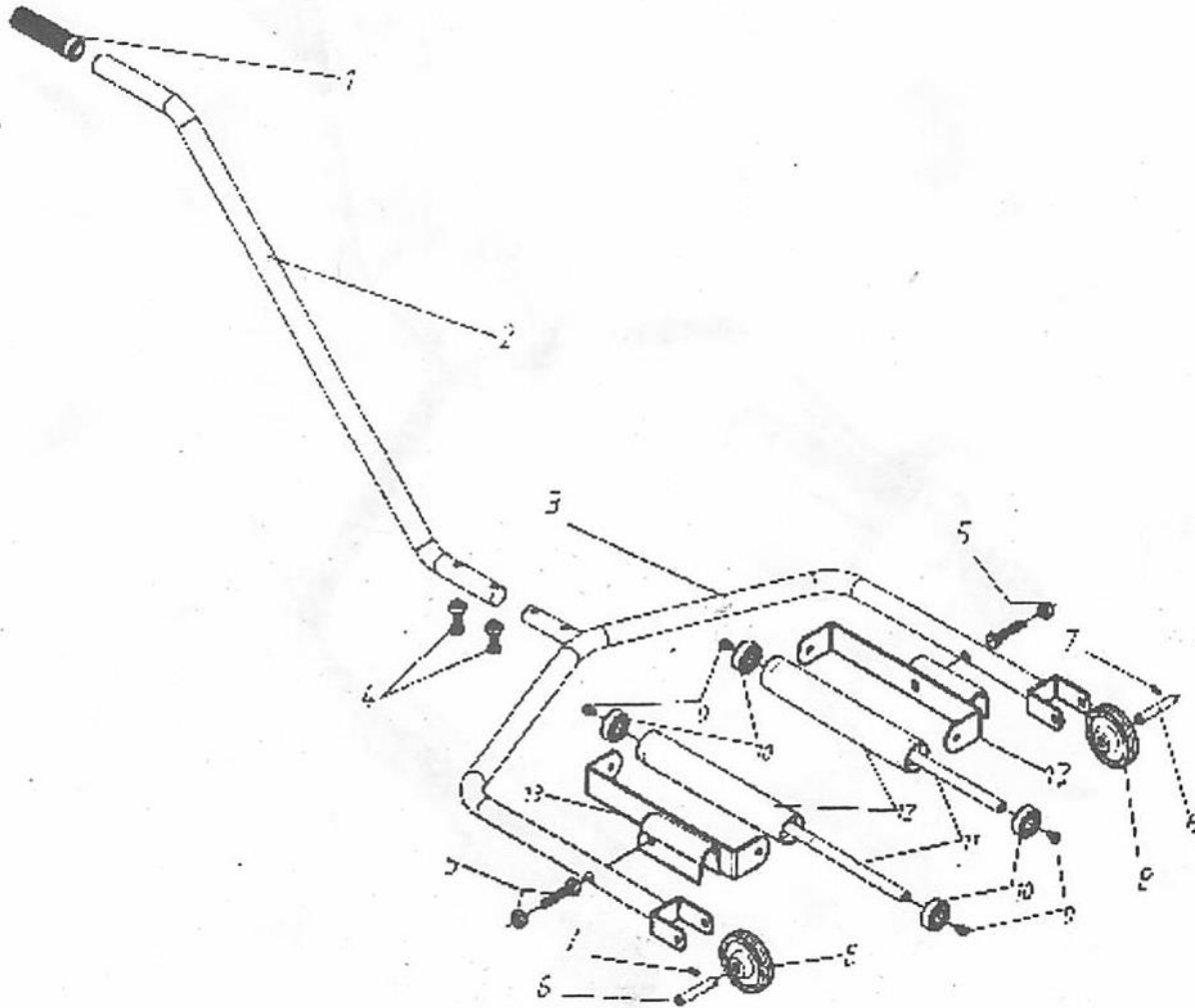

Part #	Description	Qty	Part #	Description	Qty
1	Handle Cover	1	8	Wheel	2
2	Handle	1	9	Bolt	4
3	Frame	1	10	Axletree	4
4	Screw, Nut	2	11	Axis	2
5	Screw, Nut	2	12	Roller	2
6	Pin	2	13	Roller Frame	2
7	Cotter Pin	2			