

# Installation Instructions for 81155

## Mechanic's Tool Box Seat

### 3-Drawer

#### Specifications

**Capacity:** 350 lbs.

**Overall Dimensions:** 26-3/8" x 14-1/8" x 16"

**Maximum Drawer Capacity:** 22 lbs.

**Side Tool Tray Maximum Capacity:** 11 lbs.

This product is designed to support a maximum capacity of 350 lbs. (159 kg.), including all tools and equipment. It is intended to be used to support and transport, along a smooth and level surface. This product is not intended, designed or engineered to be used for any other purpose.

*Specifications are subject to change without notice.*

#### Important Safety Information

**WARNING!** Read understand and follow all instructions and warnings before operating this tool. Failure to do so may result in personal injury and/or property damage and will void warranty.

#### Parts Diagram

Part	Description	Qty
1	Stool Pad	1
2	Body Frame	2
3	Plastic Tray	2
4	Side Tray Frame	2
5	Bolt M6 x 10 Tool	2
6	Holder Shelf	1
7	Bolt M6 x 30	8
8	Plastic Tube Cap	4
9	2.5" PVC Caster	4
10	Bolt M8 x 40	4
11	Nut M8	8
12	Washer M8	8
13	Body with 3 Drawers	1
14	Sleeve Nut	4
15	Bolt M8 x 16	4
16	Washer M8	4
17	Bolt M8 x 35	4
18	Support Bar	2
19	Buckle	2

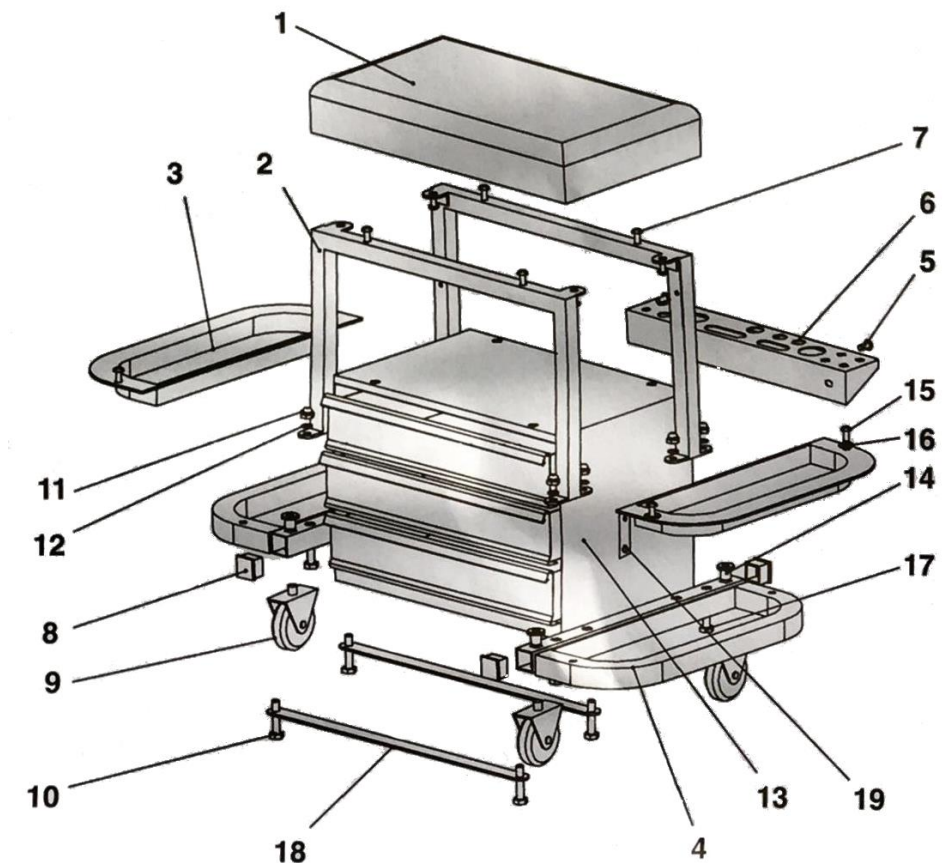

## **Assembly**

Before assembly of this product, make sure all parts are present. Compare parts with the contents list and diagram. If any part is missing or damaged, do not attempt to assemble, install or operate the product.

**Step 1:** Assemble 4 casters (no. 9), through the hole on the side tray's frame (no. 4) as shown in Fig A. Then tighten the sleeve nut using an inner hexagon wrench.

**Step 2:** To assemble two magnetic tool trays, insert the bolt (no. 10) through the support bar (no. 18), then through the holes on the frame of side tray (no. 4), then through the body frame (no. 2), then add the washer (no. 12) to tighten the nut (no. 11) as shown (Fig. B).



**Step 3:** To assemble the rear tool and screwdriver holder, screw the bolt (no. 5) into the hole on the back side of the body, as shown (Fig. C).

**Step 4:** Final assembled product shown (Fig. D).

**Step 5:** The side tray folds down using the Buckle (no. 19), which is inserted in the hole in the frame, as shown (Fig. E).

## **Care & Maintenance**

Little maintenance is required for this product. Wipe clean as needed; use mild upholstery cleaner (not caustic) to clean seat.

- NEVER add lubricant to casters!
- Periodically check that all of the fasteners are tight.
- Keep the seat clean. Wash it with a mild soap and dry immediately.

## **Storage**

When you are finished using the stool, store in a safe place where it will not disturb or hinder others.

