

Owner's Manual & Safety Instructions

# Folding Welding Table



## Specifications

Table Surface	75.8x50.5cm
Table Height	82.8cm
Maximum Weight Capacity	150kgs

## IMPORTANT SAFETY INFORMATION

### Assembly Precautions

1. Assemble only according to these instructions. Improper assembly can create hazards.
2. Wear ANSI-approved safety goggles and heavy-duty work gloves during assembly.
3. Keep assembly area clean and well lit.
4. Keep bystanders out of the area during assembly.
5. Do not assemble when tired or when under the influence of alcohol, drugs or medication.
6. Weight capacity and other product capabilities apply to properly and completely assembled product only.

### Use Precautions

1. This product is not a toy. Do not allow children to play with or near this item.
2. Use as intended only. Do not sit or stand on Table.
3. Inspect before every use; do not use if parts are loose or damaged.
4. Use only on flat, level, hard surface.
5. Do not exceed listed weight capacity. Tighten all knobs securely before applying load.  
**Be aware of dynamic loading!**  
Sudden load movement may briefly create excess load causing product failure.
6. Maintain product labels and nameplates. These carry important safety information.

## Assembly Instructions



Read the **ENTIRE IMPORTANT SAFETY INFORMATION** section at the beginning of this document including all text under subheadings therein before set up or use of this product.

**Note:** For additional information regarding the parts listed in the following pages, refer to the Assembly Diagram near the end of this manual.

Unwrap and separate all parts on a clear work area.

### Vertical Post – Angle Bracket Assembly

Attach the two Angle Brackets (14) to the Vertical Posts (19) using one Washer (12), M8 Nut (11) and M8x45 Bolt (13) per Post-Bracket assembly. Refer to Figure A.

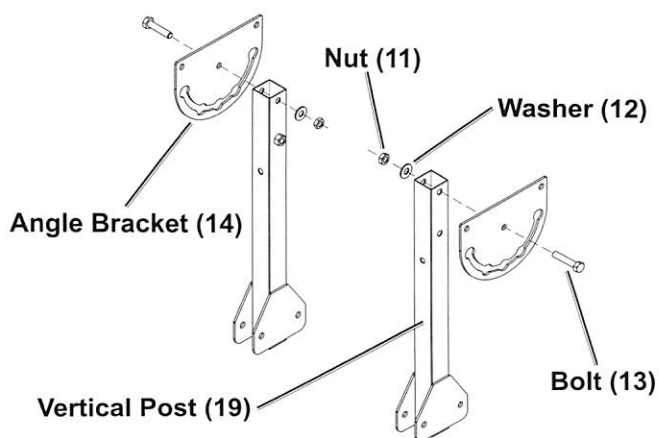

Figure A

# Support Leg Assembly

Attach the two Vertical Post-Angle Bracket assemblies from the previous step to the two Support Legs (21, 25) using eight Washers (12), four M8 Nuts (11), and four M8x50 Bolts (20). Refer to Figure B.

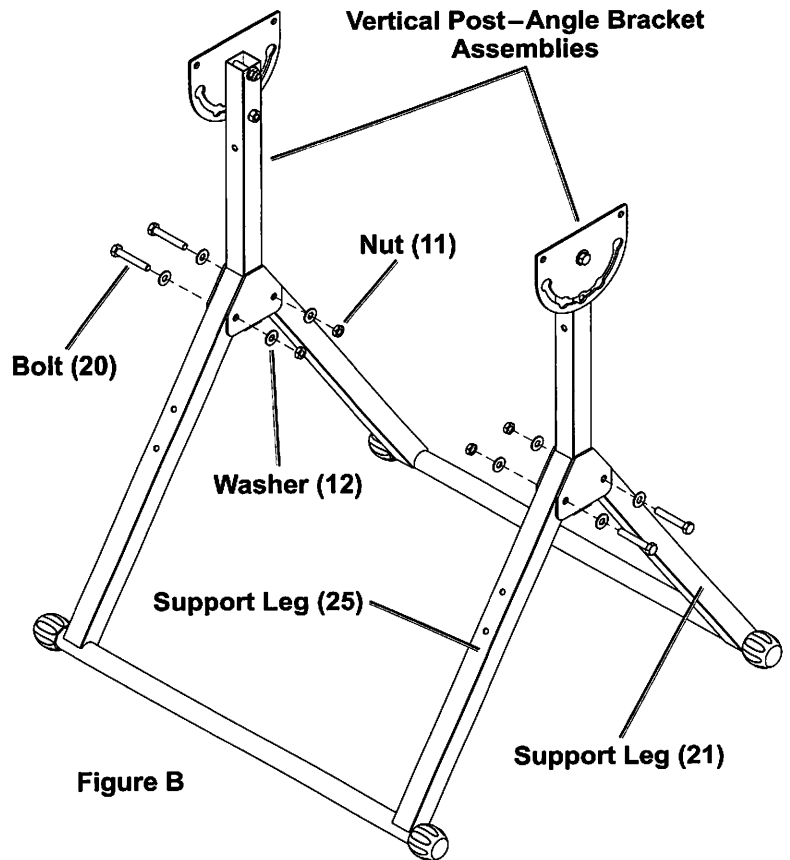

Figure B

# Tool Hanger – Support Brace – Angle Handle Assembly

1. Attach the Tool Hanger (23) to the Support Leg (25) which has four threaded holes using four M5x10 Bolts (24). Refer to Figure C.
2. Attach the Support Brace (18) to the Vertical Posts using two Washers (12), M8 Nuts (11) and M8x60 Bolts (17). Refer to Figure C.
3. Insert a M8x55 Bolt (16) through the back of each of the two Angle Adjustment Handles (27). Slide a Washer (15) over each Bolt with the cupped side of the Washer against the Handle. Insert the Bolts through the Angle Brackets and thread into the nut welded to the Vertical Post. Refer to Figure C.

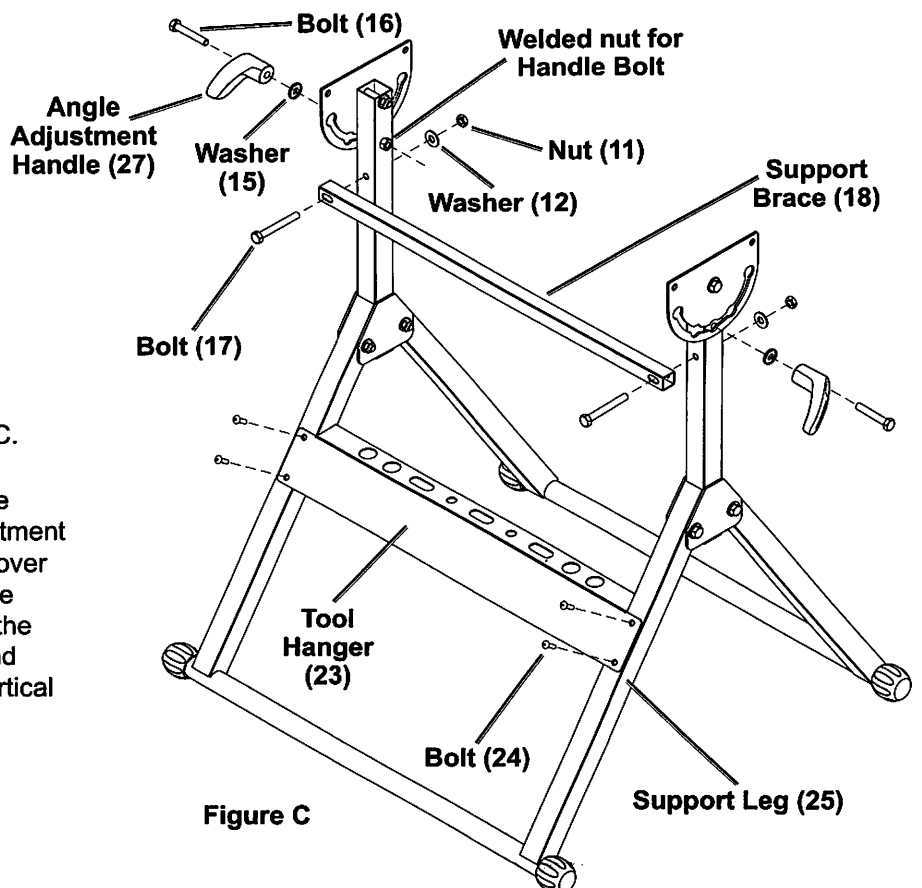
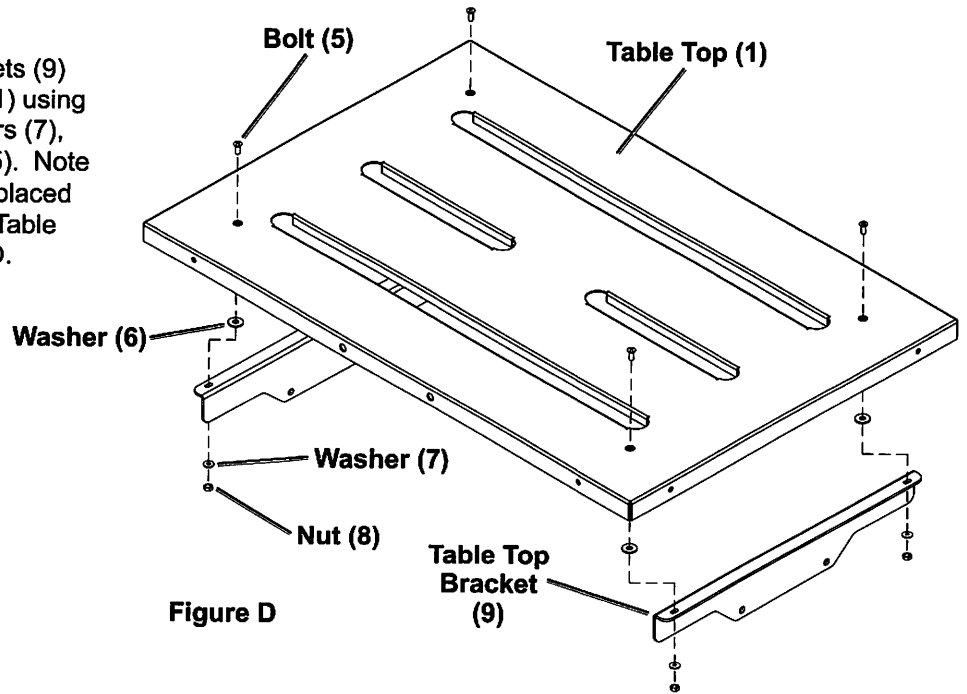

Figure C

# Table Top Bracket Assembly

Attach the two Table Top Brackets (9) to the bottom of the Table Top (1) using four Large Washers (6), Washers (7), M5 Nuts (8) and M5x16 Bolts (5). Note that the Large Washers (6) are placed between the Table Top and the Table Top Brackets. Refer to Figure D.



## Attaching the Table Top

The two Angle Brackets each have five positive stop positions which allow the Table Top, once attached, to be positioned at five different angles. Prior to attaching the Table Top, ensure that the Brackets are set in the middle position and that the Angle Adjustment Handles are tightened securely. Refer to Figure E.

1. With assistance, lift the Table Top and place in position over the upright table stand.
2. Insert four M8x16 Bolts (10) through the Angle Brackets and Table Top Brackets and secure in place using four Washers (12) and M8 Nuts (11). Tighten all hardware. Refer to Figure E.

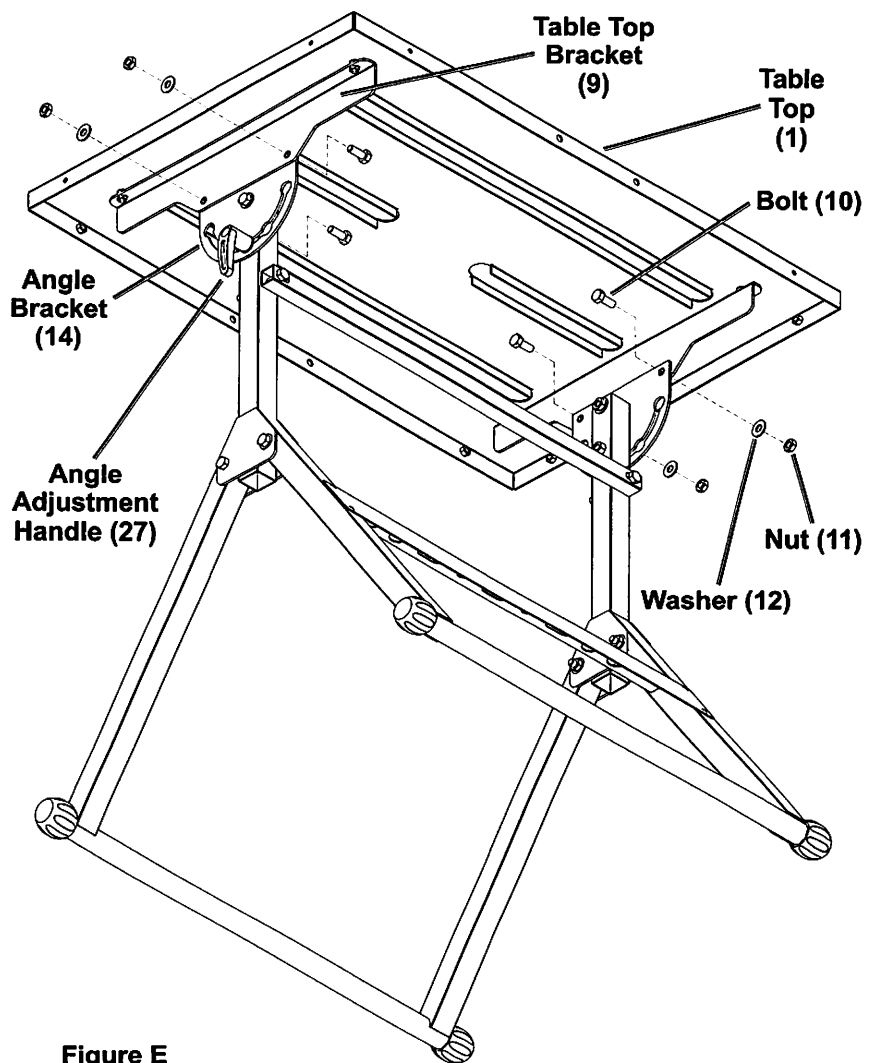

# Installing the Guide Rails

1. Place four Washers (26) on the shafts of the four Lever Bolts (4).
2. Attach the Short Guide Rail (2) and the Long Guide Rail (3) in the desired position on the Table Top (1) using the four Lever Bolts and Washers. Refer to Figure F.

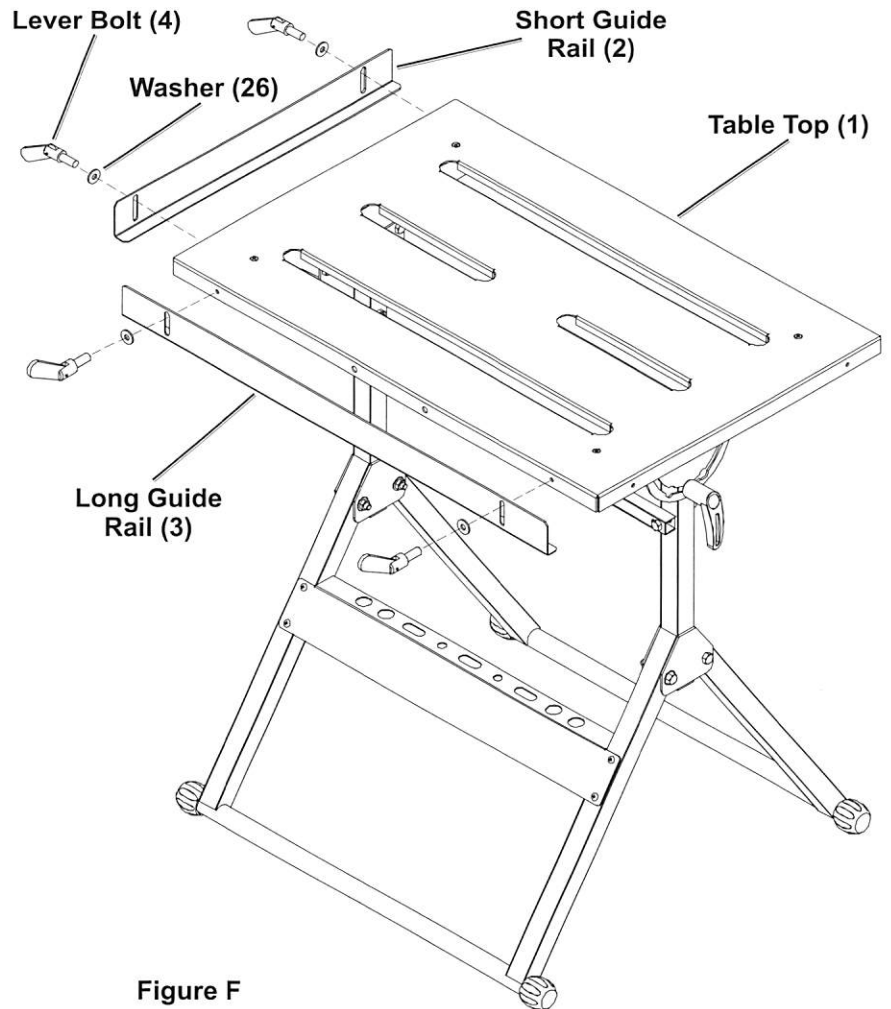

Figure F

## Maintenance

### Inspection, Maintenance, and Cleaning

1. **BEFORE EACH USE**, inspect the general condition of the Welding Table. Check for:
  - loose hardware
  - misalignment or binding of parts
  - cracked or broken parts
  - any other condition that may affect its safe operation.
2. **AFTER USE**, wipe external surfaces of the Table with clean cloth.

## Parts List

Part	Description	Qty
1	Table Top	1
2	Short Guide Rail	1
3	Long Guide Rail	1
4	Lever Bolt M6x15	4
5	Bolt M5x16	4
6	Large Washer	4
7	Washer Ø5.0mm	4
8	Nut M5	4
9	Table Top Bracket	2
10	Bolt M8x16	4
11	Nut M8	12
12	Washer Ø8.0mm	16
13	Bolt M8x45	2
14	Angle Bracket	2

Part	Description	Qty
15	Handle Washer	2
16	Bolt M8x55	2
17	Bolt M8x60	2
18	Support Brace	1
19	Vertical Post	2
20	Bolt M8x50	4
21	Support Leg (without threaded holes)	1
22	Foot	4
23	Tool Hanger	1
24	Bolt M5x10	4
25	Support Leg (with threaded holes)	1
26	Washer Ø6.5x1.2mm	4
27	Angle Adjustment Handle	2