



Equipped with AEM® Dryflow™ Filter  
No Oil Required!

# INSTALLATION INSTRUCTIONS

## PART NUMBER

### 21-772C (Gun Metal Gray Finish)

---

2012-16	SUBARU	IMPREZA	2.0L
2013-16	SUBARU	CROSSTREK	2.0L

Not legal for sale or use on any pollution controlled motor vehicle in California or states adopting California emission procedures. See [AEMIntakes.com](http://AEMIntakes.com) for CARB status on each part for a specific vehicle.

ITEM NO.	PART NUMBER	DESCRIPTION	QTY.
1	1-2051	BOLT; BTN HD M4-0.7 X 6MM	2
2	102489	EDGE TRIM; 3/4"BULB, TOP LOC., 30"L	1
3	444.460.04	NUT; M6 HEX SERRATED	2
4	08160	WASHER; 1"D X 1/4 HOLE FENDER	1
5	1228599	MOUNT, RUBBER 1" X 6MM	1
6	102466	EDGE TRIM; 1/16"GAP, 12"L	1
7	20-478	HEAT SHIELD; SUBARU, TB/PC	1
8	9-21070	MAF INSERT; AIR STRTRNR, 2.59"OD, PLASTIC	1
9	9448	1/2" BNDHOSE CLAMP, 2.56"-3.50"	1
10	21-2027DK	AIR FILTER; 2.75" X 7" DRYFLOW	1
11	2-1559C	INTAKE TUBE; 2.75"OD X 49", 21-772; GRAY	1
12	08185	HOSE; 2-3/4" ID X 2-1/2" L HUMP REINFORCED	1
13	9444	HOSE CLAMP, 2.31-3.25"	2
14	5-5021	HOSE; 1/2"ID X 21"L	1
15	409	SUPER GLUE, 3G DRIP PROOF	1

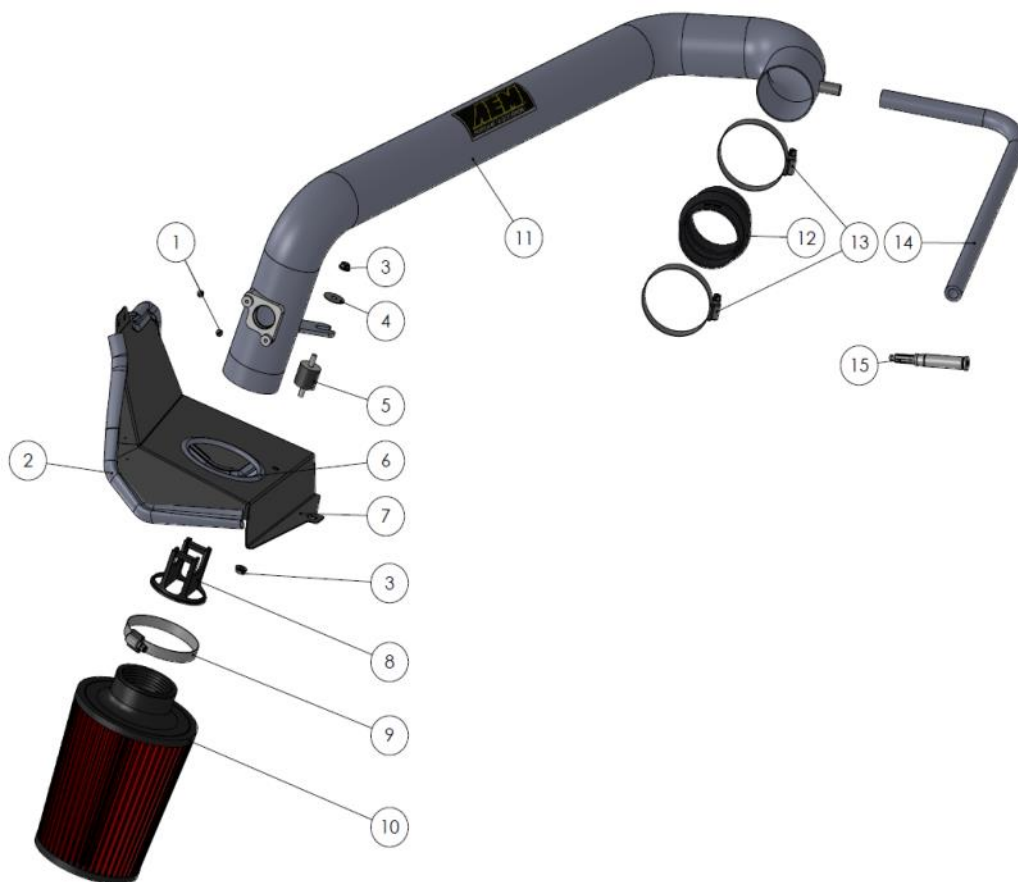

Read and understand these instructions **BEFORE** attempting to install this product. Failure to follow installation instructions and not using the provided hardware may damage the intake tube, throttle body and engine.

**Tools Needed:**

Screw driver  
10MM socket  
Socket Driver  
Side Cutters  
4MM Hex Key

**1. Preparing Vehicle**

- a. Make sure vehicle is parked on level surface.
- b. Set the parking brake.
- c. If engine has run in the past two hours, let it cool down.
- d. Disconnect negative battery terminal.
- e. Do not discard stock components after removal of the factory system.
- f. Open the air intake kit package and make sure all parts are included.

**2. Removal of stock system**



a. Remove the scoop and the two clips from the vehicle. The scoop will not be reinstalled but do not discard.

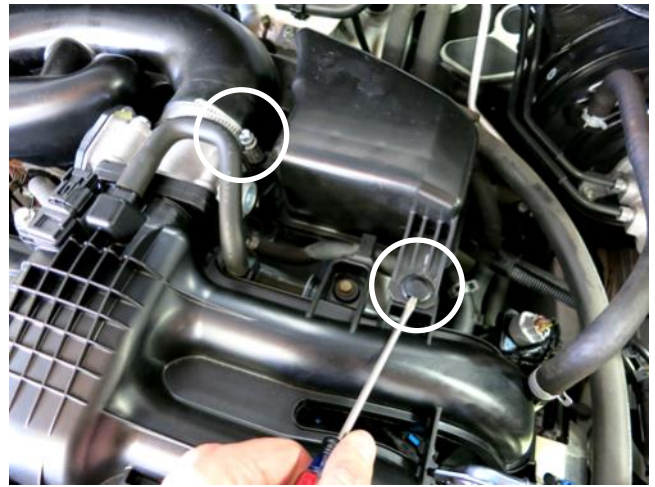

b. Remove the clip securing the stock intake resonator to the engine. Then loosen the hose clamp at the throttle body.

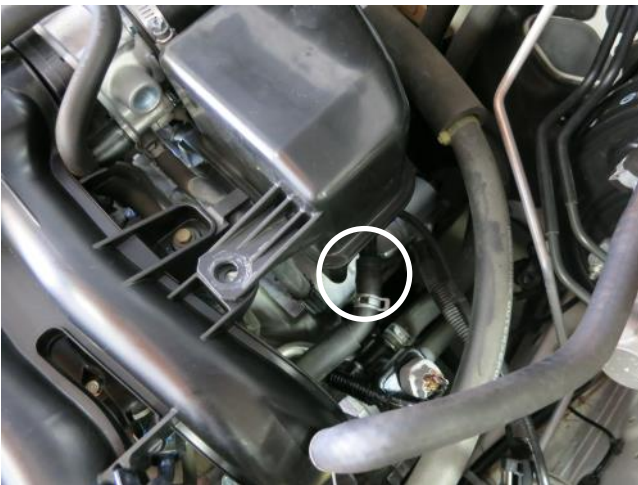

c. Release the pressure on the spring clamp and remove the vent hose underneath the resonator.



d. Loosen the hose clamp at the air box and remove the stock intake tube from the vehicle.





e. Depress the tab on the mass air sensor connector and disconnect it from the mass air sensor.



f. Remove the two nuts on the inner fender as well as the bolt on the lower air box. Then remove the air box from the vehicle. The nuts will be reused in step 3b. Note: Do not discard any of your stock equipment.

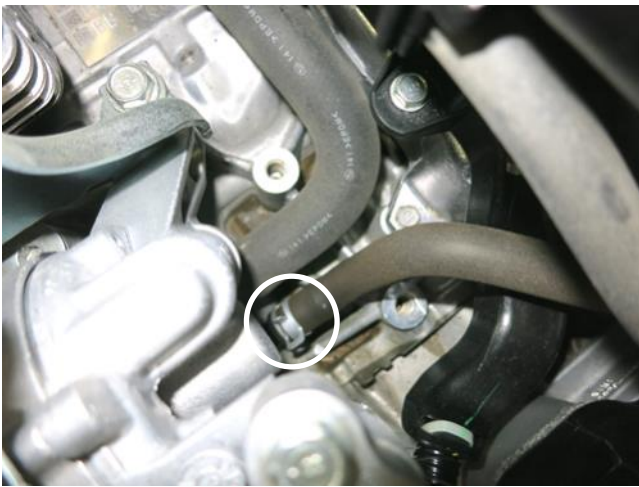

g. Follow the vent line from step 2c to the engine, and release the pressure on the spring clamp, and remove the vent line from the vehicle. Note: The spring clamps will be reused in step 3i.



h. Remove the two screws securing the mass air sensor to the stock upper air box lid. Note: The screws will not be reused but the sensor will.



i. Remove the three clips securing the passenger side lower splash shield and pull the splash shield down.

### 3. Installation of AEM® intake system.

- a. When installing the intake system, do not completely tighten the hose clamps or mounting hardware until instructed to do so.



a. Install the edge trim and rubber mount onto the AEM heat shield according to the parts diagram on pg. 2.



b. Install the AEM heat shield in the vehicle

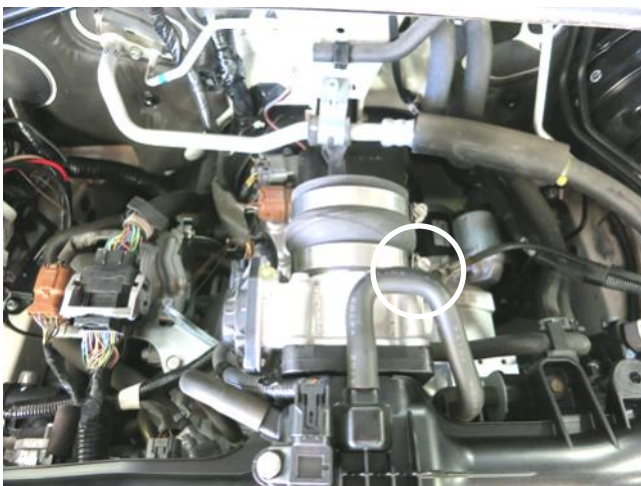

c. Install the provided hose and hose clamps onto the throttle body. Tighten the hose clamp closest to the throttle body now.



d. Install the MAF sensor that was removed in step 2h. and secure with the provided Allen head bolts.





e. Install the MAF insert into the end of the tube and align it as shown. Note: Use a few drips of super glue on the insert's lip to hold it in place in the tube.



g. Install the AEM filter onto the AEM intake tube from under the vehicle and secure with the provide hose clamp.



i. Install the new provided vent hose from the AEM intake tube to the engine where step 2g was disconnected. Secure with the factory spring clamps removed in step 2g.



f. Install the AEM intake tube into the vehicle aligning it with the coupler and the hole in the heat shield. Using the provided hardware, secure the bracket to the heat shield. Tighten the hose clamp at this time.



h. Reinstall the 3 clips and secure the passenger side lower splash shield to the bumper.



j. Plug the mass air sensor connector back into the mass air sensor.



STOCK INTAKE INSTALLED



AEM INTAKE INSTALLED

#### 4. Reassemble Vehicle

- a. Position the inlet pipes for the best fitment. Be sure that the pipes or any other components do not contact any part of the vehicle.
- b. Check for proper hood clearance. Re-adjust pipes if necessary and re-tighten them.
- c. Inspect the engine bay for any loose tools and check that all fasteners that were moved or removed are properly tightened.
- d. Reconnect negative battery terminal and start engine. Let the vehicle idle for 3 minutes. Perform a final inspection before driving the vehicle.

#### 5. Service and Maintenance

- a. AEM Induction Systems requires cleaning the intake system's air filter element every 100,000 miles. When used in dusty or off-road environments, our filters will require cleaning more often. We recommend that you visually inspect your filter once every 25,000 miles to determine if the screen is still visible. When the screen is no longer visible some place on the filter element, it is time to clean it. To clean, purchase our Synthetic air filter cleaner, part number 1-1000 and follow the easy instructions.
- b. Use window cleaner to clean your powder coated AEM<sup>®</sup> intake tube.

**NOTE: DO NOT USE aluminum polish on powder coated AEM<sup>®</sup> intake tubes.**

For technical inquiries  
e-mail us at  
[sales@aemintakes.com](mailto:sales@aemintakes.com)  
or  
call us at  
800.992.3000

## **AEM Air Intake System Warranty Policy**

AEM® warrants that its intake systems will last for the life of your vehicle. AEM® will not honor this warranty due to mechanical damage (i.e. improper installation or fitment), damage from misuse, accidents or flying debris. AEM® will not warrant its powder coating if the finish has been cleaned with a hydrocarbon-based solvent. The powder coating should only be cleaned with a mild soap and water solution. Proof of purchase of both the vehicle and AEM® intake system is required for redemption of a warranty claim.

This warranty is limited to the repair or replacement of the AEM® part. In no event shall this warranty exceed the original purchase price of the AEM® part nor shall AEM® be responsible for special, incidental or consequential damages or cost incurred due to the failure of this product. Warranty claims to AEM® must be transportation prepaid and accompanied with dated proof of purchase. This warranty applies only to the original purchaser of product and is nontransferable. Improper use or installation, use for racing, accident, abuse, unauthorized repairs or alterations voids this warranty. AEM® disclaims any liability for consequential damages due to breach of any written or implied warranty on all products manufactured by AEM®. Warranty returns will only be accepted by AEM® when accompanied by a valid Return Merchandise Authorization (RMA) number. Credit for defective products will be issued pending inspection. Product must be received by AEM® within 30 days of the date RMA is issued.

If you have a warranty issue, please call (800) 992-3000 and our customer service department will assist you. A proof of purchase is required for all AEM® warranty claims.

**Not legal for sale or use on any pollution controlled motor vehicle in California or states adopting California emission procedures. See [AEMIntakes.com](http://AEMIntakes.com) for CARB status on each part for a specific vehicle.**