



Equipped with AEM® Dryflow™ Filter
No Oil Required!

INSTALLATION INSTRUCTIONS

PART NUMBER

21-804C (GUN METAL GRAY FINISH)

2016	SCION	iA	1.5L
2017-19	TOYOTA	YARIS iA	1.5L
2016-17	MAZDA	CX-3	2.0L

Not legal for sale or use on any pollution controlled motor vehicle in California or states adopting California emission procedures. See AEMIntakes.com for CARB status on each part for a specific vehicle.

ITEM NO.	PART NUMBER	DESCRIPTION	QTY.
1	21-2011DK	AIR FILTER; 2-1/2" FLG, 5-1/2" B, 4-3/4" T, 5"H	1
2	2-1587C	INTAKE TUBE; 2.50"OD X 10", 21-804, GUNMETAL GRAY	1
3	20-8586	HEAT SHIELD; 21-804, 2016 SCION IA, TB/PC	1
4	08476	HOSE; 2-1/2" TO 2-1/4" ID X 2" L TPRD REINFORCED	1
5	8-4030	EDGE TRIM, 30"	1
6	8-4012	EDGE TRIM, 12"	1
7	9440	HOSE CLAMP, 2.15-3.00"	2
8	9436	1/2" BNDHOSE CLAMP, 1.81"-2.75"	1
9	07733	BOLT; M4 - 0.7 8MM, A/H CAP, SS	2
10	5-1002	HOSE; 3/8"ID X 2"L	1

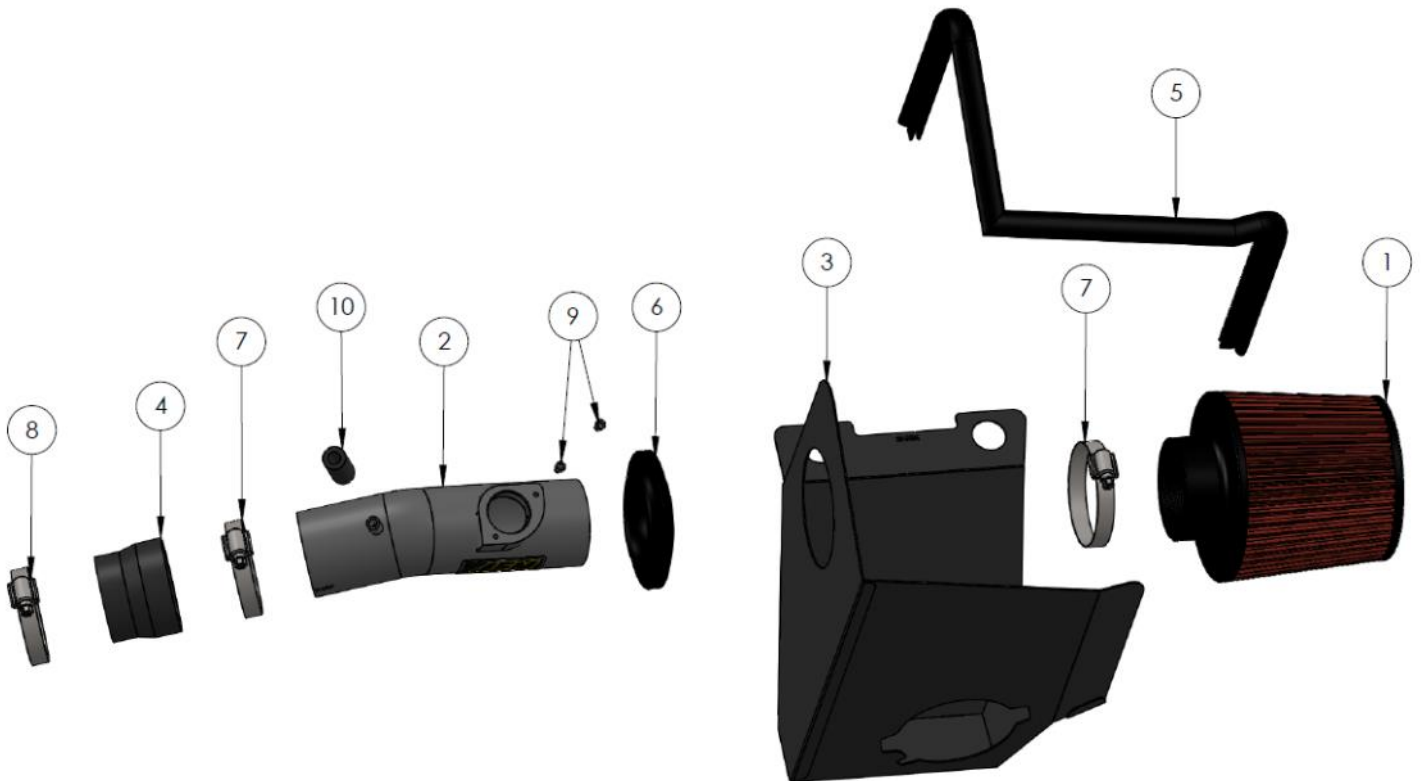

Read and understand these instructions **BEFORE** attempting to install this product. Failure to follow installation instructions and not using the provided hardware may damage the intake tube, throttle body and engine. If you need any assistance please call 1-800-858-3333 to speak with a representative in our Customer Service Center before returning the product.

1. Preparing Vehicle

- a. Make sure vehicle is parked on level surface.
- b. Set the parking brake.
- c. If engine has run in the past two hours, let it cool down.
- d. Disconnect negative battery terminal.
- e. Do not discard stock components after removal of the factory system.
- f. Open the air intake kit package and make sure all parts are included.

Tools Needed:	Optional:
---------------	-----------

Screwdriver	Small Torque Wrench
10mm, 8mm, 7mm Socket	
Socket Driver/ Ratchet	
Side Cutters	
3mm Hex Key	

2. Removal of stock system



a. Carefully pull up on the engine cover and remove it.



b. Unplug harness from MAF (Mass Air Flow) sensor.



c. Use a 7mm socket and ratchet to loosen the throttle body hose clamp. Then, pull the PCV line out from the nipple on the intake hose.



d. Use a 10mm socket and ratchet to remove the (2) M6 bolts holding the intake snorkel to the radiator shroud. These bolts will be reused in step 3f.

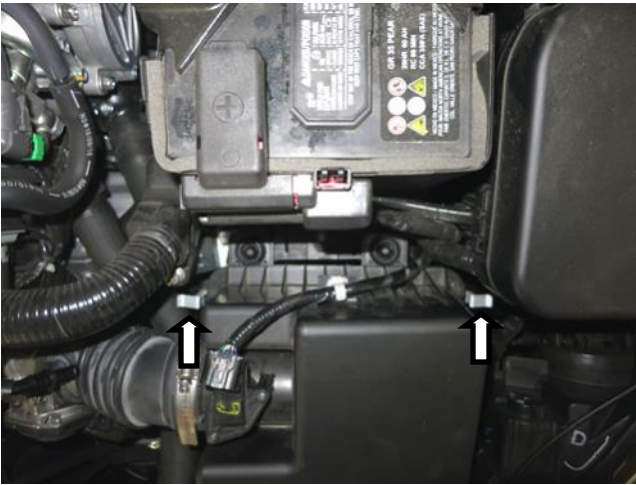

e. Release the spring clamps holding the stock air box halves together.

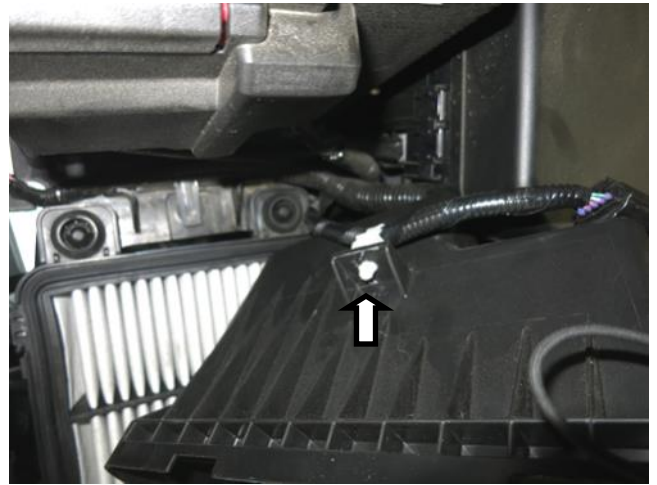

f. Pull the intake hose off of the throttle body and flip the upper air box around. Then, unclip the MAF sensor harness from the upper air box.



g. Remove the upper air box and intake hose assembly from the vehicle.



h. Pull up on the lower air box and snorkel assembly and remove it from the vehicle.



i. Remove the (3) rubber grommets from the lower air box. These grommets will be reused in step 3a.

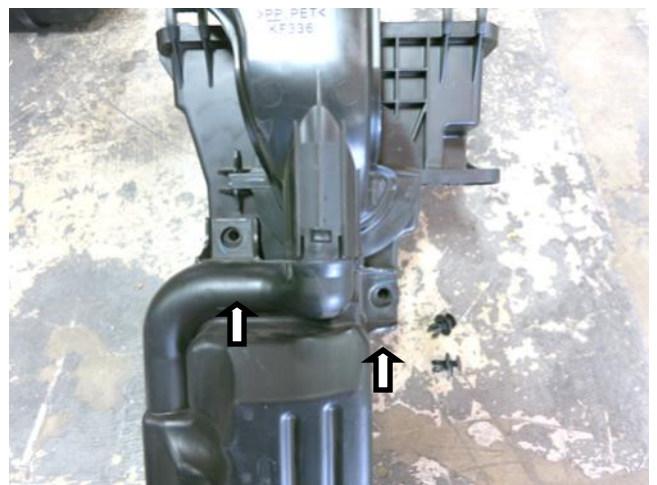

j. Remove the (2) push-in clips holding the snorkel to the lower air box. These clips will not be reused. However, AEM recommends that you do not discard any factory components.



k. Pull on the tab, indicated above, while rotating the snorkel counter-clockwise until the retaining tabs on the snorkel outlet line up with the cutouts in the lower air box. This will allow you to separate the snorkel from the lower air box. The snorkel will be reused with the AEM intake system.



l. Remove the (2) Phillips head screws holding the MAF sensor to the upper air box. Then, remove the MAF sensor. The MAF sensor will be reused with the AEM intake system.

3. Installation of AEM® intake system.

- a. When installing the intake system, do not completely tighten the hose clamps or mounting hardware until instructed to do so.

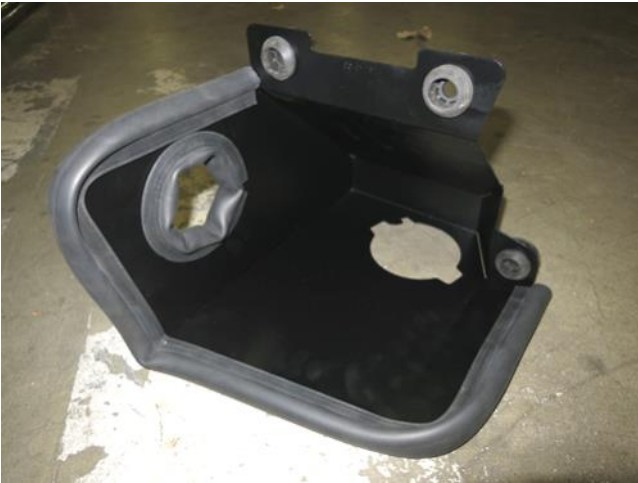

a. Assemble the heat shield. Apply the supplied edge trim as shown above. Trim to fit as necessary. Then, insert the (3) grommets removed in step 2i.



b. Align the retaining tabs in the snorkel outlet to the cutouts in the heatshield, insert, and rotate clockwise until the snorkel is in the orientation shown above.



c. Verify that the snorkel outlet is fully seated into the heatshield.



d. Install the tapered coupler onto the throttle body, making sure the smaller end goes onto the throttle body. Use the supplied #36 hose clamp to tighten the coupler onto the throttle body.



e. Install the heatshield and snorkel assembly into the vehicle. Make sure the (3) grommets are fully seated onto their respective posts.



f. Fasten the snorkel to the radiator shroud using the (2) M6 bolts removed in step 2d.



g. Insert the AEM intake tube into the heat shield from the throttle body side. Then, insert the tube into the throttle body coupler with the supplied #40 hose clamp. Do not tighten the hose clamp yet.



h. Install the AEM filter onto the tube. Use the remaining #40 hose clamp to tighten the filter onto the tube. Then, adjust the intake tube for best fitment. Once you are satisfied with the fitment, tighten the #40 hose clamp on the throttle body coupler.



i. Insert the MAF sensor into the intake tube. Use the (2) supplied M4 socket head bolts and a 3mm hex key to fasten the MAF sensor.



j. Reconnect the MAF sensor harness.



k. Install the supplied 3/8" hose onto the intake tube nipple.



l. Insert the PCV line into the hose. Finally, reinstall the engine cover.



STOCK INTAKE INSTALLED



AEM INTAKE INSTALLED

4. Reassemble Vehicle

- a. Position all kit components for best fitment. Ensure that no components contact any unintended part of the vehicle.
- b. Check for proper hood clearance. Re-adjust components if necessary and re-tighten them.
- c. Inspect the engine bay for any loose tools and ensure that all fasteners that were moved or removed are properly tightened.
- d. Reconnect negative battery terminal and start engine. Let the vehicle idle for 3 minutes. Perform a final inspection before driving the vehicle.

5. Service and Maintenance

- a. AEM Induction Systems requires cleaning the intake system's air filter element every 100,000 miles. When used in dusty or off-road environments, our filters will require cleaning more often. We recommend that you visually inspect your filter once every 25,000 miles to determine if the screen is still visible. When the screen is no longer visible some place on the filter element, it is time to clean it. To clean, purchase our Synthetic air filter cleaner, part number 1-1000 and follow the easy instructions.
- b. Use window cleaner to clean your powder coated AEM[®] intake tube.

NOTE: DO NOT USE aluminum polish on powder coated AEM[®] intake tubes.

For technical inquiries
e-mail us at
sales@aemintakes.com
or
call us at
800.992.3000

AEM Air Intake System Warranty Policy

AEM® warrants that its intake systems will last for the life of your vehicle. AEM® will not honor this warranty due to mechanical damage (i.e. improper installation or fitment), damage from misuse, accidents or flying debris. AEM® will not warrant its powder coating if the finish has been cleaned with a hydrocarbon-based solvent. The powder coating should only be cleaned with a mild soap and water solution. Proof of purchase of both the vehicle and AEM® intake system is required for redemption of a warranty claim.

This warranty is limited to the repair or replacement of the AEM® part. In no event shall this warranty exceed the original purchase price of the AEM® part nor shall AEM® be responsible for special, incidental or consequential damages or cost incurred due to the failure of this product. Warranty claims to AEM® must be transportation prepaid and accompanied with dated proof of purchase. This warranty applies only to the original purchaser of product and is nontransferable. Improper use or installation, use for racing, accident, abuse, unauthorized repairs or alterations voids this warranty. AEM® disclaims any liability for consequential damages due to breach of any written or implied warranty on all products manufactured by AEM®. Warranty returns will only be accepted by AEM® when accompanied by a valid Return Merchandise Authorization (RMA) number. Credit for defective products will be issued pending inspection. Product must be received by AEM® within 30 days of the date RMA is issued.

If you have a warranty issue, please call (800) 992-3000 and our customer service department will assist you. A proof of purchase is required for all AEM® warranty claims.

Not legal for sale or use on any pollution controlled motor vehicle in California or states adopting California emission procedures. See AEMIntakes.com for CARB status on each part for a specific vehicle.