



INTAKE SYSTEMS FOR VEHICLES LISTED ARE 50 STATE LEGAL. SEE KNFILTERS.COM FOR CARB STATUS ON EACH PART FOR A SPECIFIC VEHICLE.

INSTALLATION INSTRUCTIONS

57-2600
FORD
2017-19 F250 / F350 / F450
V8-6.7L Turbo Diesel

TOOLS NEEDED:

- flat blade screw driver
- ratchet
- extension
- 10mm socket
- 8mm socket
- t20 torx
- 4mm allen

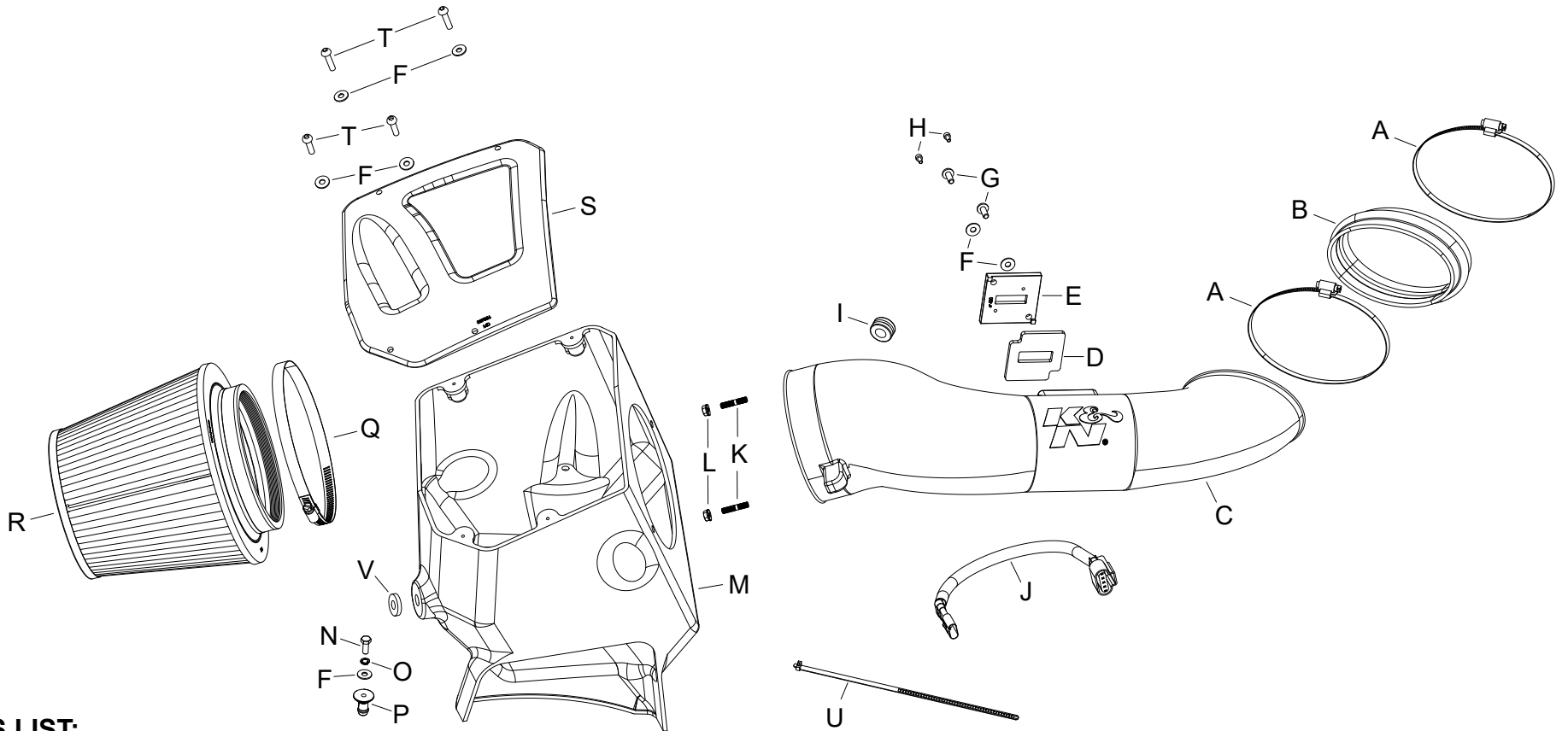

PARTS LIST:

Description	Qty.	Part #	Description	Qty.	Part #	Description	Qty.	Part #
A HOSE CLAMP #72	2	08671	H BOLT; M4 - 0.7 8MM, A/H CAP	2	07733	O WASHER, M6 SPLIT LOCK ZINC	1	1-3025
B HOSE; 4-1/2" ID X 3" L HUMP	1	08695	I GROMMET; 1"OD, 1/2"ID, 1/2"	1	08064	P MOUNT, PLASTIC AIRBOX	1	8-186-1
C INTAKE TUBE (LU)	1	087338A	J MAF EXTENSION HARNESS	1	21780	Q HOSE CLAMP; #104	1	08697
D GASKET; 57-2556, 3/16 PORON	1	09069	K STUD; 6MM-1.00 X 30MM	2	1-107	R FILTER CHARGER	1	RC-5179
E ADAPTOR; 57-2556, NYLON	1	21515-1	L NUT; 6MM-1.00 SERRATED	2	444.460.04	S LID,AIRBOX	1	087408
F WASHER; 6MM FLAT, SS	7	08269	M AIRBOX	1	087407	T BOLT; M6-1.00 X 25MM, SS	4	07729
G BOLT; M6 X 1.00 X 16MM, SS	2	07730	N BOLT; 6MM-1.00 X 16MM, SS	1	07812	U CABLE TIES; 11" BLACK	1	21590
						V SPACER	1	06544

If you need any assistance please call 1-800-858-3333 to speak with a representative in our Customer Service Center before returning the product.

NOTE: FAILURE TO FOLLOW INSTALLATION INSTRUCTIONS AND NOT USING THE PROVIDED HARDWARE MAY DAMAGE THE INTAKE TUBE, THROTTLE BODY AND ENGINE.

TO START:

1. Turn off the ignition and disconnect the negative battery cable.
NOTE: Disconnecting the negative battery cable erases pre-programmed electronic memories. Write down all memory settings before disconnecting the negative battery cable. Some radios will require an anti-theft code to be entered after the battery is reconnected. The anti-theft code is typically supplied with your owner's manual. In the event your vehicles anti-theft code cannot be recovered, contact an authorized dealership to obtain your vehicles anti-theft code.



2. Disconnect the mass air sensor electrical connection.



3. Loosen the hose clamp at the turbo inlet, then release the clamps securing the air filter housing top. Remove the intake tube and air filter housing top from the vehicle.



4. Remove the two bolts that secure the lower air filter housing to the mounting bracket and remove the lower filter housing.
NOTE: K&N Engineering, Inc., recommends that customers do not discard factory air intake.



5. Remove the two bolts that secure the air filter housing mounting bracket to the inner fender and then remove the bracket.
NOTE: One of the bolts will be reused.



6. Using the provided hardware, secure the mounting stud to the K&N® air filter housing as shown.



7. Install the K&N® air filter housing into the vehicle so that the mounting stud sets into the factory mounting grommet, then using the factory mounting bracket bolt and provided spacer, secure the housing to the inner fender.



8. Using caution, set the K&N® air filter into the K&N® air filter housing.
NOTE: It is an extremely tight fit past the upper lip, go slow and use caution, you will need to squeeze the filter together to get it to pass by the lip without damage.



9. Install the provided gasket onto the K&N® mass air sensor adapter.



10. Remove the mass air sensor and filter minder from the factory intake tube.



11. Install the mass air sensor into the K&N® adapter and secure with the provided hardware.



12. Using the provided grommet, install the factory filter minder into the K&N® intake tube. Then install the mass air sensor assembly into the K&N® intake tube as shown.

NOTE: The open end of the mass air sensor should be pointed towards the filter end of the tube.



13. Install the two provided mounting studs into the K&N® intake tube as shown.



14. Install the coupling hose (08695) and hose clamps onto the intake tube and slide it on as far as possible, do not secure.



15. Install the K&N® intake tube into the K&N® air filter housing and align with the turbo inlet. Slide the coupling hose onto the inlet, adjust the tube for best fit and then secure with the provided hardware and hose clamps.



16. Install the air filter onto the K&N® intake tube and secure with the provided hose clamp.



17. Install the air filter housing lid and secure with the provided hardware.



18. Reconnect the mass air sensor electrical connection and use the provided tie wrap to secure the wiring harness.



19. Reconnect the vehicle's negative battery cable. Double check to make sure everything is tight and properly positioned before starting the vehicle.

20. The C.A.R.B. exemption sticker, (attached), must be visible under the hood so that an emissions inspector can see it when the vehicle is required to be tested for emissions. California requires testing every two years, other states may vary.

21. It will be necessary for all K&N® high flow intake systems to be checked periodically for realignment, clearance and tightening of all connections. Failure to follow the above instructions or proper maintenance may void warranty.

ROAD TESTING:

1. Start the engine with the transmission in neutral or park, and the parking brake engaged. Listen for air leaks or odd noises. For air leaks secure hoses and connections. For odd noises, find cause and repair before proceeding. This kit will function identically to the factory system except for being louder and much more responsive.

2. Test drive the vehicle. Listen for odd noises or rattles and fix as necessary.

3. If road test is fine, you can now enjoy the added power and performance from your kit.

4. K&N Engineering, Inc., requires cleaning the intake system's air filter element every 100,000 miles. When used in dusty or off-road environments, our filters will require cleaning more often. We recommend that you visually inspect your filter once every 25,000 miles to determine if the screen is still visible. When the screen is no longer visible some place on the filter element, it is time to clean it. To clean and re-oil, purchase our filter Recharger® service kit, part number 99-5050 or 99-5000 and follow the easy instructions.

INTAKE SYSTEMS FOR VEHICLES LISTED ARE 50 STATE LEGAL. SEE KNFILTERS.COM FOR CARB STATUS ON EACH PART FOR A SPECIFIC VEHICLE.