

TYPHOON INTAKE SYSTEMS

BY 

INSTALLATION INSTRUCTIONS

69-8750

Toyota
2000-2004, Celica
1.8L L4 16v 143 bhp

TOOLS NEEDED:

Phillips screwdriver
Flathead screwdriver
Ratchet
10mm socket
2.5mm allen wrench
3mm allen wrench
4mm allen wrench
Pliers

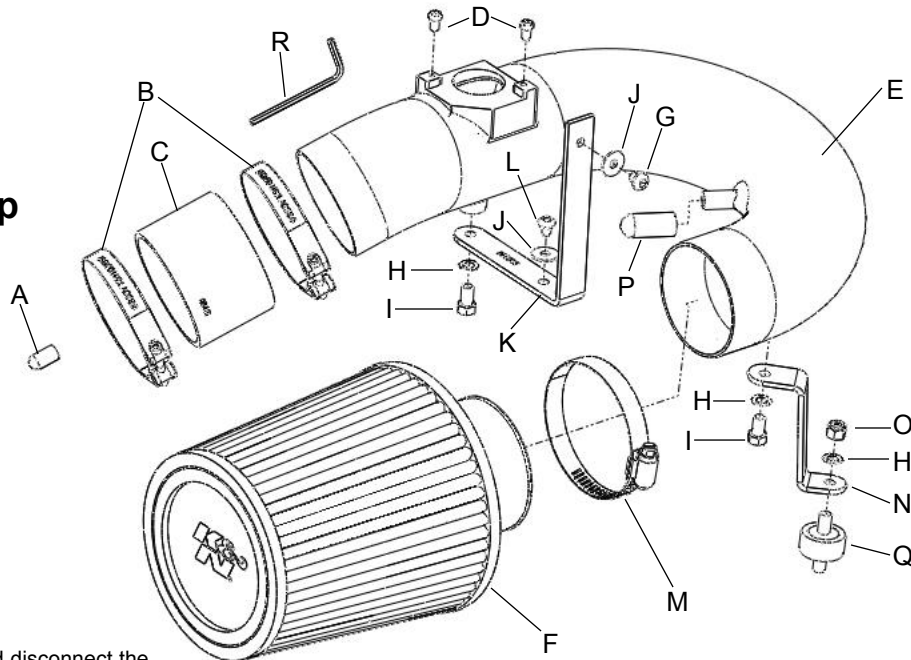

Parts List

Description	Qty.	P/N
A Rubber Cap, Small	1	08282
B Hose Clamp, #300	2	084062
C Silicone Hose, Black	1	08440
D Cap Screw, 4mm x 8mm L.	2	07733
E Typhoon Intake Tube	1	27075
F Filtercharger	1	KRU4870E
G Button Head Screw, 5mm x 8mm L.	1	07740
H 6mm Wave Washer	3	08277
I Hex Bolt, 6mm x 12mm L.	2	07727
J 5mm Flat Washer	2	08212
K "L" Bracket, Large	1	070035
L Button Head Screw, 4mm x 8mm L.	1	07741
M Hose Clamp, #44	1	08577
N "Z" Bracket	1	070038
O 6mm Nylock Nut	1	07512
P Rubber Cap, Large	1	08214
Q 6mm Rubber Mounted Stud	1	07027
R Wrench, allen 9/64	1	69802

TO START:

1. Turn the ignition OFF and disconnect the vehicle's negative battery cable.

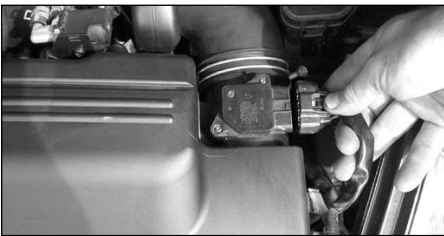

2. Disconnect the mass air sensor electrical connection.

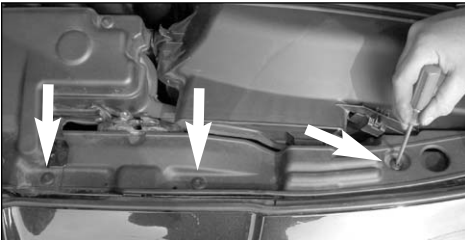

3. Depress the center pins on the push clips on the radiator core support cover as shown.



4. Remove the radiator core support cover as shown.

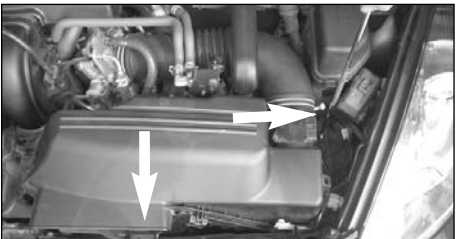

5. Loosen and remove the bolts that secure the air box as shown.



6. Unclip the PWM vacuum switching valve from the rear of the air box as shown.

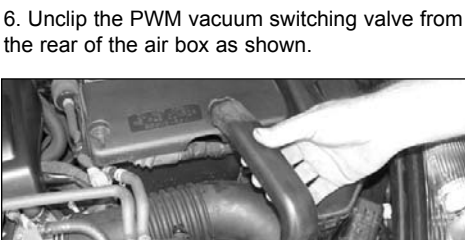

7. Pull firmly to remove the computer fresh air tube as shown.

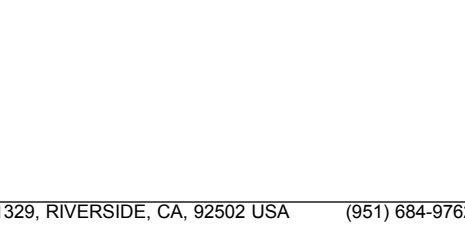

8. Loosen the hose clamps on the stock intake tube and release the rubber clip attaching it to the coolant hose, then, remove the stock intake tube as shown.



9. Remove the breather hose from the air box as shown.

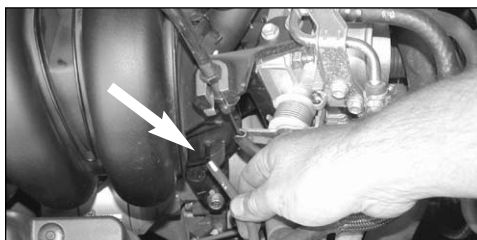

10. Remove the vacuum hose from the intake manifold as shown.



11. Unclip the coolant hose from the rear of the air box as shown.



12. Pull the air box upwards, then rotate it to gain access to the bottom side.



13. Disconnect the vacuum switching valve electrical connection as shown.

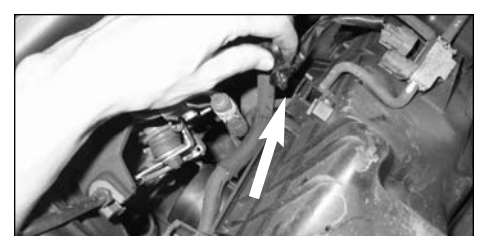
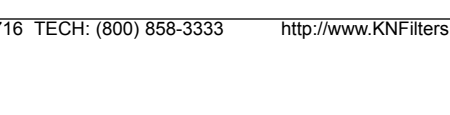

14. Using a pair of pliers unclip the wire harness from the back of the air cleaner assembly as shown.



15. Remove the complete air box assembly as shown.



16. Remove the stock bracket from the PWM vacuum switching valve as shown.

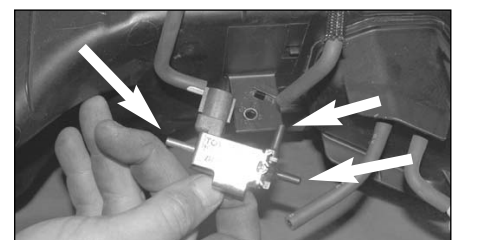

17. Disconnect the vacuum hoses from the vacuum switching valve, then, remove the vacuum switching valve from the bottom of the air cleaner assembly as shown.

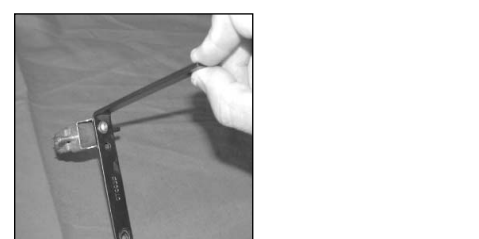

18. Secure the vacuum switching valve to the provided "L" bracket using the provided hardware as shown.



19. Cap the vent on the K&N Typhoon intake tube using the large rubber cap as shown.



20. Remove the mass air sensor from the air cleaner assembly as shown.

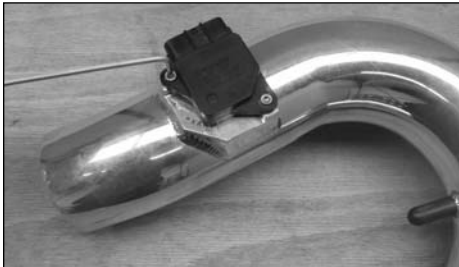

21. Install the mass air sensor into the Typhoon intake tube and secure using the provided hardware as shown.

NOTE: Before installing the mass air sensor, inspect the inside of the tube for any debris, then clean the inside out with water and a towel. Inspect the tube one more time before proceeding to the next step.



22. Secure the "Z" bracket to the threaded boss on the Typhoon intake tube using the provided hardware as shown. Don't fully tighten yet!

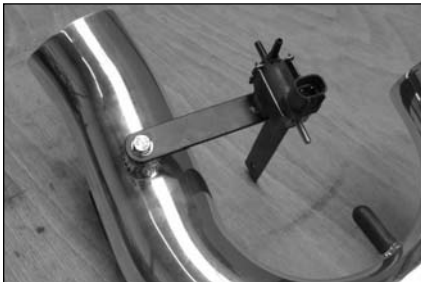

23. Secure and tighten the "L" bracket to the threaded boss on the Typhoon intake tube using the provided hardware as shown.



24. Install the silicone hose and barrel clamps onto the throttle body as shown, using the provided allen wrench.

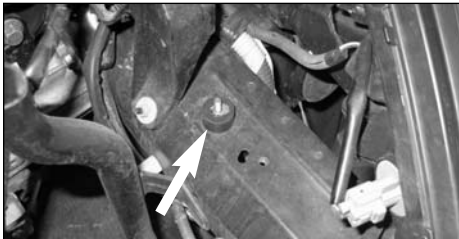

25. Install the provided rubber mounted stud into the existing air cleaner mounting hole as shown.



26. Slide the intake tube assembly into the silicone sleeve as shown. Do not tighten the barrel clamp yet!



27. Line up the "Z" bracket with the rubber mounted stud with the provided hardware as shown. Don't fully tighten yet!

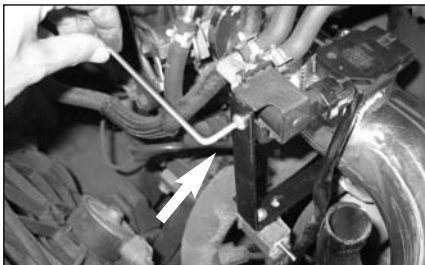

28. Secure the PWM vacuum switching valve to the "L" bracket using the provided hardware as shown.

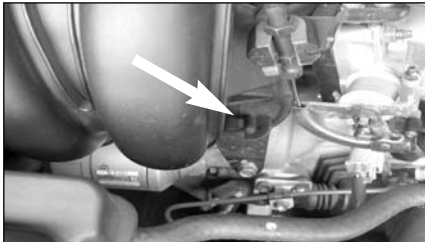

29. Cap the vent on the intake manifold using the provided small rubber plug as shown.

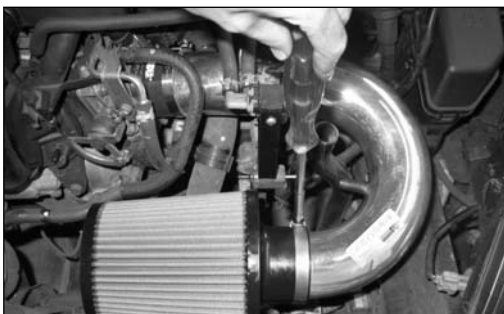

30. Install the K&N Filtercharger onto the intake tube and secure with the provided hose clamp as shown.



31. Adjust the Typhoon intake assembly for best fit and clearance and tighten all hardware and hose clamps as shown.



32. Reconnect the mass air sensor electrical connector as shown.



33. Re-install the computer fresh air tube as shown.

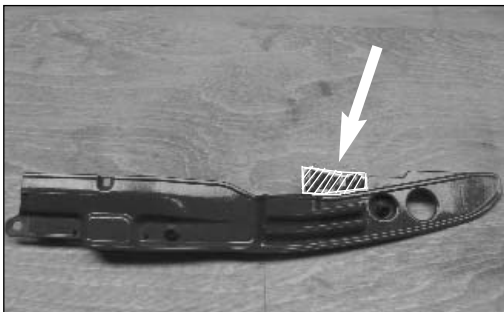

34. If you wish to re-install the radiator core support cover removed in step 4, trim the indicated area as shown.

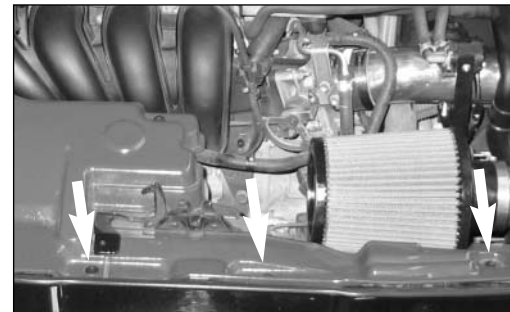

35. Re-install the radiator core support cover using the 3 original push clips.

36. Re-connect the negative battery cable and double check that everything is tight and properly positioned before starting the vehicle.



37. It will be necessary for all Typhoons to be checked periodically for realignment, clearance and tightening of all connections. Failure to follow the above instructions or proper maintenance may void warranty.

ROAD TESTING:

1. Start the engine with the transmission in neutral or park, and the parking brake engaged. Listen for air leaks or odd noises. For air leaks secure hoses and connections. For odd noises, find cause and repair before proceeding. This kit will function identically to the factory system except for being louder and much more responsive.

2. Test drive the vehicle. Listen for odd noises or rattles and fix as necessary.

3. If road test is fine, you can now enjoy the added power and performance from your kit.

4. K&N suggests checking the Filtercharger element periodically for excessive dirt build-up. When the element becomes covered in dirt (or once a year), service it according to the instructions on the Recharger service kit, part number 99-5000 or 99-5050.

