

### 2010 Land Rover LR4 5.0L

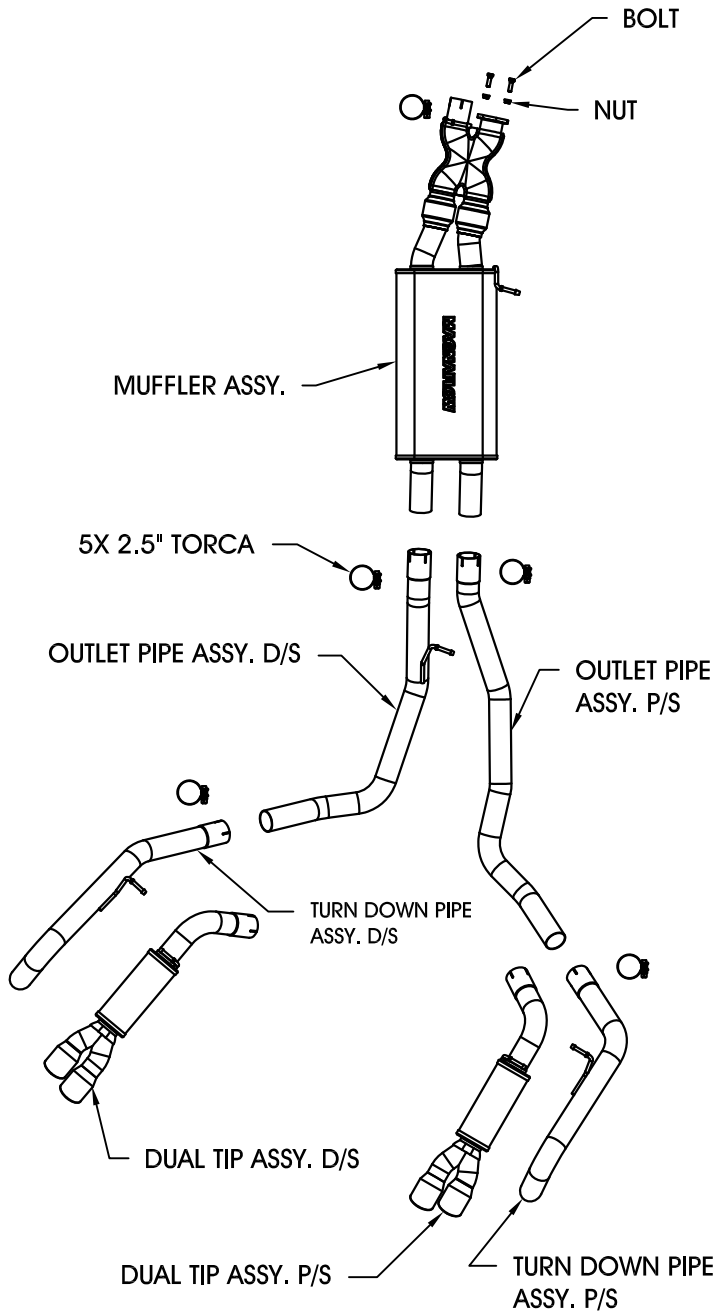

**Warning:** When working on, under, or around any vehicle exercise caution. Please allow the vehicle's exhaust system to cool before removal, as exhaust system temperatures may cause severe burns. If working without a lift, always consult vehicle manual for correct lifting specifications. Always wear safety glasses and ensure a safe work area. Serious injury or death could occur if safety measures are not followed.

**Step 1:** (Carefully read all instructions before installation) Disconnect the vehicle's battery before removal of the OEM exhaust. This will allow the computer to reset itself with the new system, and prevent electrical accidents.

**Step 2:** Unbolt the flange and loosen the clamp on the inlet pipes at the catalytic converter of the OEM system. Carefully remove the rest of the system making sure to retain the mounting hardware and rubber insulators as they will be needed to install your new MAGNAFLOW system.

**Step 3:** Use the supplied 2.5" clamp, nuts and bolts to secure the muffler assembly to the catalytic converter. Slip the outlet pipes over the muffler assembly outlet pipes and secure using the supplied 2.5" clamps. Choose either the turn down or dual tips supplied and attach using the supplied 2.5" clamps. Working front to rear locate each hanger to the existing rubber insulator locations.

**Step 4:** With all components mounted loosely, adjust the system for overall aesthetics and clearance of frame & bodywork. (MAGNAFLOW recommends at least 1/2" of clearance between the exhaust system and any body panels to prevent heat-related body damage or fire.)

**Step 5:** Once a final position has been chosen for the new system, evenly tighten all fasteners from front to rear. The supplied band clamps must be VERY tight to properly align the pipes and prevent leaks (Approximately 40ft-lbs). U-bolt clamps should be tightened to approximately 30-35ft-lbs. Inspect all fasteners after 25-50 miles of operation and retighten if necessary.

\*MAGNAFLOW Performance Exhaust recommends professional installation on all their products

Technical support: 1-800-959-9226 ext. 4500