



# INSTALLATION GUIDE

**2021+ Ford Bronco 2.3L EcoBoost Performance Air Intake**  
**SKU: MMAI-BR23-21**

## TABLE OF CONTENTS

- Pg 1** RESOURCES AND CONTACT INFORMATION
- Pg 2** IMPORTANT SAFETY INFORMATION
  - SUPPLIED PARTS
  - REQUIRED TOOLS
  - INSTALLATION INSTRUCTIONS
- Pg 5** DISPOSAL INSTRUCTIONS
  - WARRANTY INFORMATION

## RESOURCES & CONTACT

-  **CALL 1-877-GOMISHI**  
CUSTOMER SERVICE HOURS: MON-FRI 8:30AM-5:00PM EST
-  **MISHIMOTO**
-  **GOMISHIMOTO**
-  **MISHIMOTO**
-  **WEBSITE**  
[WWW.MISHIMOTO.COM](http://WWW.MISHIMOTO.COM)
-  **ENGINEERING BLOG**  
[WWW.MISHIMOTO.COM/ENGINEERING](http://WWW.MISHIMOTO.COM/ENGINEERING)

## IMPORTANT SAFETY INFORMATION

- › Mishimoto recommends you use safety glasses and protective gloves during the installation of our products
- › Raise vehicle only on jack stands or on a vehicle lift
- › Allow vehicle to cool completely prior to attempting installation
- › Do not run the engine or drive the vehicle while overheating; serious damage can occur
- › Please dispose of any liquids properly
- › Mishimoto is not responsible for any vehicle damage or personal injury due to installation errors, misuse, or removal of Mishimoto products
- › If you need any assistance while installing our products, reach out to our Customer Service Team at 1-877-GOMISHI

## SUPPLIED PARTS

- |                                |                              |
|--------------------------------|------------------------------|
| (1) AIRBOX ASSEMBLY            | (1) GROMMET                  |
| (1) BRACKET                    | (1) AIR FILTER AND CLAMP     |
| (1) LID                        | (1) INTAKE TUBE              |
| (2) PEG                        | (1) COUPLER                  |
| (5) M4 FLAT WASHER             | (2) 80-100MM WORM GEAR CLAMP |
| (7) LOCK WASHER                |                              |
| (5) M4X10MM BUTTON HEAD BOLT   |                              |
| (2) M4 X 25MM SOCKET HEAD BOLT |                              |

## REQUIRED TOOLS

- 1/4"-DRIVE RATCHET AND EXTENSION
- 7MM & 8MM SOCKETS OR FLAT HEAD SCREWDRIVER
- 2.5MM AND 3MM ALLEN KEYS
- POP CLIP TOOL, PICK TOOL, OR SMALL FLAT HEAD SCREWDRIVER

## INSTALLATION INSTRUCTIONS

**01.** Remove 1x pop clip, and remove the stock plastic fresh air duct

from the airbox by pulling it forward to disengage the barbs.



**02.** Remove the 8mm bolt holding the stock airbox to the fender frame.



**03.** Loosen the worm gear clamp securing the flexible part of the stock intake tube to the plastic section. Unlock the vacuum line fitting by lifting the tabs up and pushing them back. Next, lift the vacuum line up and out of the way.

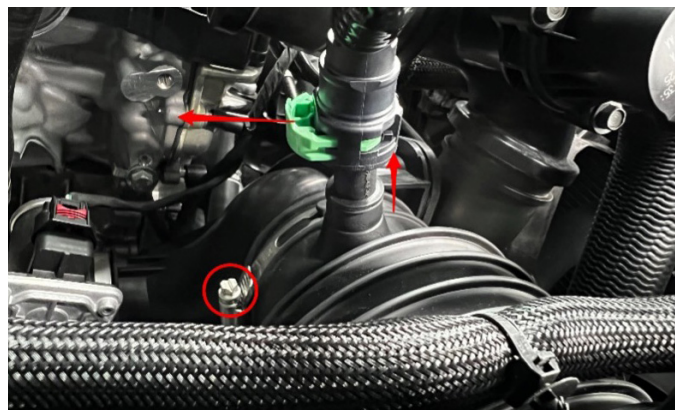

Continued on next page

**04.** Unplug the IAT sensor and disengage the tree clip holding the harness to the stock airbox.

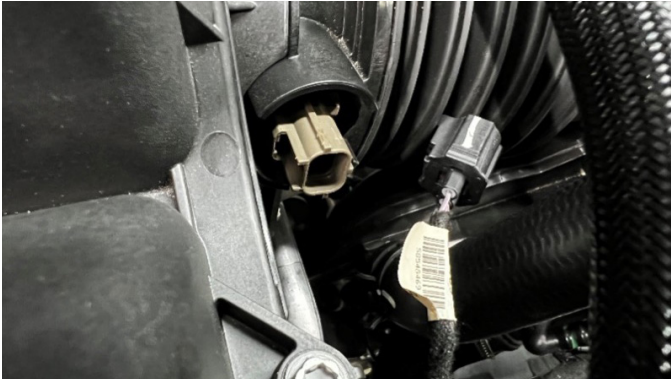

**05.** Disengage the tree clip holding the coolant line from the stock airbox.



**06.** Pull back the flexible part of the stock intake tube from the plastic section, then lift the airbox assembly straight up to disengage the rubber grommets.

**07.** Remove the stock intake from the engine bay.

**08.** Install the Mishimoto intake coupler with 2x worm gear clamps. Leave the clamps loose. Note that the smaller end goes on the plastic intake pipe section.



**09.** Assemble the Mishimoto intake as shown. Fasten the bracket and CNC pegs to the airbox with the provided hardware, then install the rubber grommet and air filter to the rotomold tube. Push the rubber grommet all around until the barb fully engages with the airbox opening.

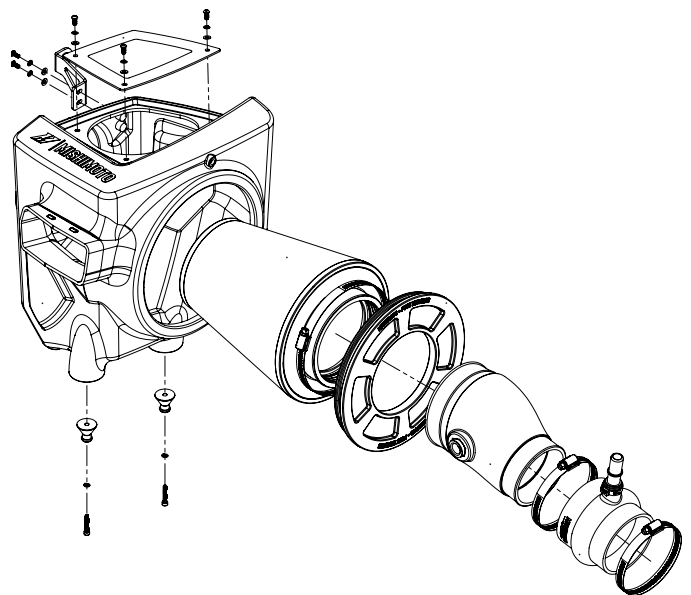

Continued on next page





10. Remove the IAT sensor and the rubber grommet with a metal insert from the stock intake, then transfer it to the Mishimoto intake tube and airbox bracket. Next, line up the intake tube with the silicone coupler and lower the Mishimoto intake assembly into the engine bay. Push down on the airbox to engage the metal pegs with the rubber grommets.



11. Reinstall the stock fresh air duct and fasten it with the pop clip. Secure the coolant line tree clip to the Mishimoto airbox as shown.

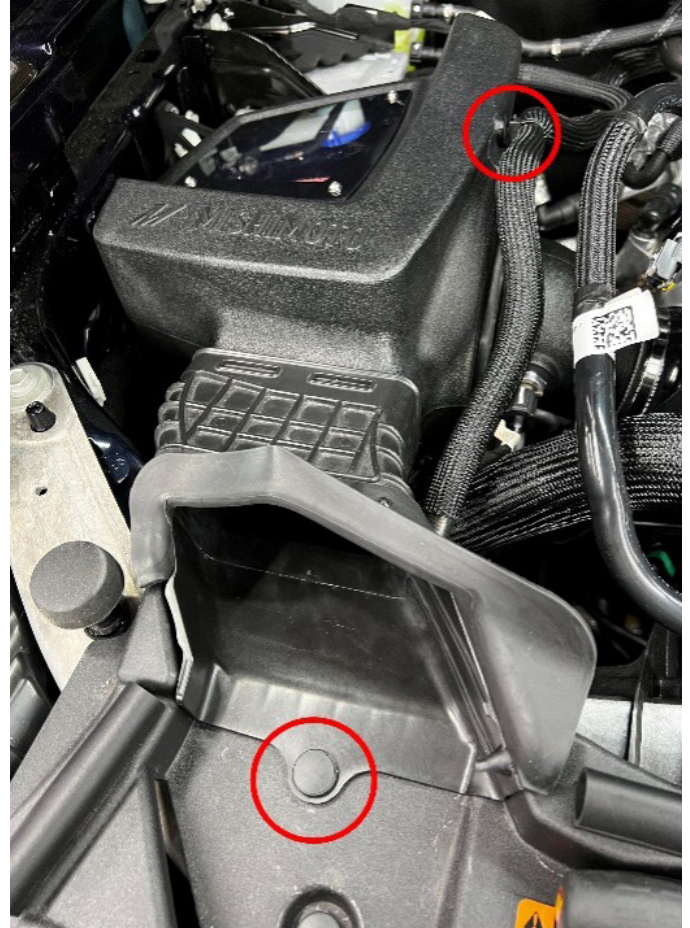

12. Reverse steps 2 and 3 to secure the Mishimoto airbox to the fender frame and reconnect the vacuum line fitting.

13. Rotate the silicone coupler to the best angle for the hard vacuum line then tighten the worm gear clamps.

**Congratulations! You have completed your installation.**

## DISPOSAL INSTRUCTIONS

- › Do not dispose of any product as unsorted municipal waste. Use separate collection facilities. Contact your local authority for information regarding the collection systems available.
- › Never improperly dispose of any coolant, oil, or other chemicals.

## WARRANTY INFORMATION



- › All claims must be accompanied with a picture of the Mishimoto product showing the issue for which the claim is being submitted.
- › Mishimoto asks that the customer inspect their purchased item for any damage immediately upon arrival.
- › Any product deemed dead on arrival (DOA) must be claimed within 14 business days of delivery. Claims outside of this time frame will not be covered under the Mishimoto Lifetime Warranty.
- › This warranty does not include payment and/or reimbursement of the cost of labor in connection with the removal of any product returned pursuant to the warranty policy or in connection with the installation of any replacement items provided under the warranty policy.
- › Mishimoto has the right to refuse a claim at any time.

- › When Mishimoto accepts a claim, Mishimoto retains full discretion to choose if it will: (i) repair or replace purchaser's original Mishimoto product; (ii) replace purchaser's original Mishimoto product with the most current available model; or (iii) provide the purchaser with a gift card redeemable on [Mishimoto.com](https://www.mishimoto.com) in the amount of the original purchase price of the original Mishimoto product. The provision of a replacement of a Mishimoto product is subject to availability and Mishimoto retains the right to substitute any warranty claim item with a comparable item or credit at any time.
- › If Mishimoto determines that it will provide a replacement item in connection with a claim under this warranty policy, and such item is out of stock, Mishimoto will place the customer on backorder and ship the replacement product to the purchaser once it becomes available.
- › Mishimoto is not liable for incorrect shipments in connection with a claim if a claim form is completed incorrectly, or if a model number is not included in a claim.
- › If you have a vehicle equipped with an automatic transmission, please make sure to specify this within the text box on the claim form. Mishimoto is not responsible for incorrect replacement shipments if transmission type is not indicated.



**WARNING**  
Cancer and  
Reproductive Harm  
[www.P65Warnings.ca.gov](https://www.P65Warnings.ca.gov)

This product can expose you to chemicals which are known to the state of California to cause cancer. For more information visit: [www.p65warnings.ca.gov](https://www.p65warnings.ca.gov)