



LS-1 OIL PUMP

Part 1 Relief Valve Spring Instructions

This pump is supplied with a High Pressure Relief Spring. If a lower pressure is desired, remove the red relief spring and replace it with enclosed blue spring.
Torque Valve Plug to 12Nm (106 inch lbs) min.

Note: Changing the relief spring will not change the idle pressure.

Part 2 O-Ring Instructions

This oil pump uses two different o-rings depending on the design of the pickup tube that installs to the pump. If the tube looks like (Fig 1) use the green O-ring. If the tube looks like (Fig 2) use the black O-ring.

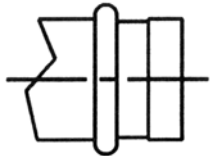

FIG 1

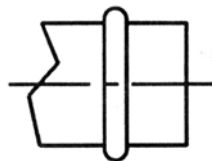

FIG 2

For Technical Assistance, Call Moroso's Tech Line at (203) 458-0542, 8:30am – 5:00pm Eastern Time

MOROSO PERFORMANCE PRODUCTS, INC
80 CARTER DR • GUILFORD, CT 06437
Phone: (203) 453-6571 • Fax: (203) 453-6906



LS-1 OIL PUMP

Part 1 Relief Valve Spring Instructions

This pump is supplied with a High Pressure Relief Spring. If a lower pressure is desired, remove the red relief spring and replace it with enclosed blue spring.
Torque Valve Plug to 12Nm (106 inch lbs) min.

Note: Changing the relief spring will not change the idle pressure.

Part 2 O-Ring Instructions

This oil pump uses two different o-rings depending on the design of the pickup tube that installs to the pump. If the tube looks like (Fig 1) use the green O-ring. If the tube looks like (Fig 2) use the black O-ring.

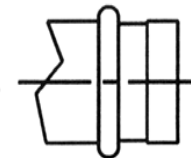

FIG 1

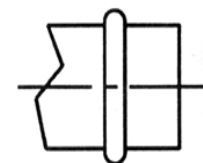

FIG 2

For Technical Assistance, Call Moroso's Tech Line at (203) 458-0542, 8:30am – 5:00pm Eastern Time

MOROSO PERFORMANCE PRODUCTS, INC
80 CARTER DR • GUILFORD, CT 06437
Phone: (203) 453-6571 • Fax: (203) 453-6906