

48" & 60" Freedom Blade Tailgate Light Bar Installation Instructions

Congratulations on your purchase of a high quality PUTCO product. Should you need any application or technical assistance, feel free to call us at: 1-800-247-3974
Monday-Friday 8:00 a.m. - 5:00 p.m. (Central Standard Time)
Contact your PUTCO dealer for other quality accessories.

Please read all instructions before installation and to check to see that all parts are included.

KIT CONTENTS:	
DESCRIPTION	QTY
Blade Quick Connect Harness	1
LED Driver Box	1
LED Light Bar	1
Power Wire	1
Black Plastic Bracket	4
3M Tape Strips	4
Cable Ties	20
Heat Shrink Tube	1

Tools Required:

At Least 90% Isopropyl Alcohol
Clean Towel
Heat gun or Lighter

You can find a full installation video on our YouTube page!



<https://youtu.be/haFCxPwM-nA>

Tailgate Light Bar Installation

1. Verify the kit contents above. Remove any protective wrapping.
2. Clean and dry the vehicle thoroughly in location where light bar is to be installed.
3. The vehicle surface temperature must be a minimum of 15°C (60°F).
4. Check the following before determining position:
 - i. Will the tailgate interfere with the light bar when opened? If it does, the light bar will need to be repositioned.
 - ii. Is the tailgate light bar visible from the rear when tailgate is closed?

Note: Tailgate light bar is easier to install if tailgate is removed.

Light Bar Clip Installation

1. Install 3M tape on back of black plastic brackets. Brackets are more useful if there are any obstructions on truck where light is to be installed. Brackets will hold light bar away from truck.
Refer to **Figure 1**.



Figure 1

2. Use at least 90% Isopropyl Alcohol to prep surface on vehicle where light bar is going to be installed.
3. Install black plastic brackets with tape onto the back of tailgate light bar. One on each end, then evenly space out the middle two.
4. Remove tape release liner on all brackets. Place light bar in chosen position on the bed of truck. Do not stick tape to truck until light bar is in correct position. **Light bar wire should exit toward driver side of truck. Refer to Figure 2**



Figure 2

Note: (Optional) Brackets may also be mounted with nuts and bolts (not included) by drilling into the truck. Use a #10 nut and bolt to attach to truck. The brackets will need to be attached to truck before light bar is installed.

Blade Quick Connect Harness Installation



1. The factory wire harness is located behind the rear bumper, near the spare tire, frame rails, and exhaust.



2. Disconnect the black plug shown in **Figure 3** (passenger's side pictured).

3. **IMPORTANT!** Make sure to plug each end of the quick connect harness into the appropriate side of the vehicle. The passenger and drivers side halves of the harness are labelled with a silver sticker.



4. Repeat this process on the driver's side of the truck. Feed the 4-pin connector back behind the bumper on the driver's side.

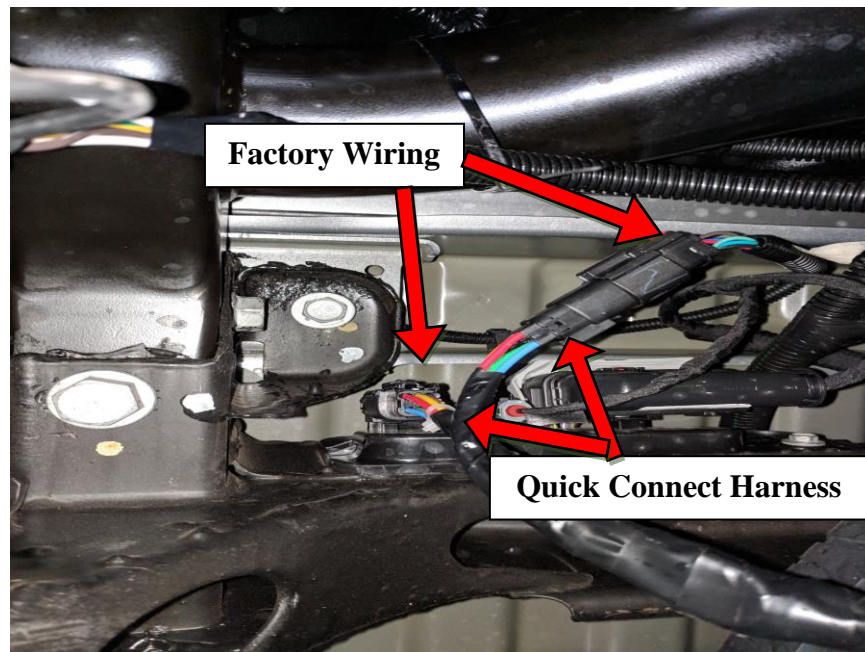

Power Wire Installation

The power wire is a separate wire designed to power the freedom blade from the fuse box. This allows for maximum punch from the LED's. The power wire is packaged as a separate cable to allow easier wiring to the rear of the truck. The power wire gets plugged into your fuse box using an add-a-fuse style connector to pull power from the truck without having to splice or terminate wires.

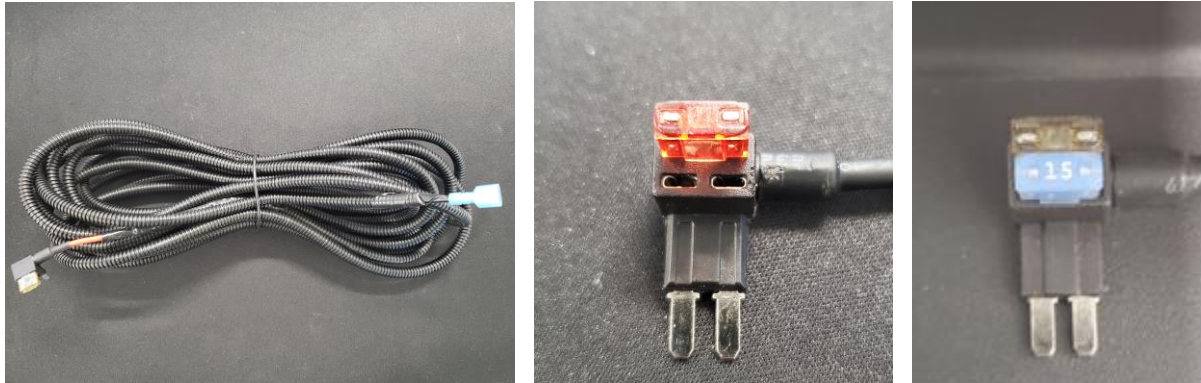

1. Connect the end of the power wire that has the fuse connector on one end into the correct fuse location for your truck. We recommend using your truck's accessory, ignition or interior fuse. Please see your trucks user manual for correct fuse location. **This fuse needs to be on a circuit that turns on with truck ignition.** If the fuse you select is always on, the Freedom Blade will slowly drain your battery. Place the fuse that was in the fuse box into the open slot on the connector.
2. Carefully fish the bundle of wire down through the engine bay and away from any components that get hot or move such as the engine block and exhaust.
3. From underneath your truck, grab the power wire bundle and route it to the back of your truck directly behind the bumper.
4. A supplied cable tie should be used to attach the power wire to the frame of the truck every 12-18 inches.

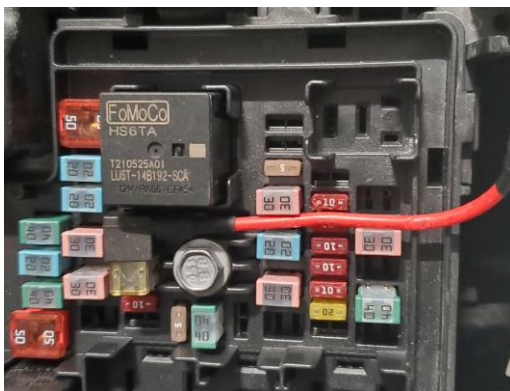

Mounting the Driver Box



The Freedom Blade driver box comes with two predrilled holes on a flange on each side of the driver box. This allows the driver box to be mounted in many different orientations and places behind the bumper of your truck. Try to use at least three of the four mounting holes to secure the driver box.

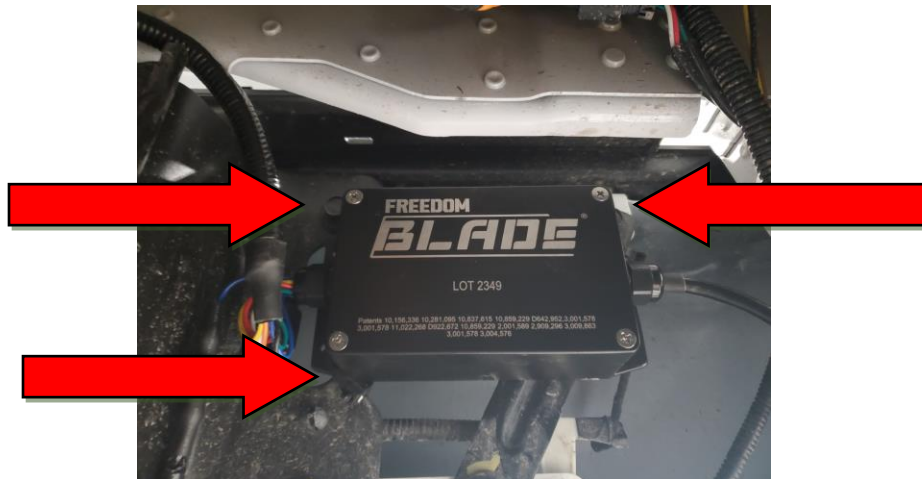

The Freedom Blade also comes with 3M automotive double sided sticky tape on the back of the driver box. If your truck has a suitable flat spot this can also be used for mounting. The 3M tape helps to reduce vibration.

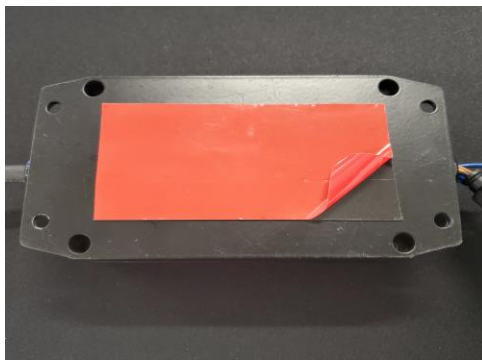

Connecting the Blade

Once the supplied harness has been connected to the truck and the power wire routed, you can connect the Freedom Blade driver box to the two harness.

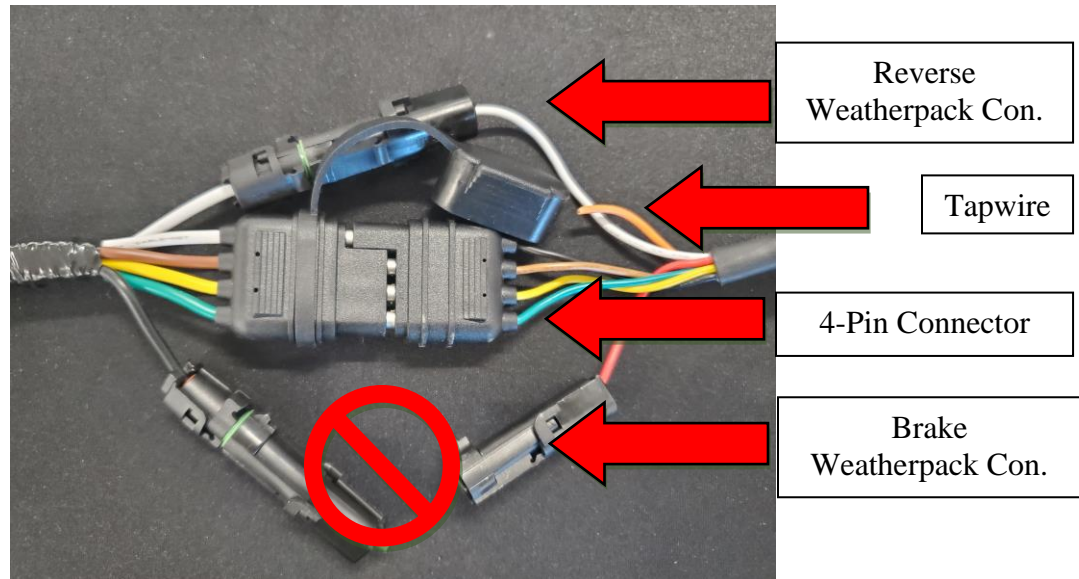

1. The Freedom Blade connects to the supplied harness using a 4-pin connector as well as one or two weatherpack connectors. Make sure the connectors are completely pushed together. Dielectric grease can be used. The weatherpack connector will click when properly connected. **DO NOT CONNECT the black weatherpack connector from the 04 harness to the red weatherpack from the Freedom Blade, your freedom Blade may work incorrectly.**

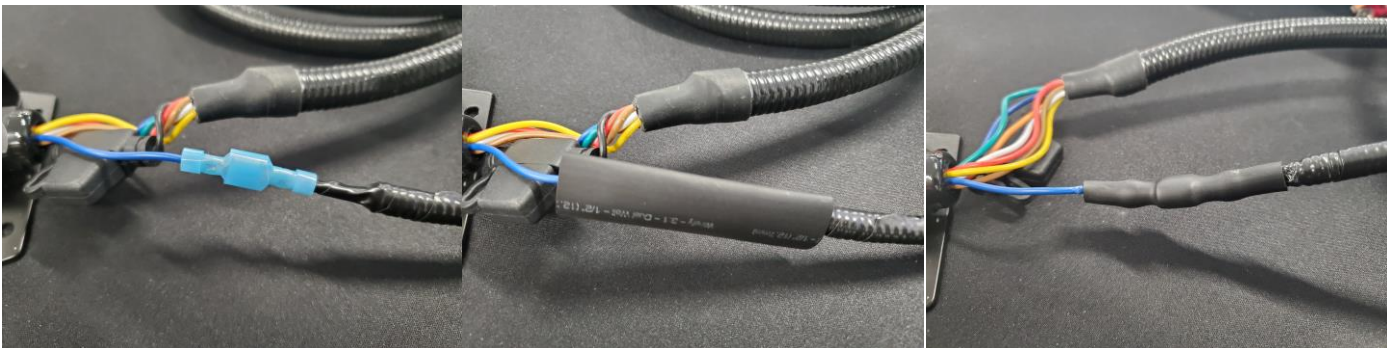

2. The power wire connects to the freedom blade using a spade terminal. Once connected, slide the supplied heat shrink over the connection and use a heat gun or lighter to shrink the heat shrink onto the connector. This heat shrink has adhesive on the inside which will create a permanent, water tight seal.
3. Make sure to bundle any extra length of wire harness tucked away and tightly bundled so it does not come loose when the truck is in motion.

Configuring the Freedom Blade

Start-Up Sequence	Turn Signal	Brake Style
Four White Bouncing Balls	Red Scanning	Standard
One Red Bouncing Ball	Amber Scanning	Triple-Pulse
White Breathing	Red Solid	
Red Heart Beat	Amber Solid	
White Light speed	Red Continuous	
White Balls Red Background	Amber Continuous	
Red and White Firework		

Configuration mode is a special mode which allows the user to select the turn signal style, brake style and the ending of the start-up sequence. This allows you the freedom to choose and personalize your freedom blade appearance between 84 different combinations. The signature white and green boot up sequence is not user adjustable.

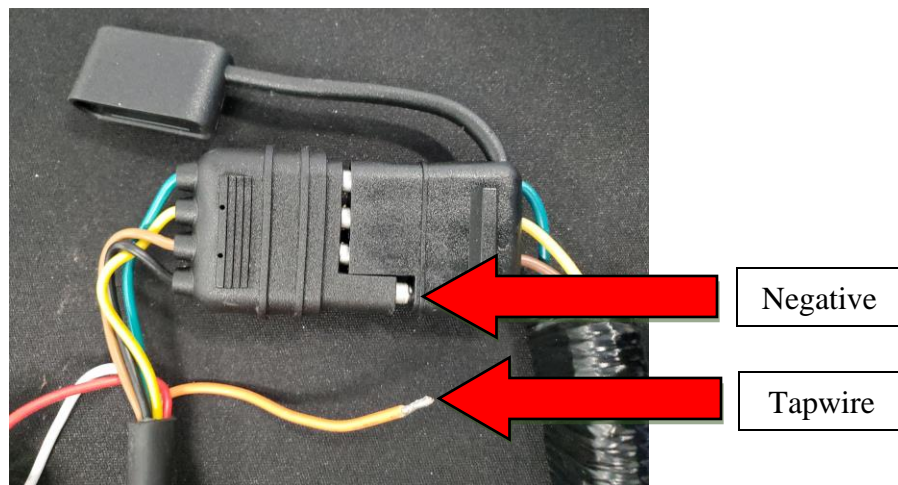

1. To access configuration mode, the user will need to momentarily touch the orange tapwire to a grounded surface of the truck or the negative of the 4-pin connector where the harness and the freedom blade driver connect.
2. When you enter the configuration mode, you will be shown the first start-up sequence. If you do not like this start up sequence touch the tapwire again, this will move to the second start up sequence. Once you get to the last selection, it will cycle back to the first selection. When you are happy with the startup sequence being shown, wait 5 seconds without touching the tapwire to ground. This will make your selection.
3. The configuration mode will now show you the first turn signal selection, touch the tapwire again to see the second turn signal selection. When you are happy with the turn signal displayed, wait 5 seconds and your preferred turn signal will be selected.

4. Lastly, the configuration mode will show you brake selections, standard brakes are shown first. If you touch the tapwire, the triple pulse brake will be shown. Triple pulse brake momentarily pulses the brake light to increase visibility and reduce rear end collisions. If you wait 5 seconds without touching the tapwire to ground, the freedom blade will record your selection and exit configuration mode. Your selections should now be saved going forward. This process can be repeated any anytime. You can also connect an optional Luminix remote and remote module to allow easy selection changes with the touch of a button.



Testing the Freedom Blade

1. Once your Freedom Blade is installed it is a good idea to test the functionality before driving.
2. With the help of an assistant, test the functionality of the Blade (brake, turn signals and reverse).
3. Enjoy!

For other quality lights and lighting accessories, visit
www.Putco.com