

PART# 540015
2015 Ford F150
Aggressor Cutout Pipe

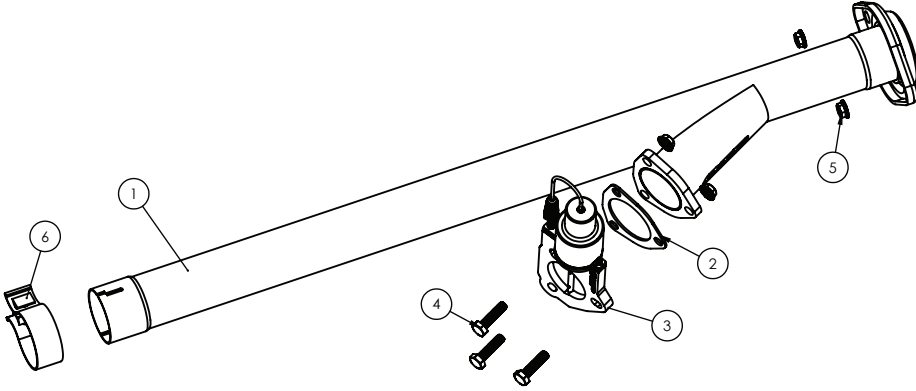

Caution! Never work on a hot exhaust system. Burns or other serious injuries can result. Always allow the exhaust system to cool before removal. Always consult vehicle manual for proper lifting and support guidelines. Always wear approved safety glasses when working. Serious injury or death can result if safety precautions are not followed.



ITEM NO.	DESCRIPTION	QTY.
1	AGGRESSOR ASSEMBLY	1
2	2.5" 3 BOLT GASKET	1
3	2.5" ELECTRIC CUTOUT	1
4	CUTOUT BOLT	3
5	CUTOUT NUT	5
6	2.5 TORCA ACCUSEAL CLAMP	1
7	2.5" CAP (NOT SHOWN)	1

Removal of factory equipment:

Step 1: Raise and support Vehicle. At the front of the factory resonator pipe, Remove the two bolts from the two bolt flange. See Image A. (save the bolts)

Step 2: At the other end of the factory resonator pipe loosen the factory accuseal clamp (See Image B). Push the muffler flex joint back and remove the resonator pipe.

Installation of new exhaust:

Step 3: Slide the Provided accuseal clamp over the end of the Aggressor Assembly, Align the two-bolt flange with the factory Y-pipe and loosely secure with the factory bolts and provided nuts. Do not fully tighten at this time

Step 4: Slide the factory muffler tube into the aggressor assembly and snug but do not fully tighten the accuseal clamp. Bolt the valve to the aggressor tube as shown using the supplied nuts, bolts, and gaskets. Rotate the entire assembly to the position shown and tighten the 2 bolt flange and accuseal clamp. (Image C)



Image A:



Image B



Image C

Proper Valve Position

Wiring the cutouts:

Installing the Toggle Switch

- Make sure that the vehicle battery has been disconnected.
- The switch should be located in a place that is easy to access such as a center console, kick panel, etc.
- Connect the RED wire to a 12 volt source.
- Connect the BLACK wire to a good ground.
- Drill a 1/2" hole where you wish to mount the switch.
- Remove the first lock ring from the shaft of the switch.
- Install switch in the hole you just drilled.
- Slide the lock ring over the switch and tighten ring so that there is no play in switch.

Routing the Wire Harness

- Make sure that you have the wire oriented so that the connectors mate. They are different, so make sure you pull the proper end into the vehicle.
- Route the wire up through the underside of the car. *Be careful to ensure that that the exhaust pipes or drive shaft do not interfere with the cable.
- Route the cables into the car. You can often open up a factory drain plug in the floor pan and snake the wire through.
- For manual transmission cars, you can also come up through the transmission shifter area. Remove the boot/seal of the transmission shifter.
- Plug the cable into the toggle switch, on the connector near the motor, align and press them together and then turn the coupling ring until it locks.

Maintenance

- We recommend lubricating the butterfly plate, Body and shaft using a quality lubricant such as "Liquid Wrench"(tm) from Gunk. This will help prevent Carbon build up naturally generated by the exhaust system and keep the butterfly sealing properly. This should be done on a monthly basis.
- For harsher climates, you should remove the cutouts and store them. Using the supplied block off plates will insure operation while cutouts are removed.
- Check screws every now and then to make sure they are tight. If not reapply a red thread locker and reinstall.

Note: After initial startup a small trace of smoke may be visible from the exhaust, do not be concerned. This is from residual oils left in the tube from the manufacturing process and will dissipate quickly.

Quick Time Performance recommends professional installation on all of our products.

Made in the USA