

PART# 740015
2015 Ford F150
Eliminator Exhaust System

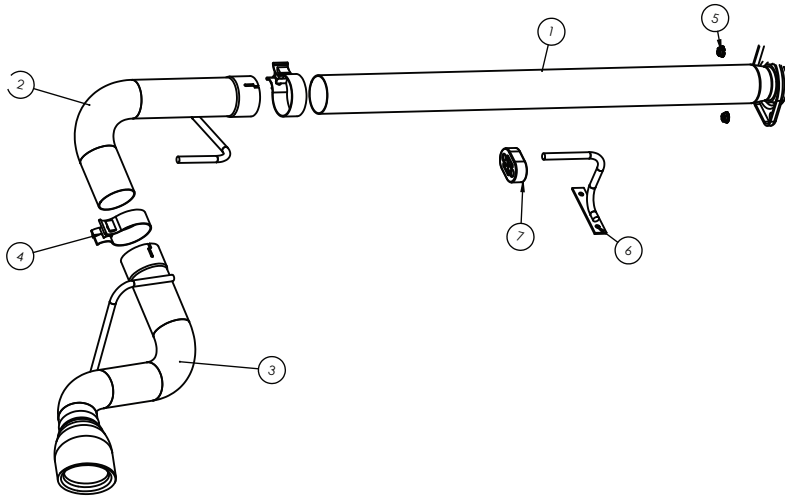

Caution! Never work on a hot exhaust system. Burns or other serious injuries can result. Always allow the exhaust system to cool before removal. Always consult vehicle manual for proper lifting and support guidelines. Always wear approved safety glasses when working. Serious injury or death can result if safety precautions are not followed.



ITEM NO.	DESCRIPTION	QTY.
1	FRONT TUBE ASSEMBLY	1
2	OUTLET TUBE ASSEMBLY	1
3	TIP ASSEMBLY	1
4	3.00 TORCA ACCUSEAL CLAMP	2
5	CUTOUT NUT	2
6	BOLT IN HANGER ASSEMBLY	1
7	EXHAUST ISOLATOR	1

Removal of factory equipment:

Step 1: Raise and support Vehicle. At the front of the factory resonator pipe, Remove the two bolts from the two bolt flange. See Image A. **(save the bolts)**

Step 2: At the other end of the factory resonator pipe loosen the factory accuseal clamp (See Image B). Push the muffler flex joint back and remove the resonator pipe.

Step 3: Spray the four factory hangers with a spray lubricant. Push the factory muffler and tailpipe towards the rear of the vehicle to free the hangers. Once off the hangers, remove the muffler/tailpipe assembly from the vehicle.

Installation of new exhaust:

Step 4: There are two hanger brackets bolted to the right side framerail, Unbolt the forward most bracket (Image C) and discard the bracket. **save the bolts.** Using a flat blade screwdriver remove the clip in nuts from the framerail and save (image D).

Step 5: Locate the holes on the outside edge of the right framerail just above the front leaf spring mount (image E). Install the clip in nuts from step 5 in this location (Image F). With the clip nuts in place secure supplied bolt in hanger assembly to the framerail using the bolts removed in step 4. Orient the bracket as shown in Image G.

Step 6: Loosely bolt the Front tube to the factory y-pipe using the factory bolts and supplied nuts. Do not tighten the flange at this time

Step 7: Place an accuseal clamp onto the outlet tube, then slide the outlet tube hanger into the factory rubber mount on the framerail. With the hanger in the factory mount, slip the outlet tube into the front tube.

Step 8: Place the final accuseal clamp onto the tip tube, slide the tip tube onto the outlet tube and slide the hanger into the provided rubber isolator. Slide the isolator onto the bolt in hanger that was mounted in step 5.

Step 8: Adjust and align the tip then tighten the 2 bolt flange, and band clamps working from front to back.



Image A:



Image B



Image C



Image D



Image E



Image F



Image G



Image H

Note: After initial startup a small trace of smoke may be visible from the exhaust, do not be concerned. This is from residual oils left in the tube from the manufacturing process and will dissipate quickly.

Quick Time Performance recommends professional installation on all of our products.

Made in the USA