

PROPRIETARY & CONFIDENTIAL: THE INFORMATION CONTAINED IN THIS DRAWING IS THE SOLE PROPERTY OF STAINLESS STEEL BRAKES CORP., ANY REPRODUCTION IN PART OR AS A WHOLE WITHOUT THE WRITTEN PERMISSION OF STAINLESS STEEL BRAKES CORP. IS PROHIBITED.

REVISIONS (- see archive folder for previous revisions not listed -)			
ECR/CA	REV	DESCRIPTION	mo/da/year
	-	INITIAL RELEASE	03/04/2019

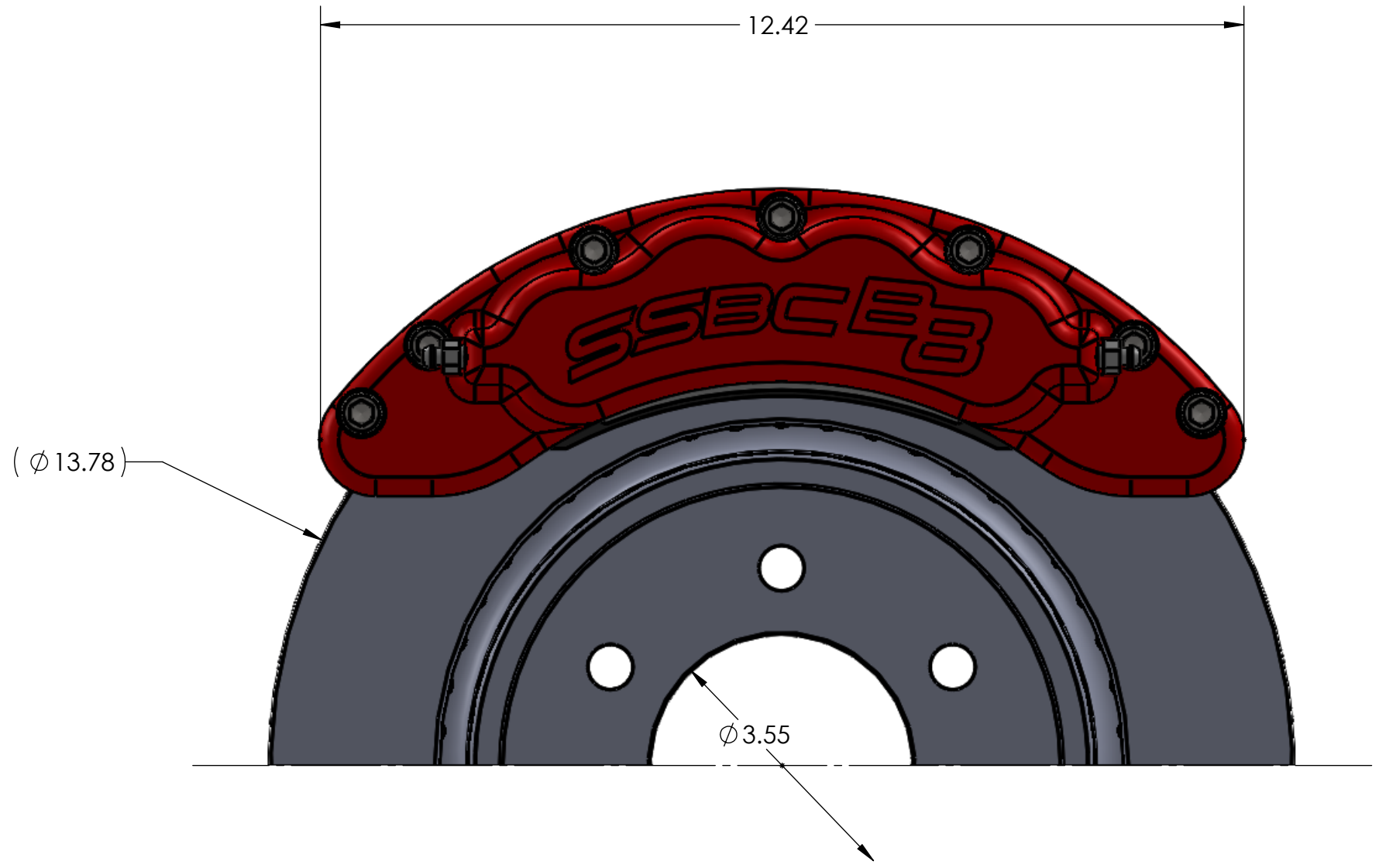
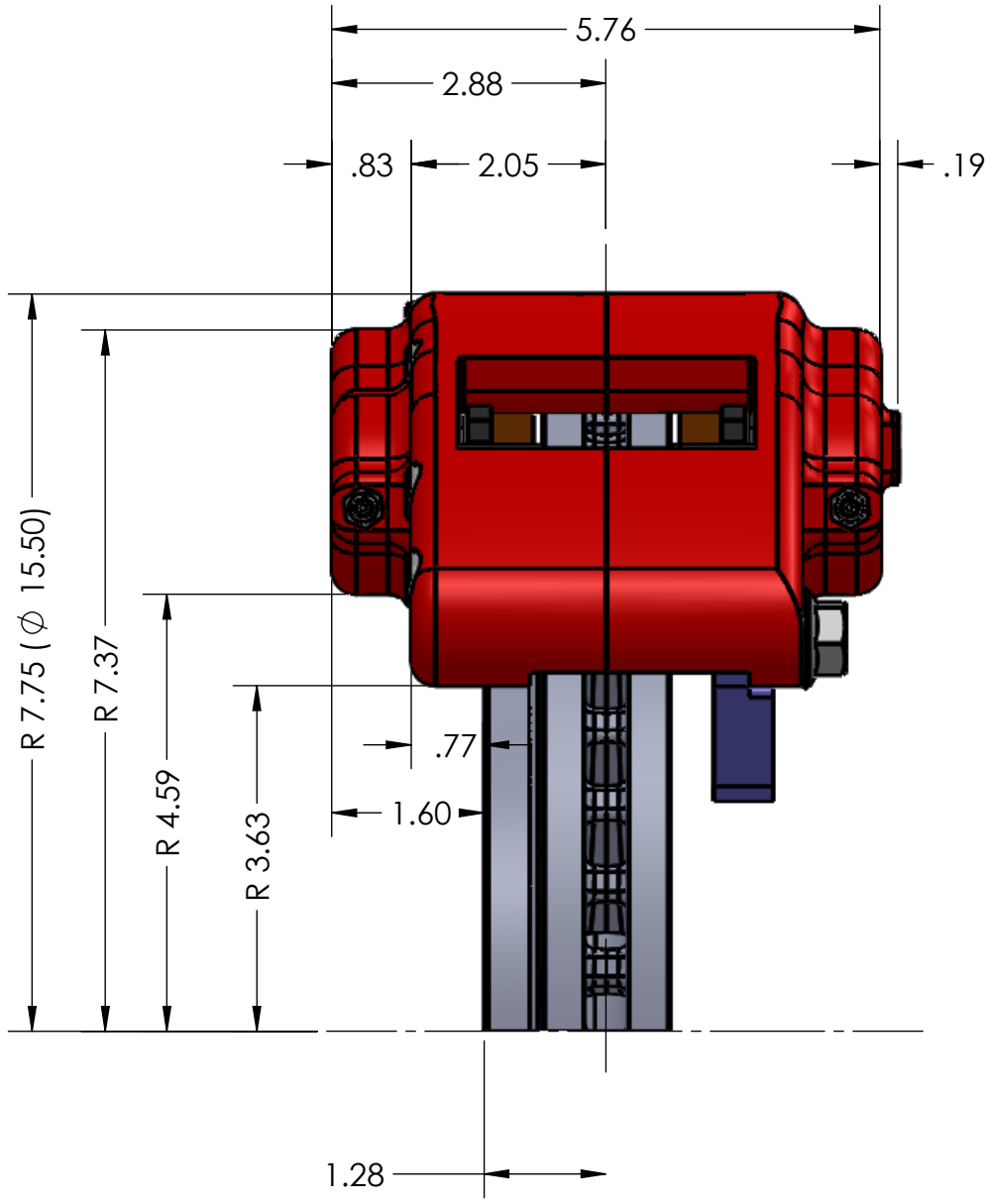

- NOTES:
1. ALL DIMENSIONS ARE MINIMUM.
 2. STOCK OE ROTOR SIZE.

GENERAL NOTES:
 UNLESS OTHERWISE SPECIFIED:
 1) DEBURR & BREAK ALL SHARP EDGES
 2) PARTS MUST BE IDENTIFIED BY THEIR PART# & REV.
 3) THREADED HOLES SHOULD NOT BE POWDER-COATED
 4) DIMENSIONS ARE IN INCHES [MM ARE IN BRACKETS]
 5) MACHINED SURFACE FINISH: $\sqrt{125}$

PART SPECIFIC NOTES:
 1) MAT'L SPEC:
 2) MAKE FROM:
 3) TREATMENT:
 4) FINISH:
 5)
 6)

PRODUCTION COPY	APPROVALS	 CLARENCE, NEW YORK 14031-1720 Ph: 716-759-8666 / 800-448-7722 - Fx: 716-759-8688 WWW.SSBRAKES.COM	PART No.	REV
	DRAWN BY D. LENHARR MARCH 04, 2019 REVIEWED BY			
SSBC SIZE-B (rev-e)	APPROVED BY	FITMENT FRONT F150 2012-2018	FT-CP1001	-
	ALL CRITICAL DIMENSIONS WILL BE CIRCLED UNLESS OTHERWISE SPECIFIED TOLERANCES: FRACTIONAL $\pm 1/64$ ANGULAR $\pm 1/2^\circ$ 2 PLACE DECIMAL $\pm .010$ [.254] 3 PLACE DECIMAL $\pm .005$ [.127]			