



Installation Instructions
Part numbers 15553/155536
2014 GM Silverado/ Sierra 5.3L
Customer service (909) 481-3888

Tools needed:

- 10mm, 5/16 Socket or Nutdriver**
- Flathead Screw Driver**
- Phillips Screw Driver**
- Bit Driver for supplied torx bit**



Item	Description	QTY
412117	Plastic air box	1
441284	Plastic air duct	1
460641	MAF adapter 6 x 4 Ribbed	1
43034-1	Aluminum air box lid	1
4220262	Inspection window for aluminum lid	1
562097	Lid gasket	1
59025122	¼ X 5/8 Rubber washers	4
5900	¼ -20 X .50' Truss head screw	4
59012210	6mm-16 Bolt	3
59020114	¼ Lock Washers	3
59020104	¼ X 5/8 Washers	3
59034121	5/8 NPT fitting straight	1
5119 or 61517	Pro5 or Donaldson PowerCore Filter	1
52064	#64 Clamps	3
52056	#56 Clamp	1
5619754	MAF sensor gasket	1
59051212	4mm X 10 Pan head screw	2
53005	5/8 X 15 Breather hose	1
53005 (2)	5/8 X 11.5 Breather hose	1
53310	4.00 X 3.5 Reducer	1
53206	4.00 Hump Hose	1
59034116	Clamp Double-Line for 5/8 line	1

Step 1.



Step 2.

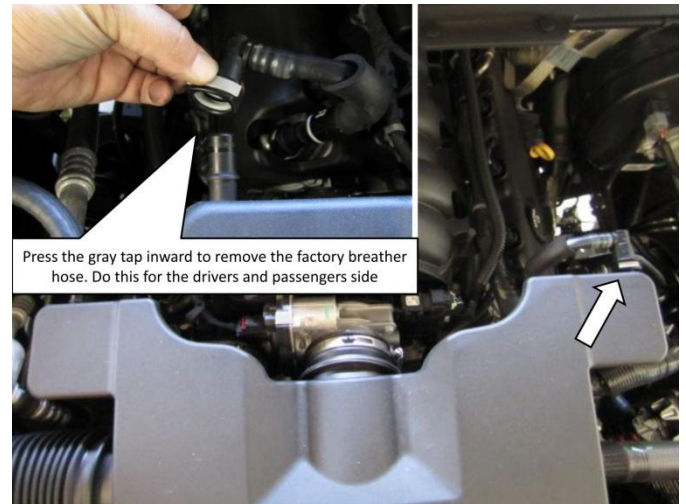

Step 3.



Step 4.

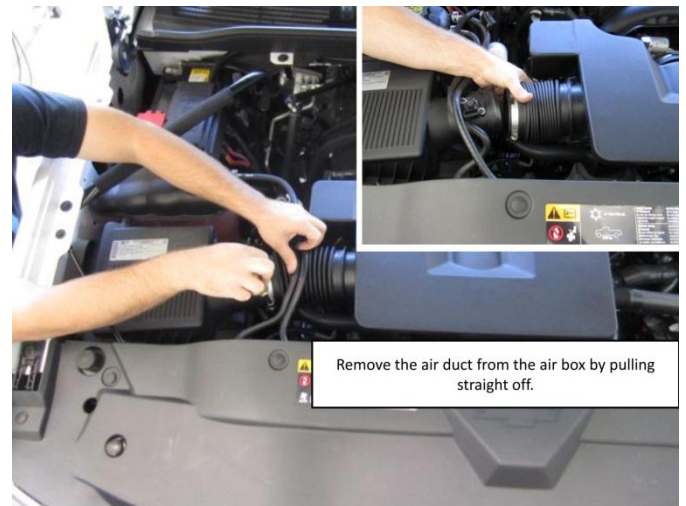

Step 5.



Step 6.

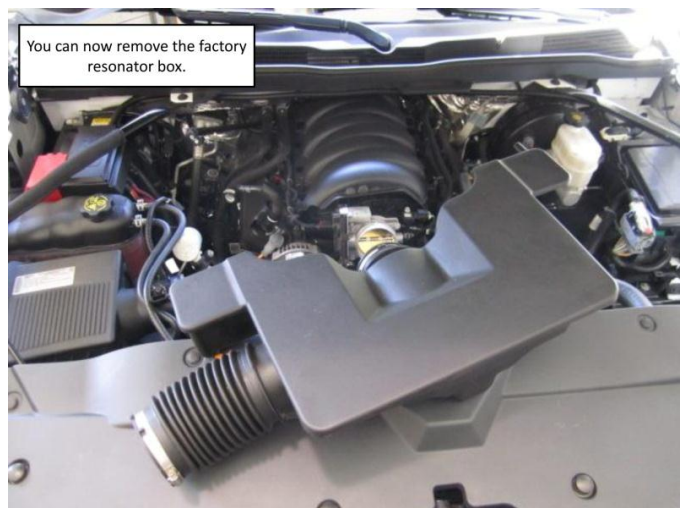

Step 7.

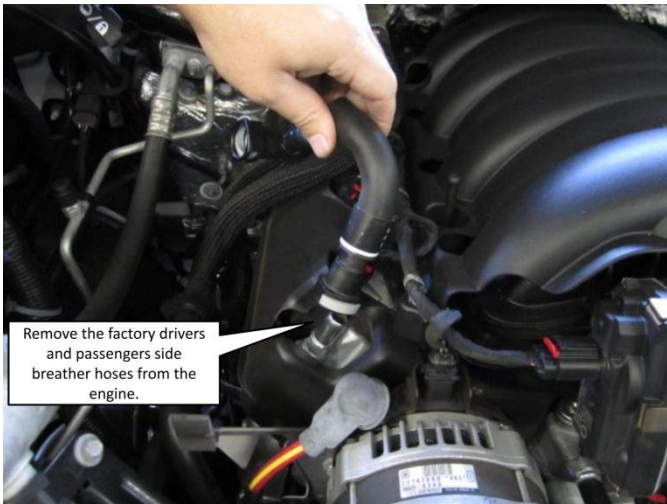

Step 8.



Step 9.



Step 10.

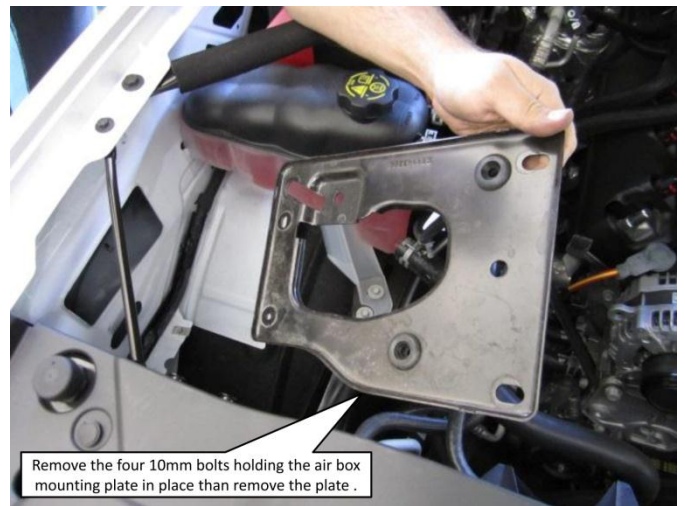

Step 11



Step 12.

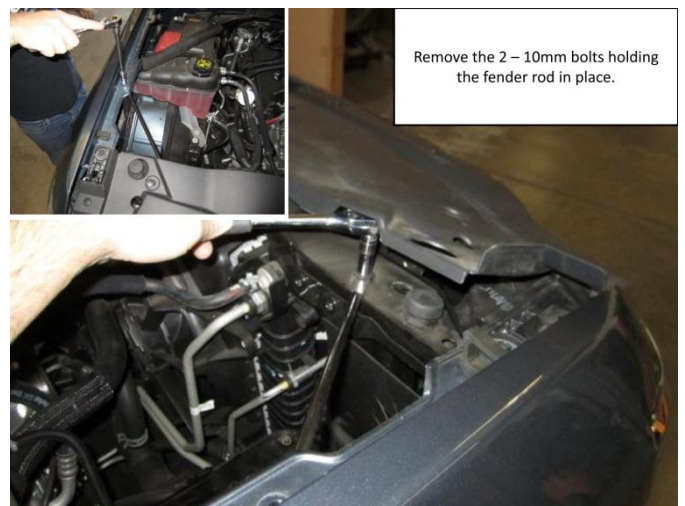

Step 13.



Step 14.

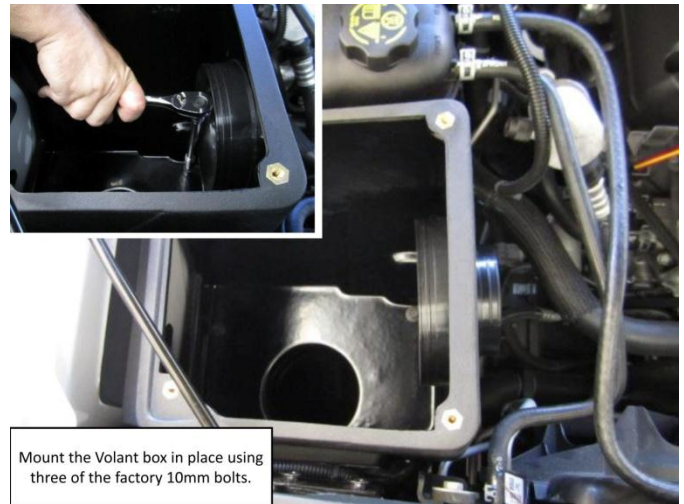

Step 15.

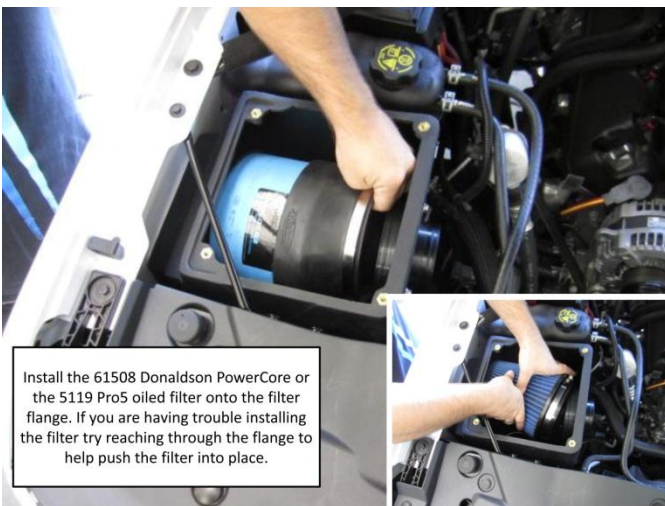

Step 16.

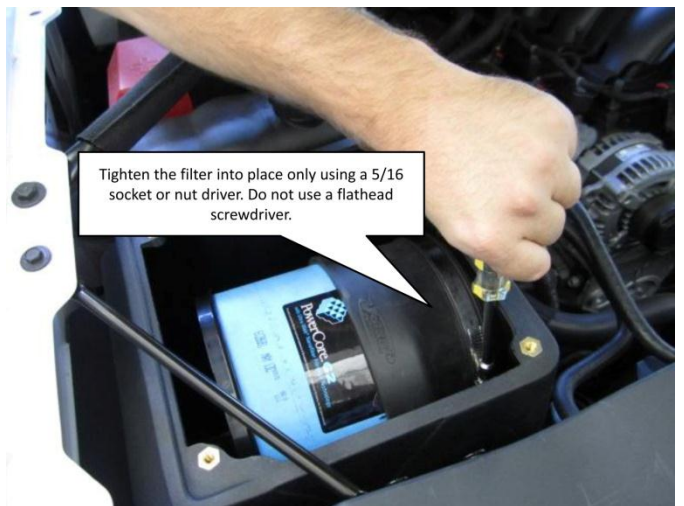

Step 17.

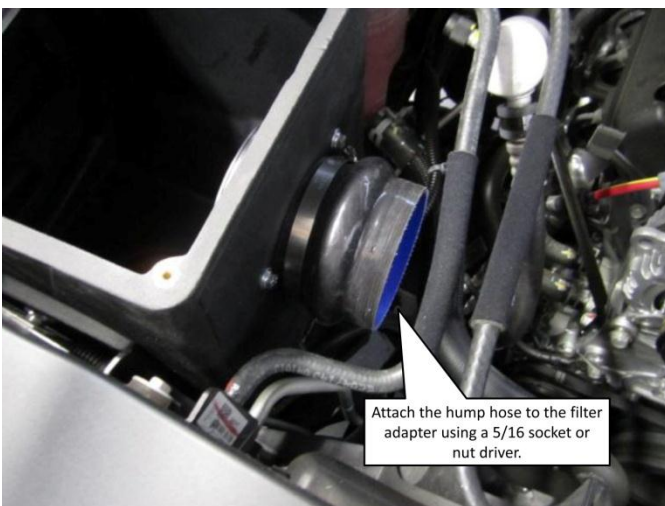

Step 18.

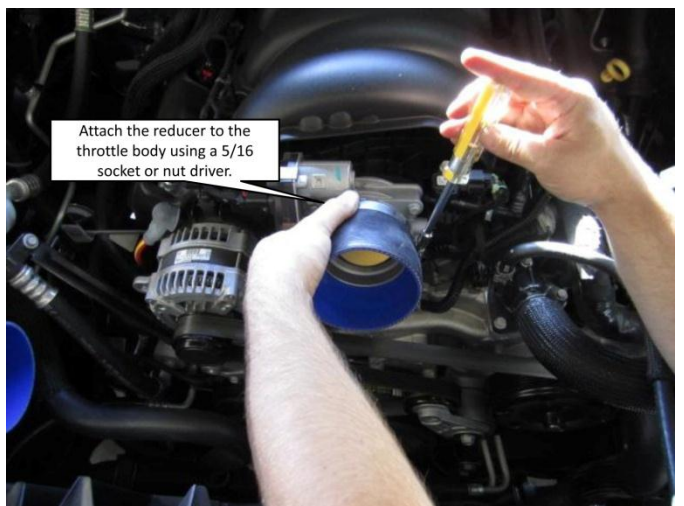

Step 19.

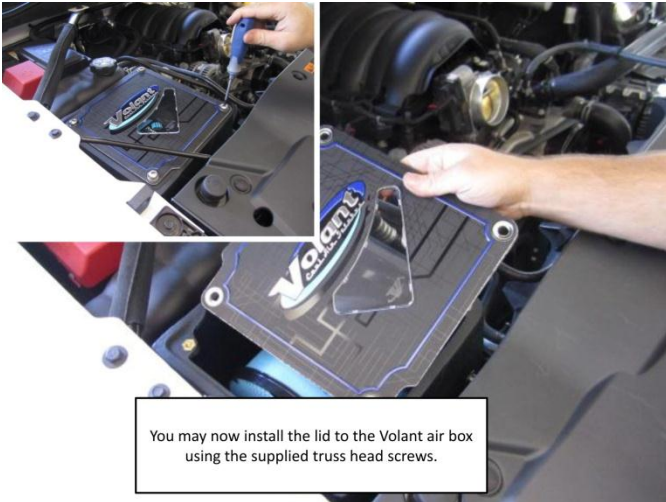

Step 20.

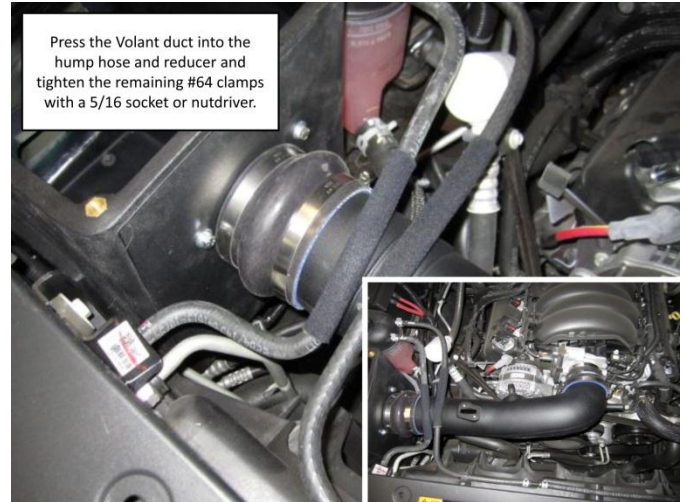

Step 21.

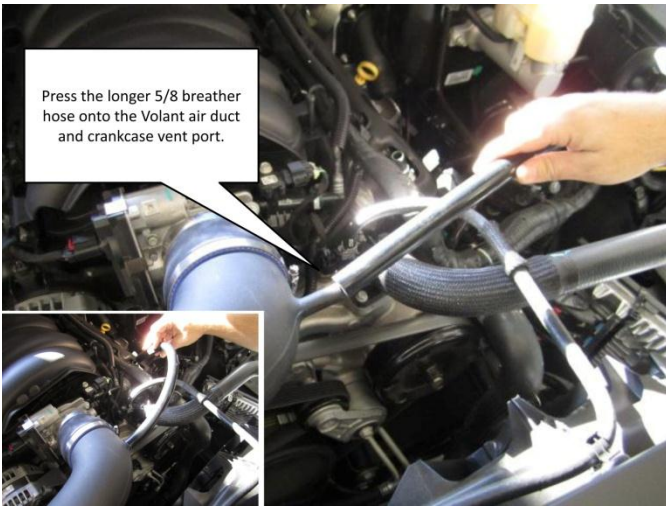

Step 22.



Step 23.

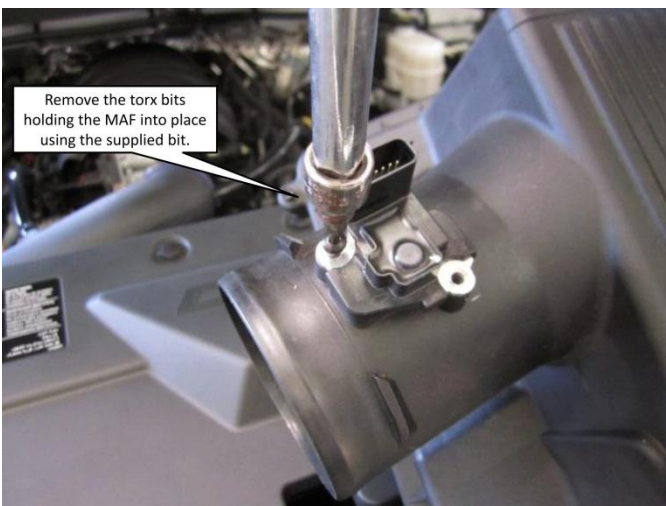

Step 24. *Use Caution! Do not touch MAF sensor elements. Keep Free of debris.



Step 25. *Use Caution! Do not touch MAF sensor elements. Keep Free of debris.



Step 26.



Step 27.

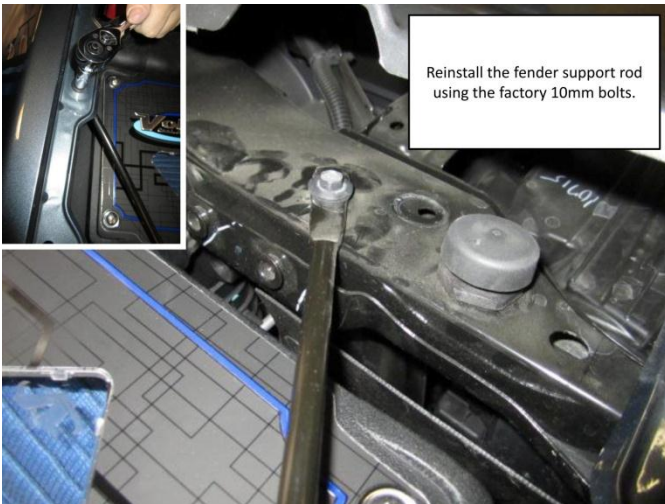

Step 28.



Step 29.



Step 30.

