



## Installation Instructions for K10471

### A/C Bracket for LS engines with F-body or GTO balancer

#### Kit contents:

- Mounting plates
- Spacer tubes
- Fasteners
- Idler pulley
- Tensioner

#### Additional parts required:

- Belt. See chart below.
- AC compressor, Sanden "508" style. Typical SD5 Sanden part number is 6629. However, we recommend the SD7 Sanden part number 4665 for smoother operation and less vibration.

Belt length and Gates PN - K10471 AC bracket - Camaro spacing				
Factory GM Alt/PS bracket and pulley	Kwik Performance Alt/PS bracket K10167			Kwik Performance alternator only bracket K10194
	6.7" diameter power steering pulley	6.0" diameter power steering pulley	5.5" diameter power steering pulley	
<b>99.5" K060988</b>	<b>98.13" K060975</b>	<b>97.13" K060966</b>	<b>96.88" K060962</b>	<b>91.25" K060908</b>

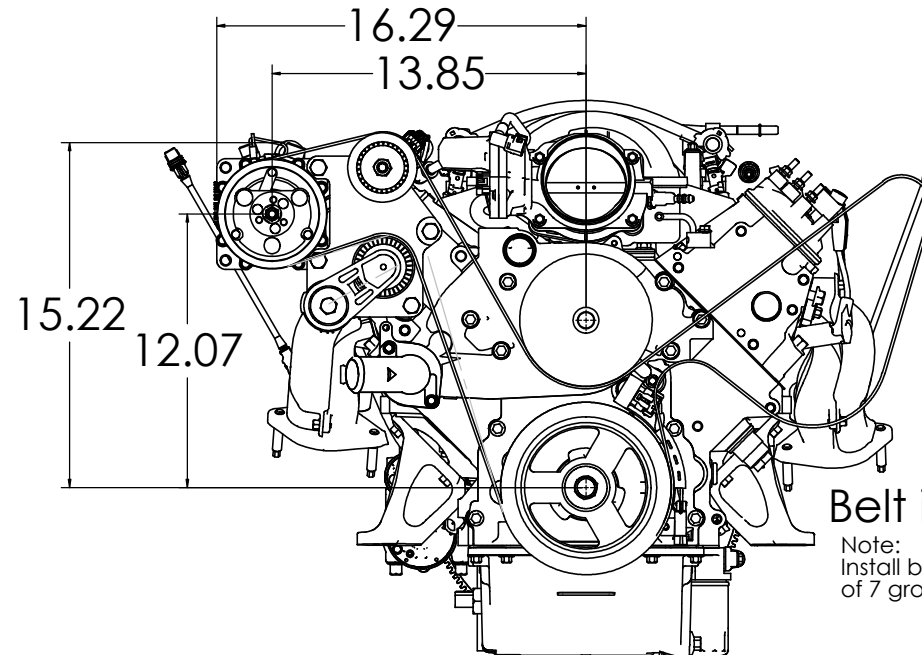

#### Belt installation

Note:  
Install belt in rear 6 grooves of 7 groove compressor.



# Installation Instructions for K10471

A/C Bracket for LS engines  
with F-body or GTO balancer

## 2. Install Water Pump Bolt

## 1. Install bracket

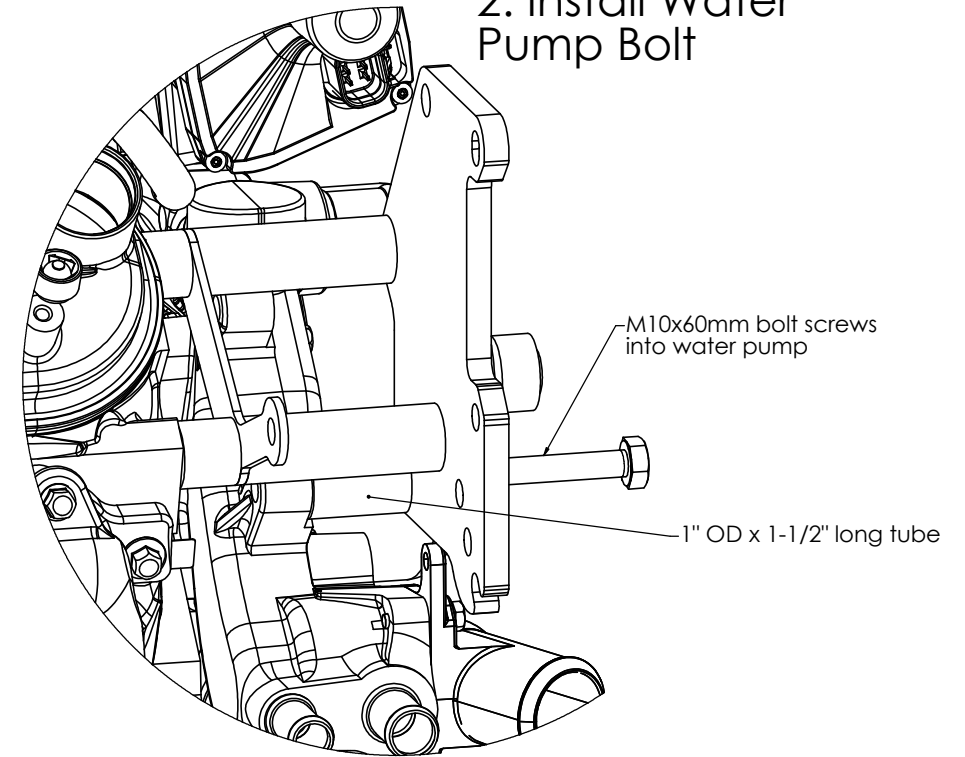
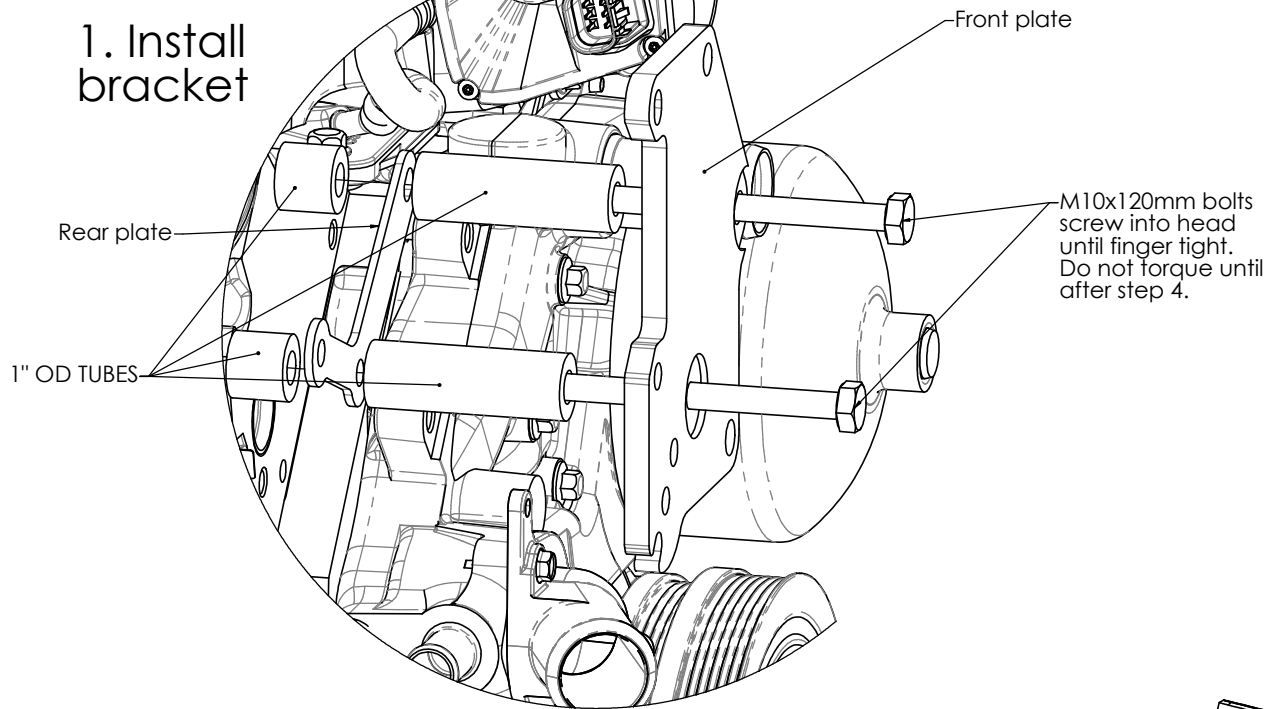

## 3. Install compressor

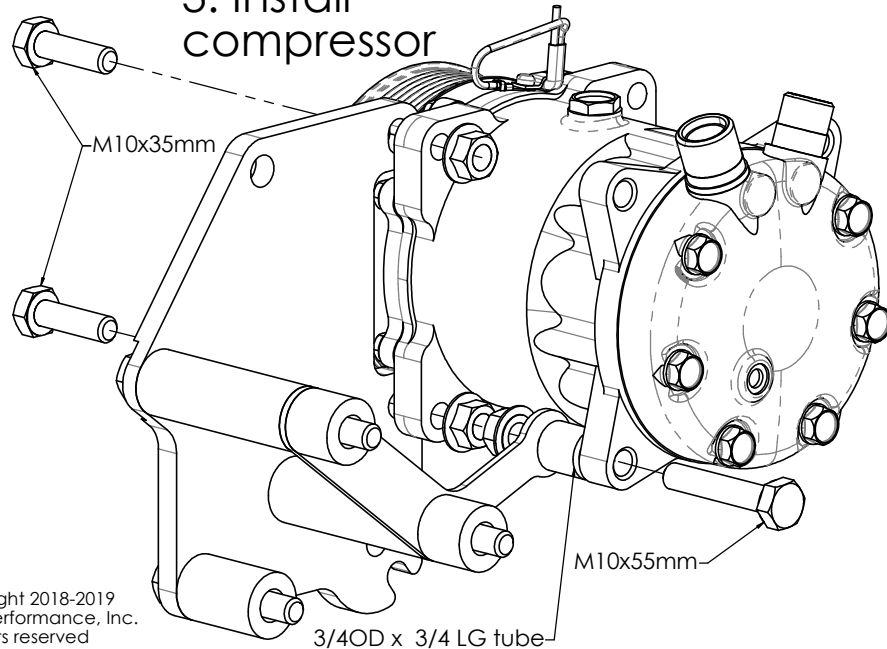

## 4. Install tensioner & idler pulley

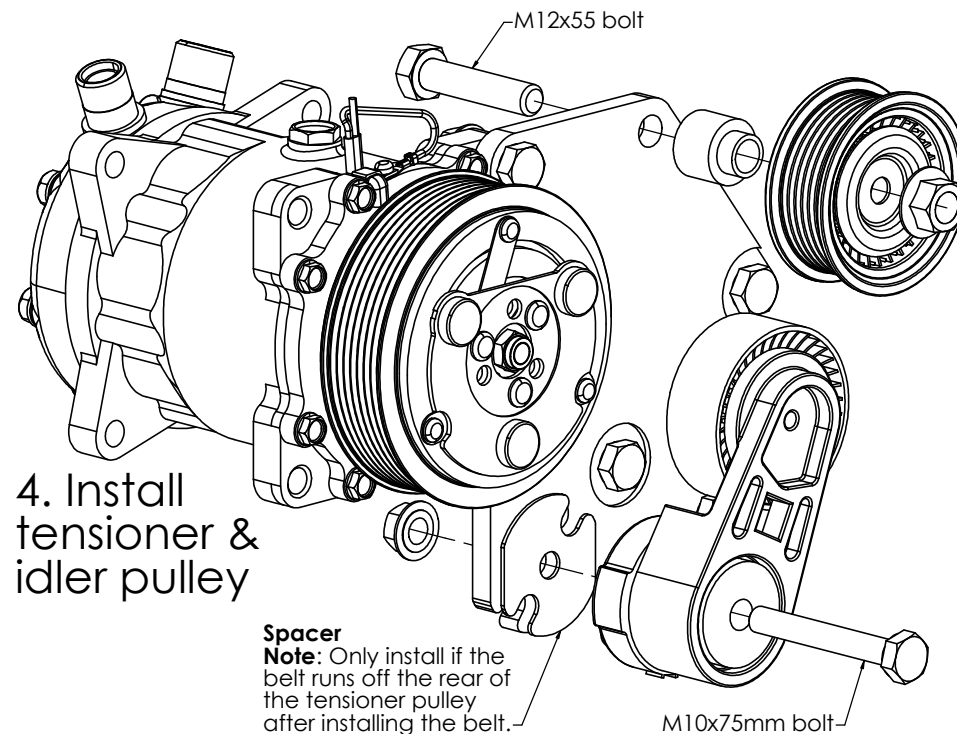

## 5. Tighten bolts.

Tighten 10mm fasteners to 37 ft-lbs (50 N-m),  
Tighten 12mm fasteners to 50 ft-lbs (68 N-m).