

INSTALLATION INSTRUCTIONS

HDX DROP NERF STEP BARS



APPLICATION:
2021 Ford Bronco
PART NUMBER:
56-14195, 56-141952, 56-14185

CONTENT			
ITEM	QUANTITY	DESCRIPTION	TOOLS NEEDED
1	1	DRIVER STEP BAR	10MM SOCKET
2	1	PASSENGER STEP BAR	10MM WRENCH
3	2	FRONT MOUNTING BRACKET	13MM SOCKET
4	2	CENTER MOUNTING BRACKET	16MM SOCKET
5	2	4-DOOR REAR MOUNTING BRACKET (56-14195, 56-141952)	RATCHET
6	2	2-DOOR REAR MOUNTING BRACKET (56-14185)	TORQUE WRENCH
7	12	M8 HEX HEAD CAP SCREW	
8	12	M8 SPLIT LOCK WASHER	
9	12	M8 FLAT WASHER	
10	12	M10 HEX HEAD CAP SCREW	
11	12	M10 SPLIT LOCK WASHER	
12	12	M10 FLAT WASHER	

ANTI-SEIZE LUBRICANT MUST BE USED ON ALL STAINLESS STEEL FASTENERS TO PREVENT THREAD DAMAGE AND GALLING

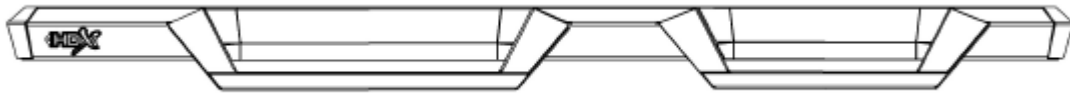

ITEM 1 (4-Door Application)

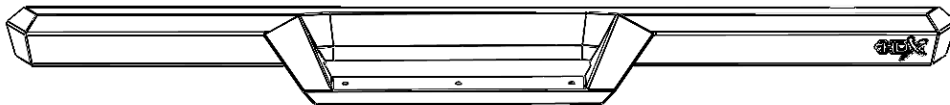

ITEM 1 (2-Door Application)

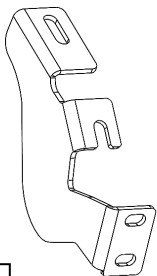

ITEM 3

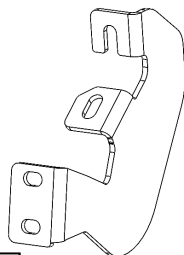

ITEM 4

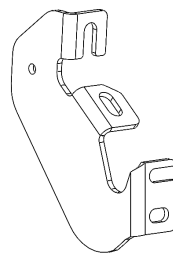

ITEM 5

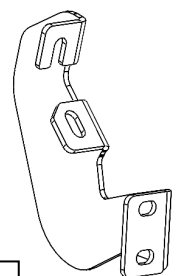

ITEM 6

PROCEDURE

1. Remove contents from box, verify if all parts listed are present and free from damage. Carefully read and understand all instructions before attempting installation.
Failure to identify damage before installation could lead to a rejection of any claim.
2. Beginning on the driver side of the vehicle, remove (2) M10 OEM bolts (or plastic plugs) from each mounting location on the rocker panel if they are present. See **Figure 1**. *Note: The 2-Door vehicle will only have two mounting locations, NOT three.*
3. If any OEM mounting plates are present, remove them by removing the M10 bolt using a 13MM socket. See **Figure 2** for reference.

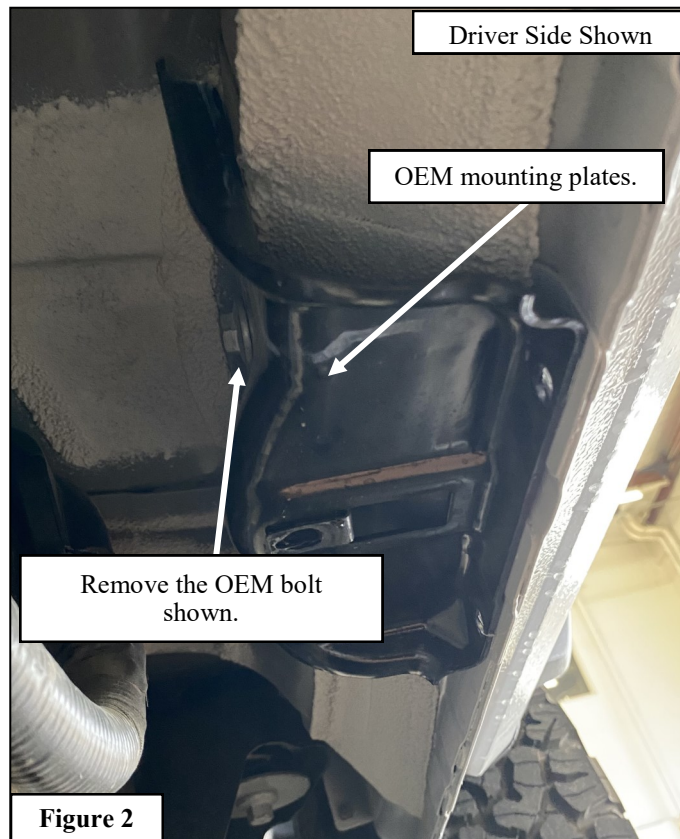
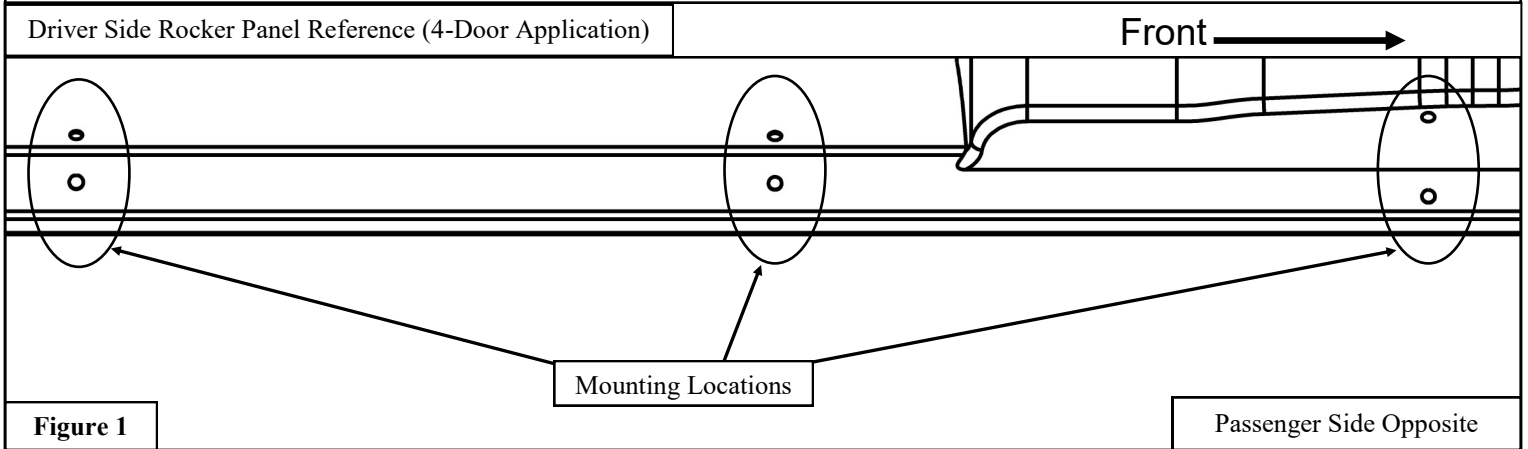

4. Loosely install the Front Mounting Bracket (Item 3) to the rocker panel using the supplied M10 hardware. See **Figure 3** for reference. Please refer to **Figures 7 through 10** for bracket orientation and location.

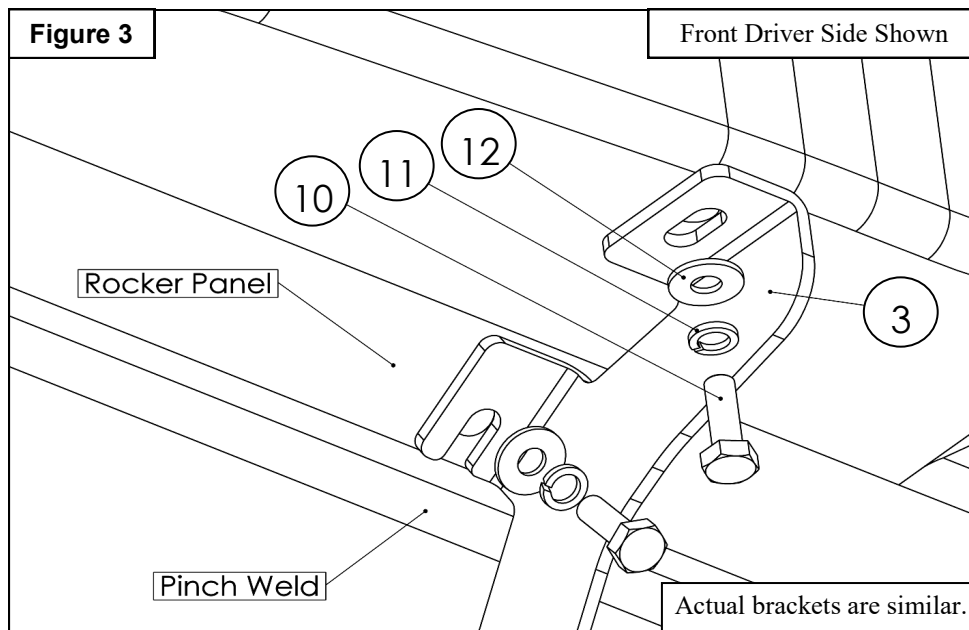

5. Loosely install the Center Mounting Bracket (Item 4) to the rocker panel on the 4-Door vehicle using the supplied M10 hardware. See **Figure 4** for reference. *Note: This step can be followed for the **Rear Mounting Bracket (Item 6)** on 2-Door vehicle application.*
6. Please refer to **Figures 7 through 10** for bracket orientation and location.

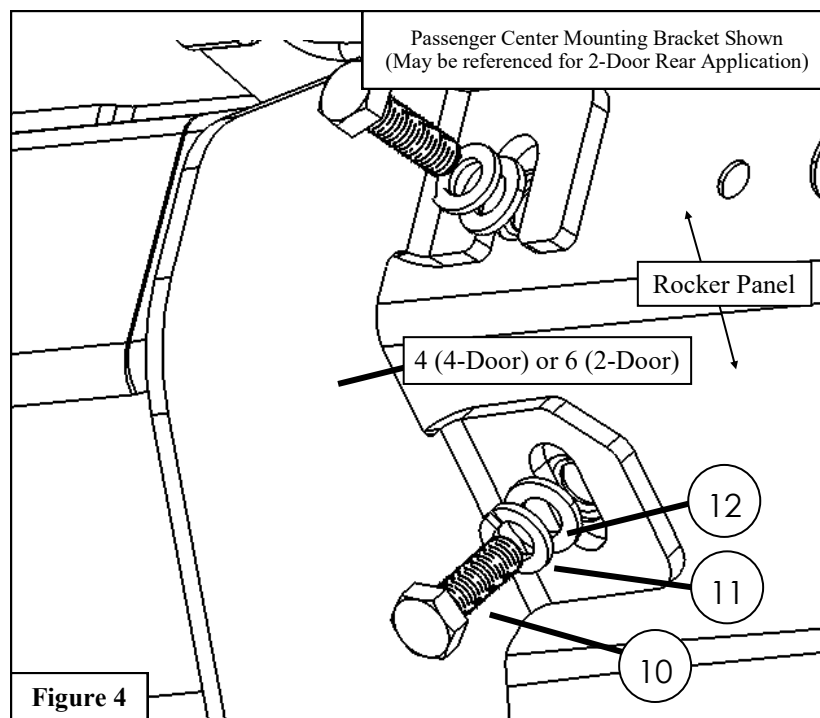

7. Loosely install Rear Mounting Bracket (Item 5) to the rocker panel using the supplied M10 hardware as shown in **Figure 5**. Please refer to **Figures 7 through 10** for bracket orientation and location.
8. Locate the Driver Step Bar Assembly (Item 1) and loosely secure it onto the previously installed mounting brackets using the provided M8 hardware. For the 4-Door application partially insert M8 Hardware into board and slide the slotted bracket onto the bolt. See **Figure 6** for reference.
9. Tighten the bolts as far as they can go while still leaving room for adjustment.

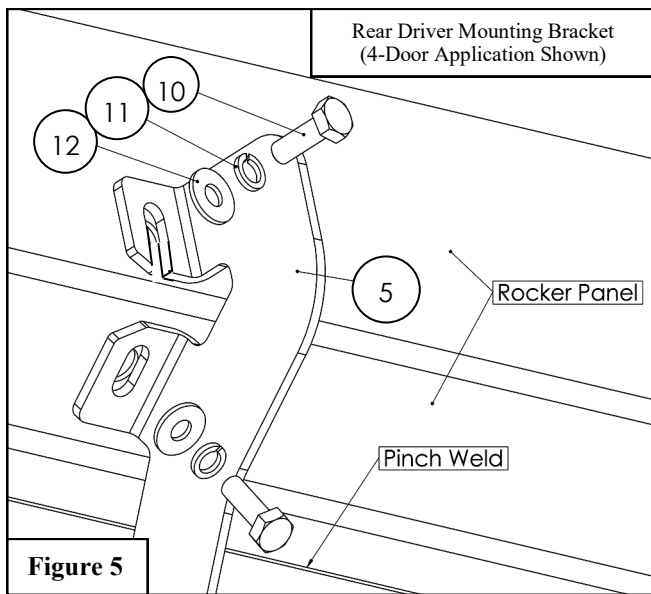

Figure 5

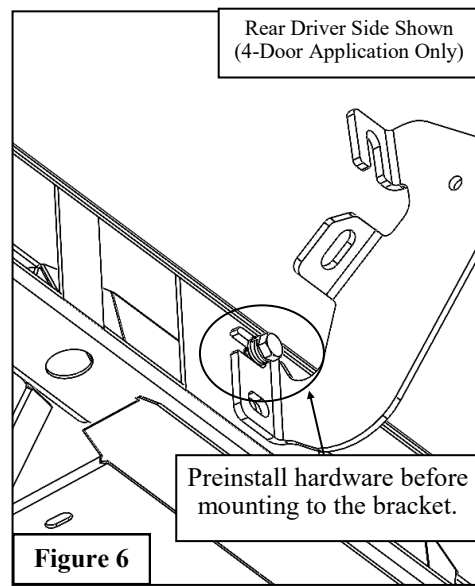

Figure 6

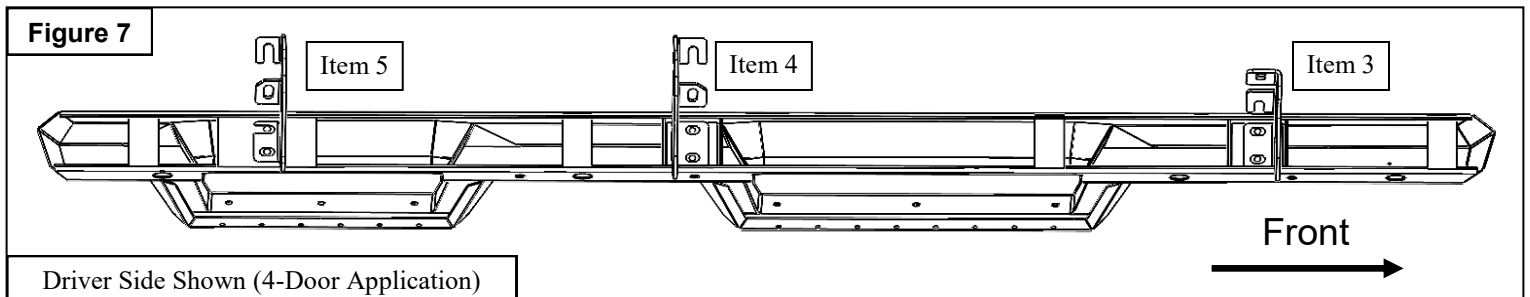

Figure 7

Driver Side Shown (4-Door Application)

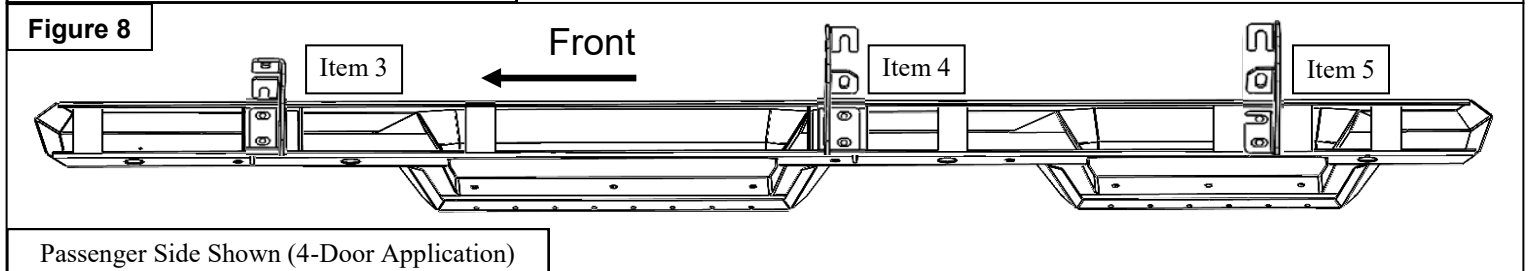

Figure 8

Passenger Side Shown (4-Door Application)

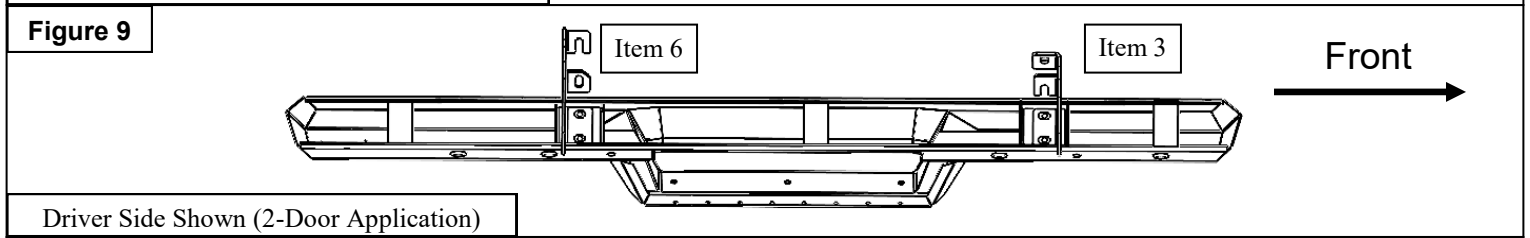

Figure 9

Driver Side Shown (2-Door Application)

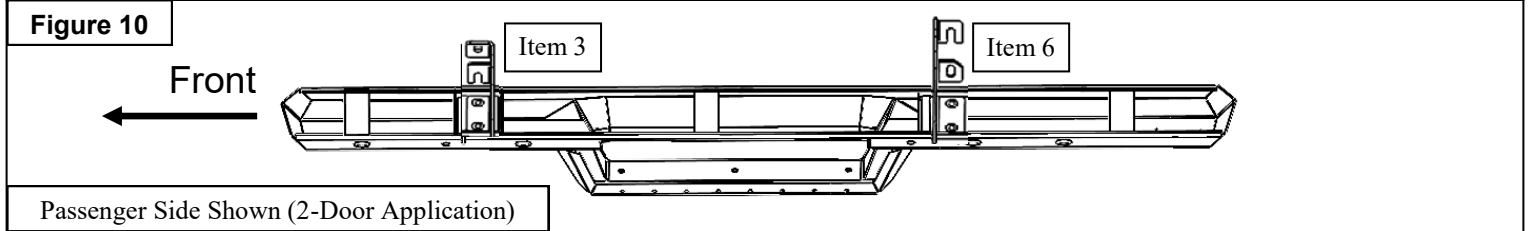
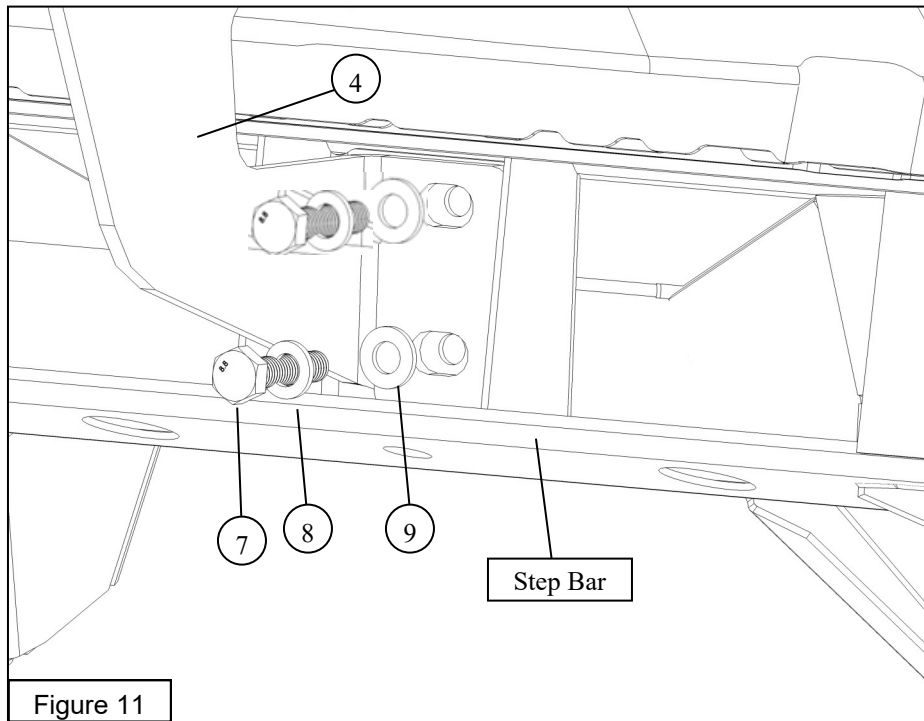

Figure 10

Passenger Side Shown (2-Door Application)

10. Mount the Step Bars (Items 1 & 2) on the mounting brackets accordingly using supplied M8 Hardware. See Figure 11 for reference. **Note: All brackets mount to the drop step in the same way, except as outlined in Figure 6.**

11. Align and adjust the step bar and brackets to desired positioning. Torque and tighten all: M8 hardware to 18 ft-lbs, M10 hardware to 38 ft-lbs.



INSTALLATION COMPLETE



CARE INSTRUCTIONS

- REGULAR WAXING IS RECOMMENDED. DO NOT USE ANY TYPE OF POLISH OR WAX THAT MAY CONTAIN ABRASIVES.
- STAINLESS STEEL PRODUCTS CAN BE CLEANED WITH MILD SOAP AND WATER. STAINLESS STEEL POLISH SHOULD BE USED TO POLISH SMALL SCRATCHES.
- GLOSS BLACK FINISHES SHOULD BE CLEANED WITH MILD SOAP AND WATER.

WESTIN Westin Automotive Products, Inc.
320 W. Covina Blvd
San Dimas, Ca. 91773

Thank you for choosing Westin products
for additional installation assistance please call
Customer Service (800) 793-7846
www.westinautomotive.com



WARNING



Failure to follow these instructions could lead to death, personal injury, and / or property damage.

Failure to follow these instructions could lead to death, personal injury, and / or property damage.

FASTENERS:

All Westin supplied fasteners must be utilized and installed in accordance with the installation instructions and apply torque to the specifications as defined. **DOUBLE CHECK ALL FASTENERS BEFORE INITIAL USE, AND PERIODICALLY IN THE FUTURE TO ENSURE PROPER FUNCTION AND SAFETY.**

DRILLING:

Most Westin products do not require drilling for installation. If drilling is defined as required, use caution when drilling a vehicle. **FAILURE TO REVIEW AN AREA TO BE DRILLED MAY RESULT IN PERSONAL INJURY AND/OR INJURY TO OTHERS AS WELL AS VEHICLE DAMAGE.**

EYE PROTECTION:

ALWAYS WEAR SAFETY GLASSES OR GOGGLES DURING THE INSTALLATION PROCESS TO AVOID PERSONAL INJURY.

MAXIMUM TOWING/CARRYING CAPACITY: (if applicable)

The Westin Receiver Hitches will have a visible tow rating label affixed directly on the product. User should never exceed the vehicle manufacturers maximum tow and weight rating regardless of the capacity of the hitch. **FAILURE TO FOLLOW THESE GUIDELINES WILL VOID THE WESTIN WARRANTY AND MAY RESULT IN PERSONAL INJURY AND/OR INJURY TO OTHERS AS WELL AS VEHICLE DAMAGE.**

FOR CALIFORNIA RESIDENTS ONLY-PROP 65 WARNING:

Some products may contain chemicals such as DEHP, which can cause cancer, birth defects or other reproductive harm. For more info go to www.p65warnings.ca.gov



Westin Automotive Products, Inc.
320 W. Covina Blvd
San Dimas, Ca. 91773