

1-800-345-4545 VOICE
1-614-299-4444 FAX



JEGS National Headquarters • 101 Jeg's Place • Delaware, OH 43015



Estimated build time is 5-7 days

Custom Driveshaft Order Form

All Orders Must Be Prepaid

1. Shipping Address <small>*We cannot deliver to PO box!</small>	2. Credit Card Billing Address	3. Billing Information
Home Phone _____	Name on card _____	<input type="checkbox"/> Credit Card # _____
Name _____	Address _____	Expiration Date _____
Address* _____	City _____ State _____ Zip _____	<input type="checkbox"/> Certified Check/Money Order
City _____ State _____ Zip _____	Work Phone _____	

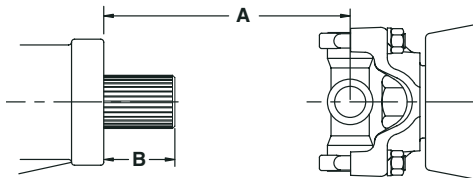
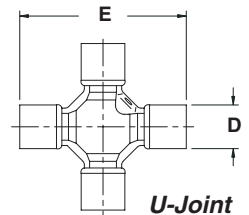

Figure #1



Figure #2



U-Joint

Figure #1 - Ordering driveshaft with a transmission yoke to be supplied by Strange Engineering.

A= _____ B= _____ To fit your rear-end yoke: D= _____ E= _____
 Transmission type: _____ Output shaft spline: _____
 Extension housing type: Bronze bushing Roller bearing

Figure #2 - Ordering driveshaft only, no transmission yoke.

To fit your transmission yoke: D= _____ E= _____ C= _____
 To fit your rear-end yoke: D= _____ E= _____

Parts required:

- Seamless chrome-moly driveshaft with Spicer ends, welded, balanced, with u-joints.*
- Seamless chrome-moly driveshaft with chrome moly ends, welded, balanced, with u-joints.*
- With heavy-duty Spicer 1350 series transmission yoke.
- With severe duty Strange chrome moly 1350 series transmission yoke.
- With u-bolt kit for Strange 1350 series rear-end yoke.

* All Strange driveshafts have 1350 series weld ends installed unless otherwise specified.

D=1.1875, E=2.625. D.O.M. (seamed) chrome-moly shafts have Spicer weld ends, seamless chrome-moly shafts have forged Strange chrome-moly weld ends. If all mating pieces are 1350 series, Spicer heavy-duty (non-cross drilled) u-joints are used. An optional "high impact" 1350 Spicer u-joint is also available for Pro Mod. applications. If a conversion u-joint must be used to adapt to your transmission and/or rear-end yoke, it will be "cross-drilled" style u-joint.

Conversion u-joints available:

U-1645- D=1.125, E=3.625 (Uses inside c-clips, measured from outside of c-clips = 2.645)
U1646- D=1.0625, E=3.217 **U1647-** D=1.0625, E=3.625