

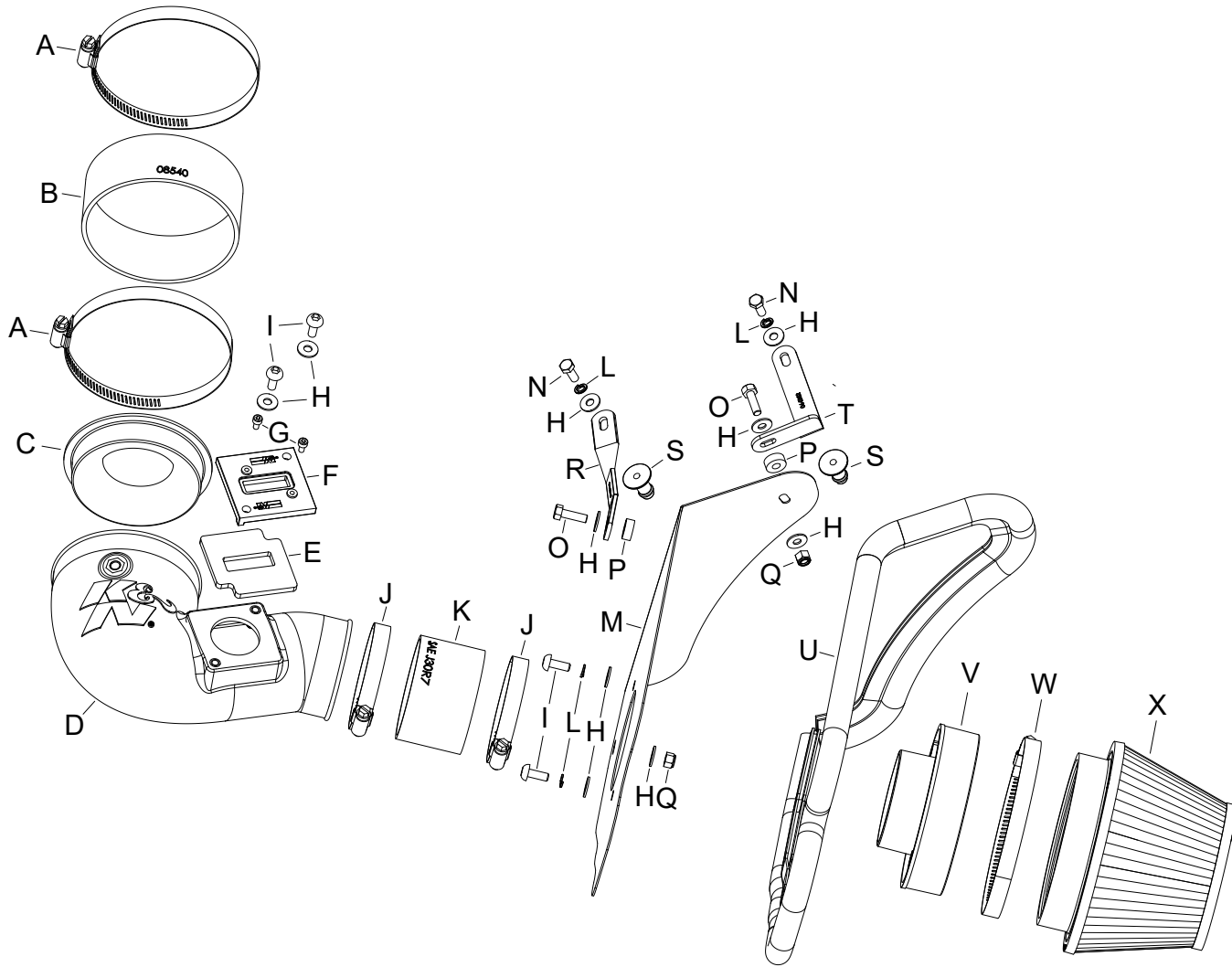

INTAKE SYSTEMS FOR VEHICLES LISTED ARE 50 STATE LEGAL. SEE KNFILTERS.COM FOR CARB STATUS ON EACH PART FOR A SPECIFIC VEHICLE.

**57-3100
CADILLAC
2016-17 ATS
L4-2.0L Turbo**



PARTS LIST:

Description	Qty.	Part #	Description	Qty.	Part #	Description	Qty.	Part #
A HOSE CLAMP #72	2	08671	I BOLT; M6 X 1 X 16MM	4	07730	Q NUT; 6MM NYLOCK	2	07512
B HOSE; 4.5" ID X 1.75" L	1	08540	J HOSE CLAMP #48	2	08601	R BRACKET; TWIST	1	064349
C VENTURI; TUBE INSERT	1	088026	K HOSE; 3" ID X 2" L REIN.	1	08711	S MOUNT, PLASTIC AIRBOX	2	8-186-1
D INTAKE TUBE (MB)	1	087354A	L WASHER, M6 SPLIT LOCK ZINC	4	1-3025	T BRACKET; "L"	1	064352
E GASKET; 3/16 PORON	1	09069	M HEAT SHIELD	1	073250	U EDGE TRIM (44")	1	102486A
F ADAPTOR; NYLON 6/6	1	21515-1	N BOLT; M6-1 X 16MM	2	07812	V ADAPTER; FILTER, 3.0"OD	1	21569
G BOLT; M4 - .7 X 8MM	2	07733	O BOLT; M6 X 1 X 20MM	2	07795	W HOSE CLAMP; #80	1	08694
H WASHER; 6MM FLAT	10	08269	P SPACER: .625" OD X .250"ID	2	06555	X AIR FILTER	1	RU-5163XD