

Engine Stand Assembly Instructions

555-80041

1250 lb. Capacity



JEGS.com

1-800-345-4545

Parts List

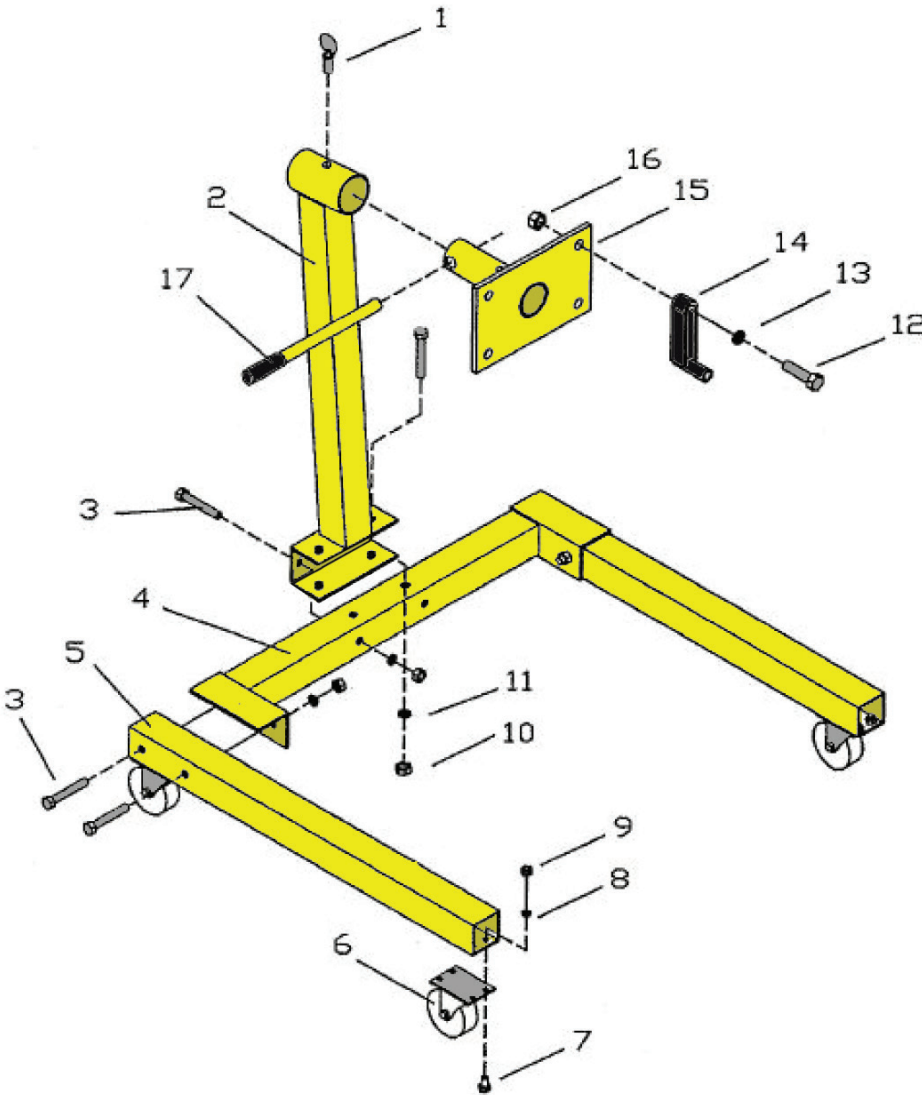

PART#	DESCRIPTION	QTY
1	Pin	1
2	Vertical Column	1
3	Bolt (M12x80)	8
4	Rear Cross Beam	1
5	Legs	2
6	Caster (3 1/2 in.)	4
7	Bolt (M8x16)	16
8	Spring Washer (M8)	16
9	Nut (M8)	16
10	Nut (M12)	6
11	Spring Washer (M12)	6
12	Bolt (M14x60)	4
13	Washer (M14)	4
14	Shifting Stand	4
15	Turning Plate	1
16	Nut (M14)	4
17	Handle	1

Assembly

1. Attach casters (6) to the legs (5) using bolts (7), washers (8), and nuts (9).
2. Attach legs (5) to the rear cross beam (4) using bolts (3), washers (11), and nuts (10).
3. Attach the vertical column (2) to the rear cross beam (4) using bolts (3), washers (11), and nuts (10).
4. Slide the turning plate (15) through the tube at the top of the vertical column (2). Rotate the plate until one of the holes aligns with the hole in the vertical column and insert the pin (1).
5. Insert the handle (17) through the hole on the turning plate (15) that protrudes beyond the vertical column (2).
6. Attach the shifting stands (14) to the turning plate (15) using bolts (12), washers (13), and nuts (16).

Warning

ENSURE THAT ALL BOLTS ARE SECURELY TIGHTENED BEFORE OPERATING.

Operation

1. Do not exceed the engine stand's maximum capacity of 1250 lb.
2. Use only on hard level surfaces.
3. Never attempt to move a loaded engine stand across floors that have cracks or other obstacles which may impede movement of the wheels.
4. Never work directly under a supported engine.
5. Be sure that the load and stand are stable.
6. Periodically inspect the stand to ensure its safe operation. Re-tighten hardware as needed.
7. Failure to follow any of these instructions may result in property damage or personal injury.